

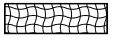





**EROSION CONTROL LEGEND**

-  CLASS 2 MODIFIED AND CLASS 7 SEEDING AND MULCH METHOD 2
-  CLASS 2 MODIFIED AND CLASS 7 SEEDING AND EROSION CONTROL BLANKET
-  RIPRAP
-  PERMINTER EROSION BARRIER
-  TEMPORARY DITCH CHECK
-  INLET & PIPE PROTECTION
-  FLOW DIRECTION

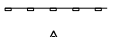

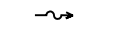
12/12/2013  
 K:\pwworking\coleman\02717471\98729-sh1-er.dgn  
 REF: 19063  
 REF: m323

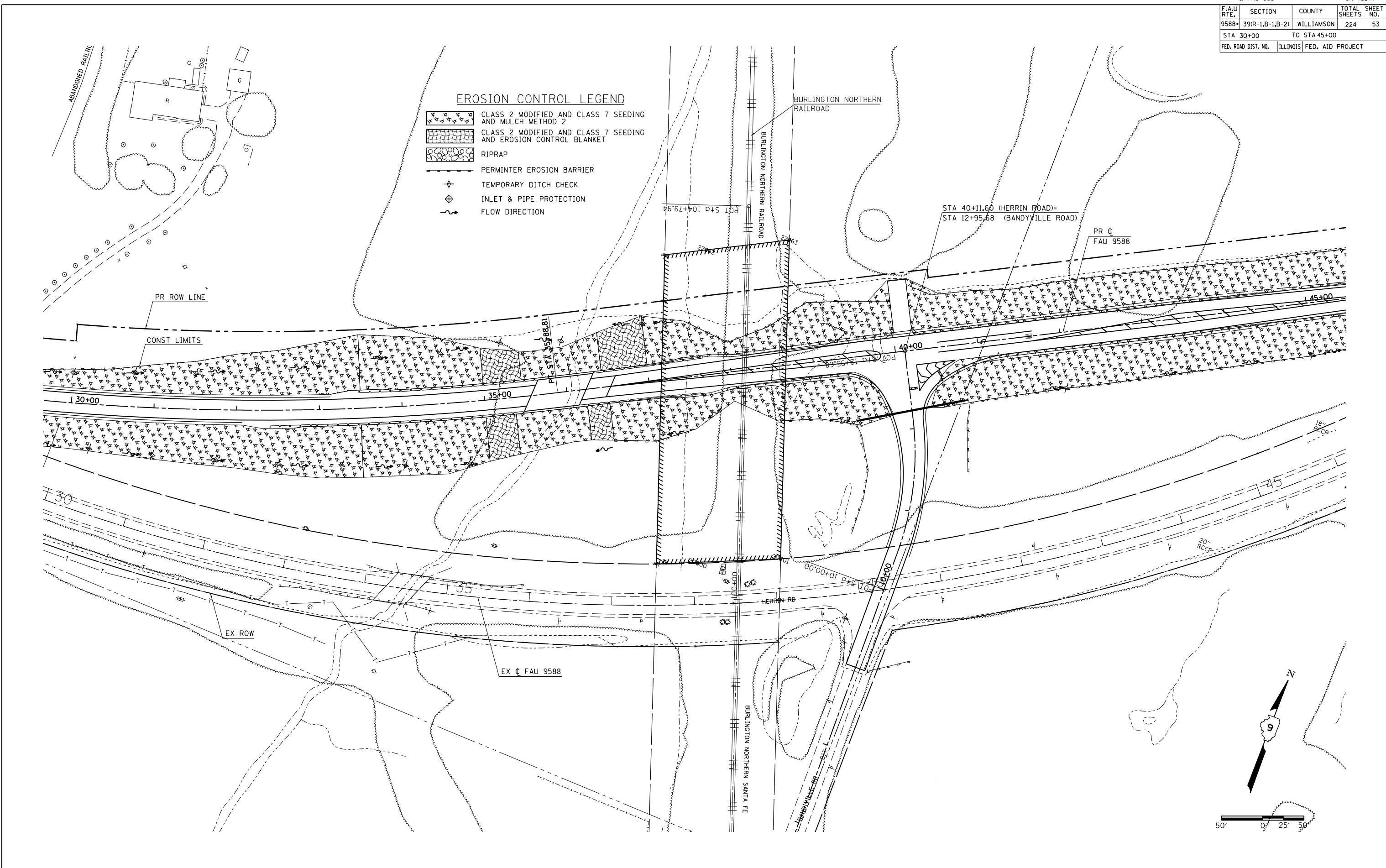
EROSION CONTROL PLAN STA 30+00 TO STA 45+00