

CONCRETE REMOVAL

(Looking South)

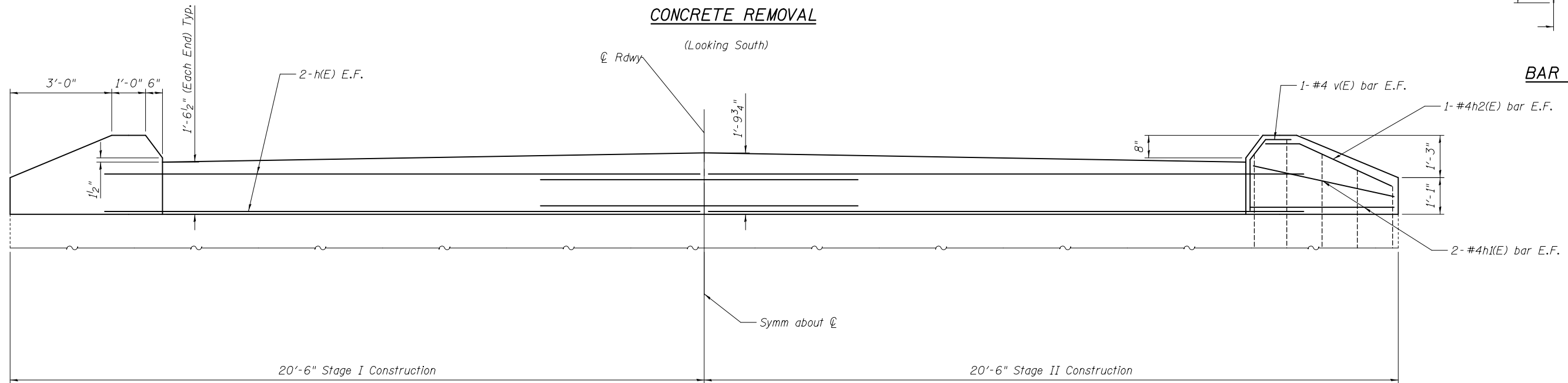

CONCRETE REPLACEMENT

(Looking South)

Note:
E.F. = Each Face

DESIGNED - AYV	EXAMINED _____	DATE - _____
CHECKED - _____	ENGINEER OF STRUCTURAL SERVICES	
DRAWN - AYV	PASSED _____	REVISED _____
CHECKED - _____	ENGINEER OF BRIDGES AND STRUCTURES	REVISED _____

STATE OF ILLINOIS
DEPARTMENT OF TRANSPORTATION

ELEVATION N. & S. ABUTMENT HATCHBLOCKS & WINGWALLS
SN 042-0012

SHEET NO. 6 OF 12 SHEETS

F.A.P. RTE.	SECTION	COUNTY	TOTAL SHEETS	SHEET NO.
304	4-BY, 4B-1	JERSEY	26	20
CONTRACT NO. 76G49				
ILLINOIS FED. AID PROJECT				