

Hatching Indicates Concrete Removal.

- Existing Reinforcement
- Proposed Reinforcement

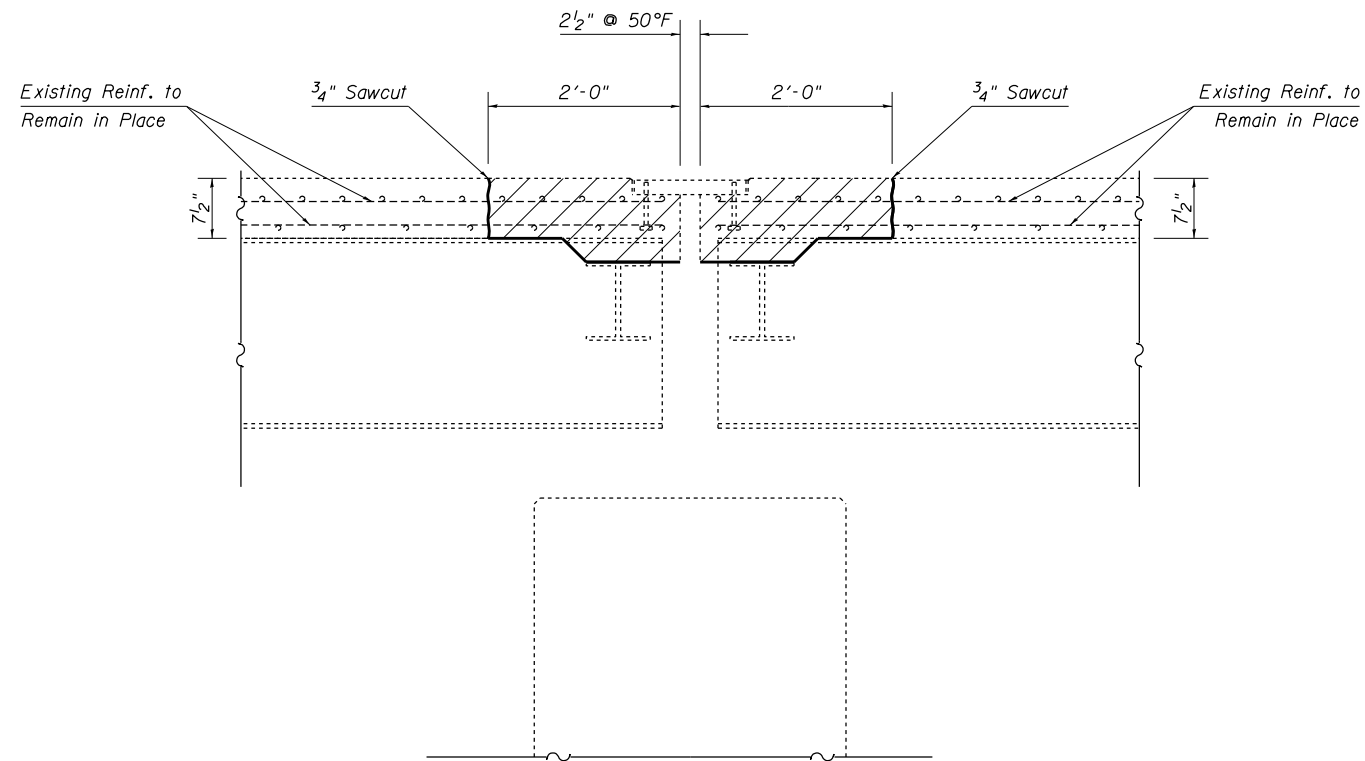

SECTION C-C
 (Dimensions at Rt. L's to end of deck)
 (PIERS 3, 7, 11, & 15)

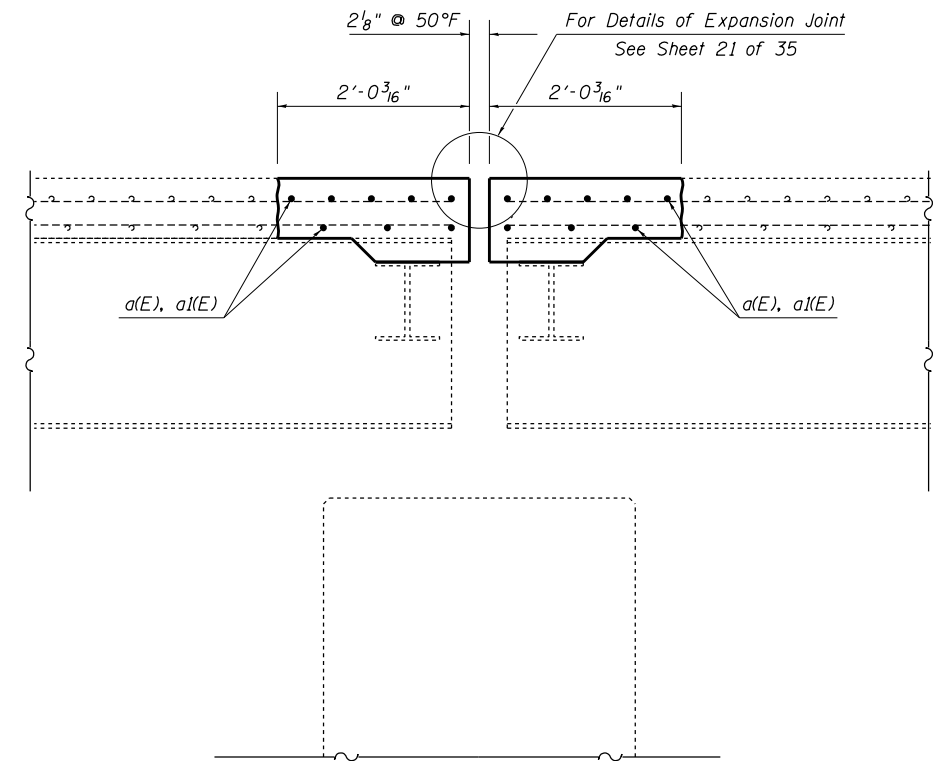

SECTION D-D
 (Dimensions at Rt. L's to end of deck)
 (PIERS 3, 7, 11, & 15)

FILE NAME =	USER NAME = steffenmk	DESIGNED - MJM	REVISED -
c:\pw\work\p\dot\stefjenmk\d0340638\074618-sh-t-brdeta1s-0960010.dgn		DRAWN - MJM	REVISED -
Default	PLOT SCALE = 40.0000' / in.	CHECKED - MEA	REVISED -
	PLOT DATE = 12/6/2013	DATE - 08/13/2013	REVISED -

**STATE OF ILLINOIS
 DEPARTMENT OF TRANSPORTATION**

**EXPANSION JOINT REPLACEMENT DETAILS - PIERS 3, 7, 11 AND 15
 SN. 096-0010**

SCALE: N/A SHEET 9 OF 35 SHEETS STA. TO STA.

F.A.P. RTE.	SECTION	COUNTY	TOTAL SHEETS	SHEET NO.
823	07 BRIDGE REPAIRS 2014-3	WAYNE	60	30
ILLINOIS FED. AID PROJECT			CONTRACT NO. 74618	