

STAGE I TRAFFIC CONTROL BRIDGE REPAIR

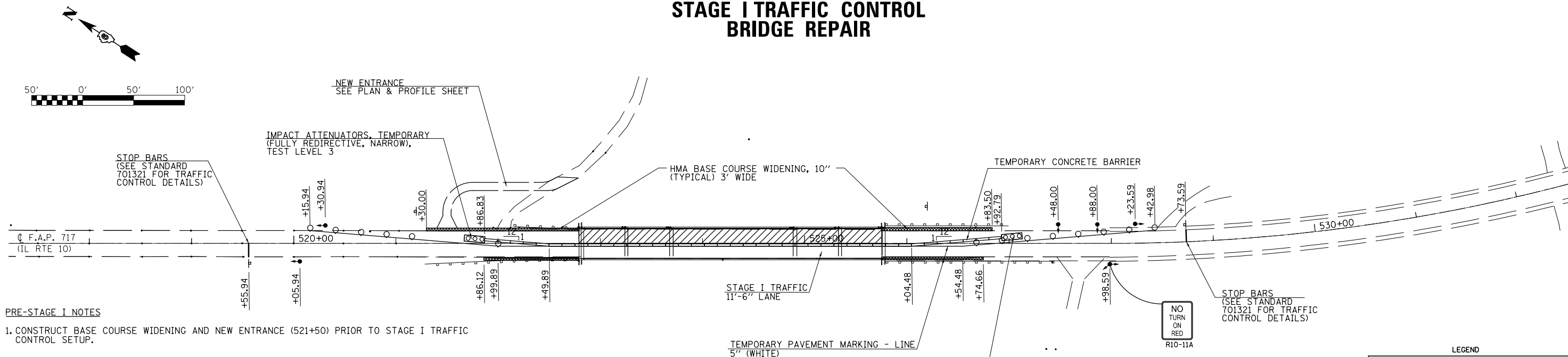

PRE-STAGE I NOTES

1. CONSTRUCT BASE COURSE WIDENING AND NEW ENTRANCE (521+50) PRIOR TO STAGE I TRAFFIC CONTROL SETUP.

STAGE I NOTES

1. ERECT SIGNS, TRAFFIC SIGNALS, TEMPORARY BARRIERS, ETC. UTILIZING THE APPLICABLE DETAILS OF TRAFFIC CONTROL STANDARD 701321 WITH BARRIER SPACING AS NOTED ON THE STANDARD.
2. PLACE TEMPORARY PAVEMENT MARKING LINE TO ALLOW FOR A 12'-0" TRAFFIC LANE. REMOVE ANY CONFLICTING STRIPING.
3. REPAIR & OVERLAY THE STAGE I PORTION OF THE EXISTING STRUCTURE AT LOCATIONS AS NOTED ON THE PLANS.
4. CONSTRUCT THE STAGE I PORTION OF HOT-MIX ASPHALT WIDENING FOR STAGE II TRAFFIC.
5. MOVE TRAFFIC FOR STAGE II.

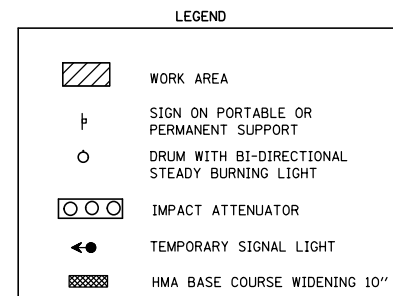

STAGE II TRAFFIC CONTROL BRIDGE REPAIR

STAGE II NOTES

1. RELOCATE SIGNS, TEMPORARY BARRIERS, ETC. IN ACCORDANCE WITH TRAFFIC CONTROL STANDARDS 701321 AND AS SHOWN ON THE STANDARD.
2. PLACE TEMPORARY PAVEMENT MARKING LINE TO ALLOW FOR A 12'-0" TRAFFIC LANE. REMOVE ANY CONFLICTING STRIPING.
3. REPAIR & OVERLAY THE STAGE II PORTION OF THE EXISTING STRUCTURE AT LOCATIONS AS NOTED ON THE PLANS.
4. REMOVE TEMPORARY BARRIERS, SIGNALS, WORK ZONE PAVEMENT MARKING AND SIGNS ASSOCIATED WITH TRAFFIC CONTROL STANDARDS 701321.
5. RESURFACE ROADWAY UTILIZING TRAFFIC CONTROL STANDARD 701306.
6. PLACE SEEDING.

GENERAL NOTES FOR STAGE CONSTRUCTION:

1. ALL SIGNAGE, SPACING, TRAFFIC CONTROL EQUIPMENT AND TEMPORARY PAVEMENT MARKINGS SHALL BE IN ACCORDANCE WITH THE LATEST VERSION OF HIGHWAY STANDARD 701321 AND SHALL BE INCLUDED IN THE CONTRACT UNIT PRICE EACH FOR TRAFFIC CONTROL AND PROTECTION STANDARD 701321.
2. ALL TEMPORARY BRIDGE TRAFFIC SIGNALS FOR CONSTRUCTION WILL BE MEASURED AS 1 (ONE) UNIT.
3. BARRIER OFFSETS ARE FROM THE CENTER OF THE BARRIER.
4. SEE BRIDGE REPAIR PLANS FOR ADDITIONAL DETAILS.
5. STOP BARS TO BE LOCATED PER STD. 701321.

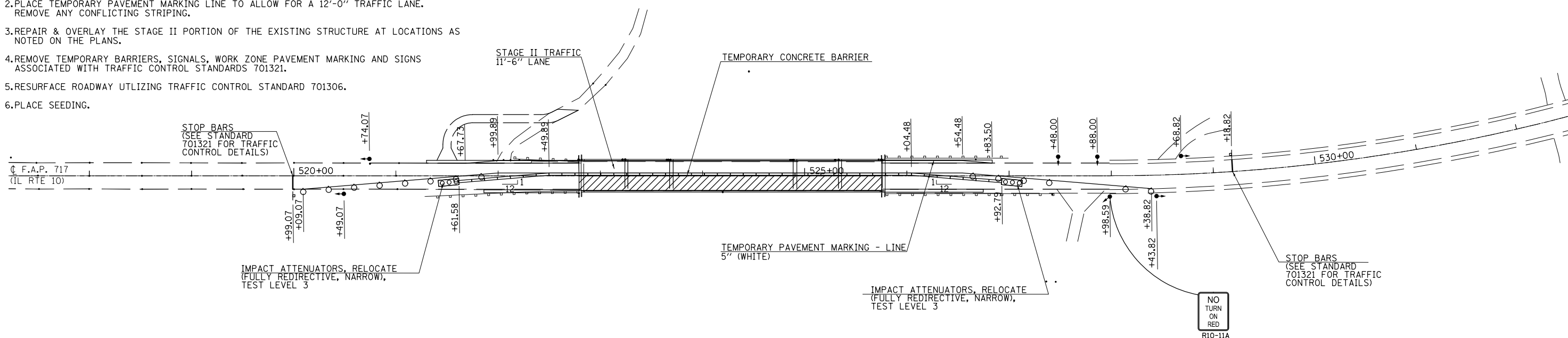

FILE NAME =	USER NAME = *USER*	DESIGNED -	REVISED -	STATE OF ILLINOIS DEPARTMENT OF TRANSPORTATION	STAGE CONSTRUCTION - FAP 717 (IL RTE 10) - 054-0009 BRIDGE			F.A.P. RTE.	SECTION	COUNTY	TOTAL SHEETS	SHEET NO.
*FILE#		DRAWN -	REVISED -		717	(102B-1,102CR,102BR-2)RS-5	LOGAN	218	37			
PLOT SCALE = *SCALE*		CHECKED -	REVISED -		CONTRACT NO. 72B82							
PLOT DATE = *DATE*		DATE -	REVISED -		ILLINOIS FED. AID PROJECT							
					SCALE:	SHEET NO. 5 OF 5 SHEETS	STA.	TO STA.				