

STAGE I TRAFFIC CONTROL CULVERT REPLACEMENT

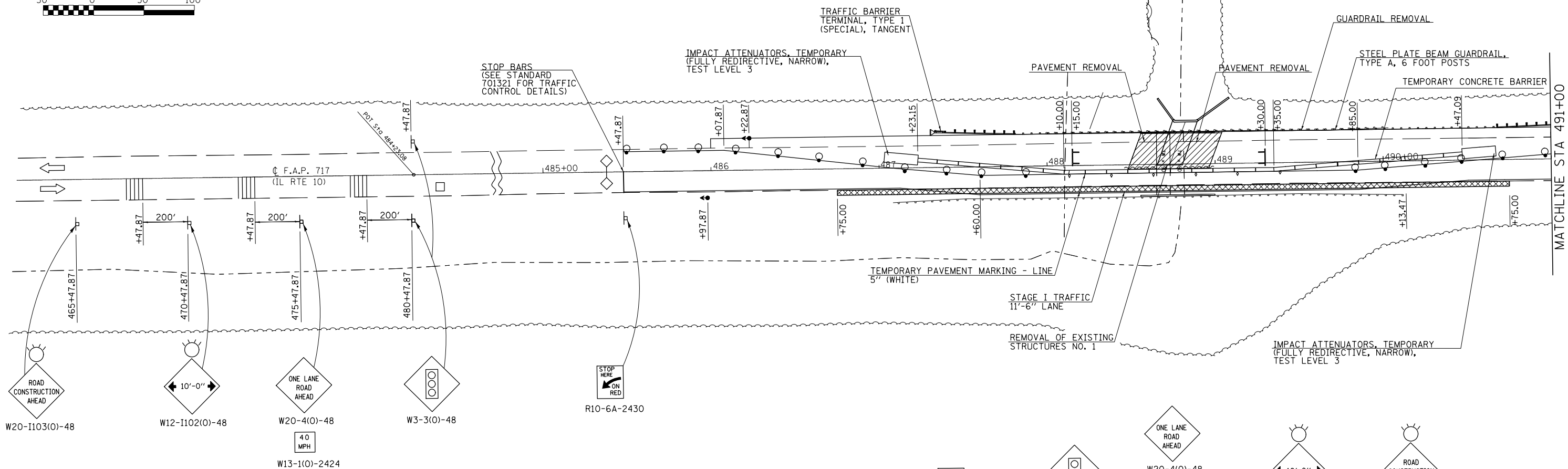
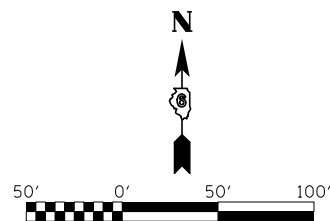

STAGE I NOTES

1. CONSTRUCT HMA WIDENING UTILIZING STANDARD 701201.
2. ERECT SIGNS, TRAFFIC SIGNALS, TEMPORARY BARRIERS, ETC. UTILIZING THE APPLICABLE DETAILS OF TRAFFIC CONTROL STANDARD 701321 WITH BARRIER SPACING AS NOTED ON THE STANDARD.
3. PLACE TEMPORARY PAVEMENT MARKING LINE TO ALLOW FOR A 10'-6" TRAFFIC LANE. REMOVE ANY CONFLICTING STRIPING.
4. REMOVE THE STAGE I PORTION OF THE EXISTING STRUCTURE, PAVEMENT AND GUARDRAIL, AT LOCATIONS AS NOTED ON THE PLANS.
5. CONSTRUCT THE STAGE I PORTION OF SN 054-7069 AT STA. 488+73.19.
6. CONSTRUCT THE STAGE I PORTION OF HOT-MIX ASPHALT SHOULDERS FOR STAGE II TRAFFIC.
7. INSTALL GUARDRAIL.
8. MOVE TRAFFIC FOR STAGE II.

GENERAL NOTES FOR STAGE CONSTRUCTION:

1. ALL SIGNAGE, SPACING, TRAFFIC CONTROL EQUIPMENT AND TEMPORARY PAVEMENT MARKINGS SHALL BE IN ACCORDANCE WITH THE LATEST VERSION OF HIGHWAY STANDARD 701321 AND SHALL BE INCLUDED IN THE CONTRACT UNIT PRICE EACH FOR TRAFFIC CONTROL AND PROTECTION STANDARD 701321.
2. ALL TEMPORARY BRIDGE TRAFFIC SIGNALS FOR CONSTRUCTION WILL BE MEASURED AS 1 (ONE) UNIT.
3. BARRIER OFFSETS ARE FROM THE CENTER OF THE BARRIER.
4. SEE CULVERT PLANS FOR ADDITIONAL DETAILS.
5. STOP BARS TO BE LOCATED PER STD. 701321.

LEGEND

	WORK AREA		TEMPORARY CONCRETE BARRIER
	SIGN ON PORTABLE OR PERMANENT SUPPORT		DOUBLE VERTICAL PANEL (SEE DETAIL)
	DRUM WITH BI-DIRECTIONAL STEADY BURNING LIGHT		TEMPORARY SIGNAL LIGHT
	TYPE III BARRICADE W/ FLASHING LIGHT		IMPACT ATTENUATOR
	TEMPORARY PAVEMENT MARKING		
	HMA BASE COURSE WIDENING, 10"		

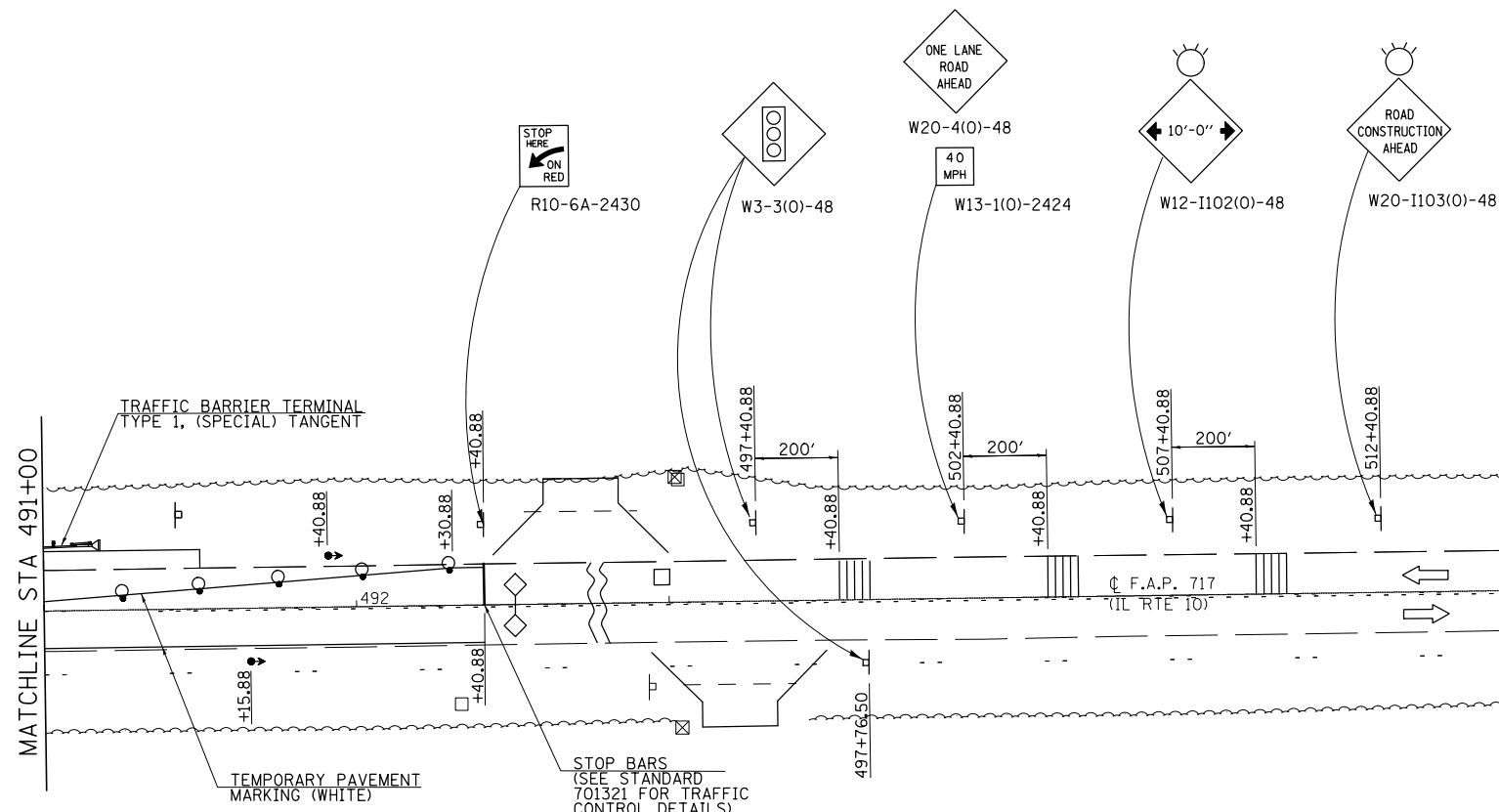

FILE NAME =	USER NAME = #USER#	DESIGNED -	REVISED -
#FILE#		DRAWN -	REVISED -
		CHECKED -	REVISED -
		DATE -	REVISED -

STATE OF ILLINOIS
DEPARTMENT OF TRANSPORTATION

STAGE I CONSTRUCTION - FAP 717 (IL RTE 10) - CULVERT

SCALE: SHEET NO. 1 OF 5 SHEETS STA. TO STA.

F.A.P. RTE.	SECTION	COUNTY	TOTAL SHEETS	SHEET NO.
717	(102B-1,102CR,102BR-2)RS-5	LOGAN	218	33
CONTRACT NO. 72B82				
ILLINOIS FED. AID PROJECT				