

LOCATION MAP #1

DEWITT CO.
F.A.I. 74

CURRENT ADT

FUNCTIONAL CLASSIFICATION: INTERSTATE
FAI 74 (I-74)

LEG "A" ADT(2013) = 18,300 SU=7.5% MU=35.3%
LEG "B" ADT(2013) = 20,600 SU=4.1% MU=36.1%

BEGIN SECTION
STA. 635+97.34
MCLEAN CO. LINE

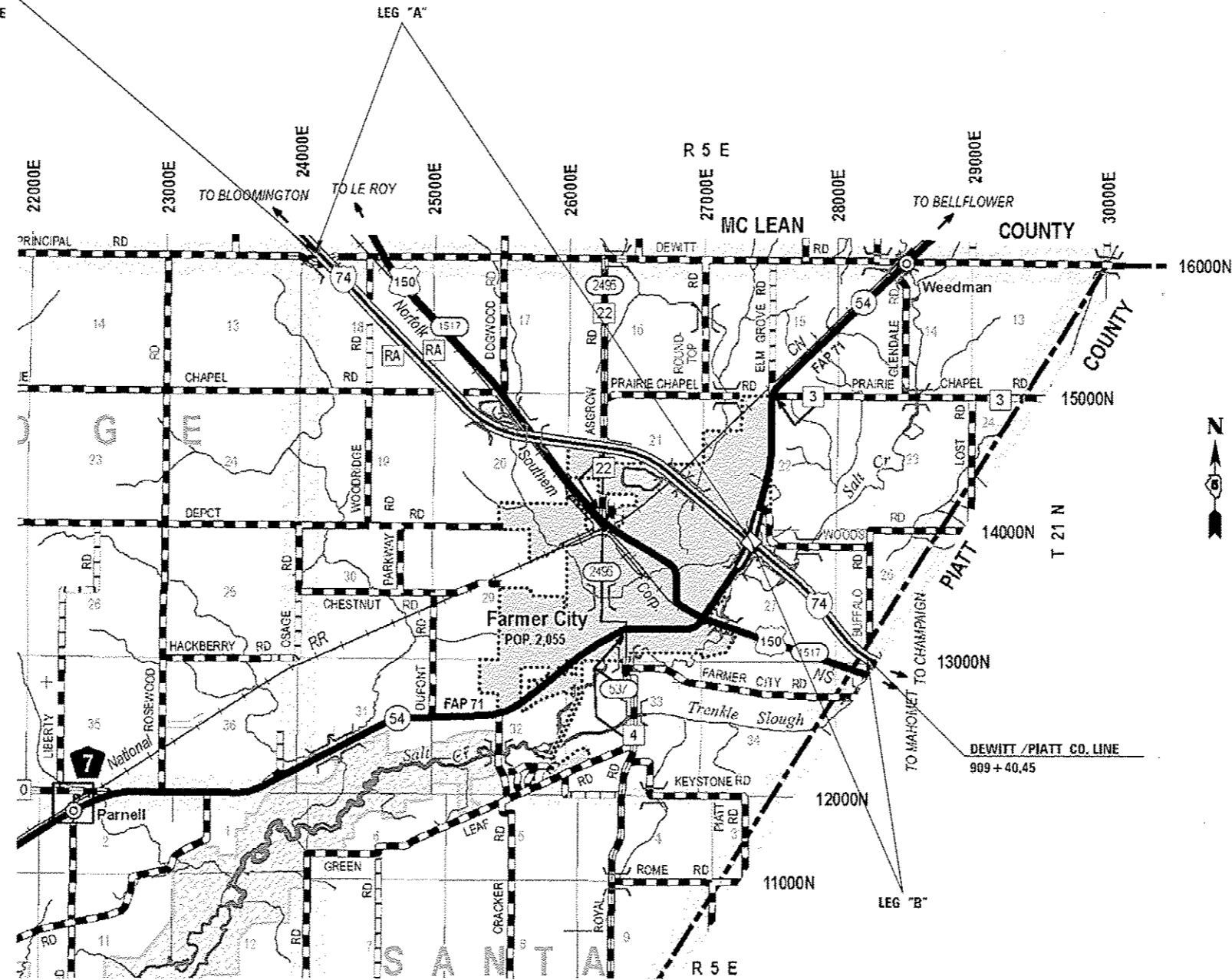

RURAL
STA. 635 + 97.34 TO STA. 909 + 40.45

SCALE

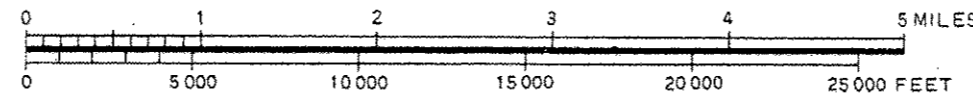

GROSS LENGTH = 27,343.11 FT. = 5.179 MILE
NET LENGTH = 27,343.11 FT. = 5.179 MILE

TOWNSHIPS
FARMER CITY

FILE NAME	USER NAME = leroyne	DESIGNED -	REVISED -	STATE OF ILLINOIS DEPARTMENT OF TRANSPORTATION	LOCATION MAP #1	F.A.I. RTE.	SECTION	COUNTY	TOTAL SHEETS	SHEET NO.	
os:\p\work\p\side\leroyne\20305293\0570230-shr-cover.dgn		DRAWN -	REVISED -			74&57	DS PATCHING 2014-4	VARIOUS	29	3	
PLOT SCALE = 40,000 1/1 in.		CHECKED -	REVISED -			CONTRACT NO. 70A38					
PLOT DATE = 12/4/2013		DATE -	REVISED -			ILLINOIS FED. AID PROJECT					

SCALE: SHEET 1 OF 5 SHEETS STA. TO STA.