

**PLAN PIER 6**

THE ENGINEER MAY REQUIRE ADDITIONAL TRAFFIC CONTROL DRUMS TO EXTEND THE WORKZONE BETWEEN THE WORKSITES. COST INCLUDED WITH THE ASSOCIATED TRAFFIC CONTROL AND PROTECTION.

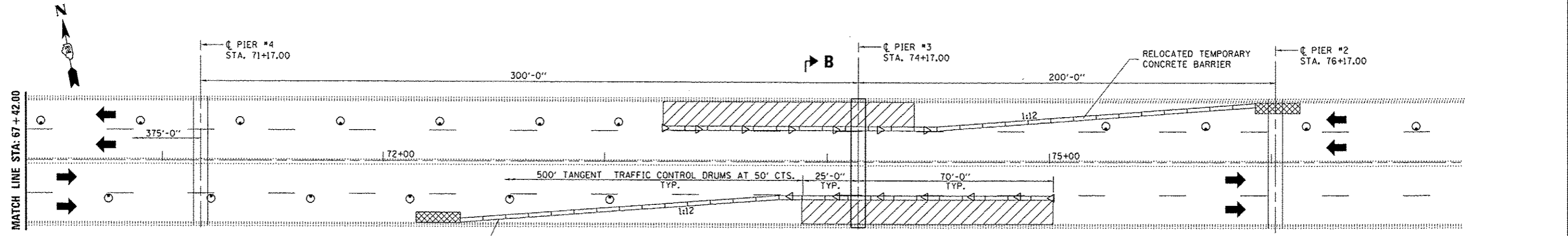

**PLAN PIER 3**

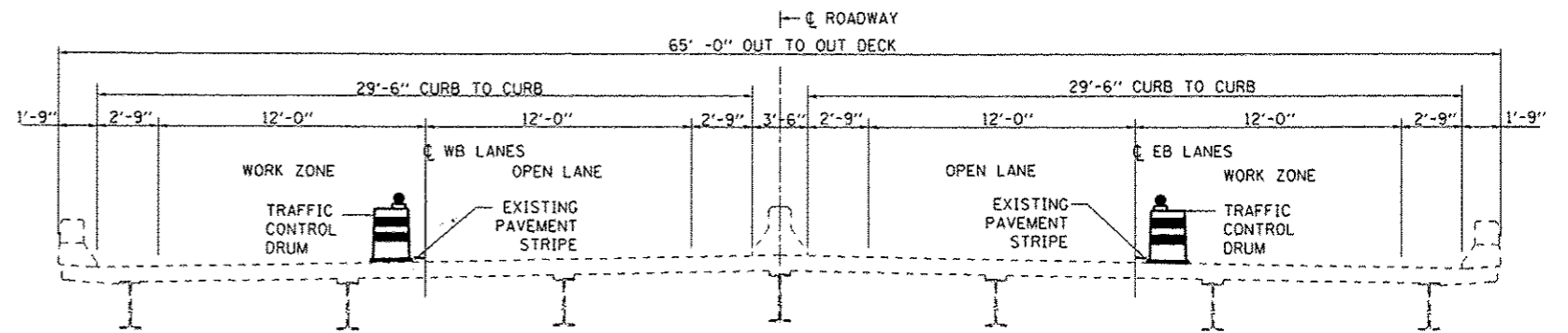

**SECTION A-A TYP.**  
SHOWN LOOKING EAST

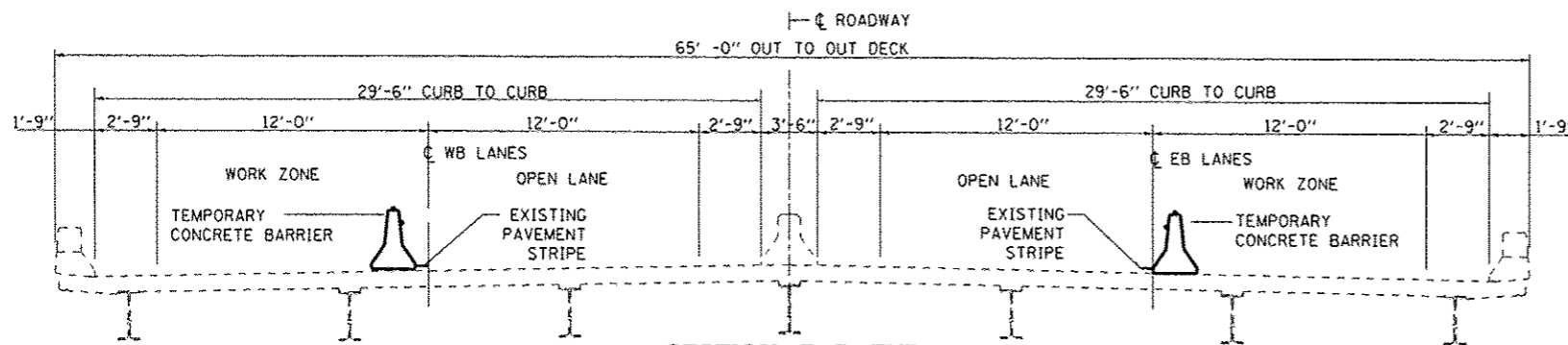

**SECTION B-B TYP.**  
SHOWN LOOKING EAST

**SYMBOLS**

- Work area
- Drum, with steady burn monodirectional light
- Temporary concrete barrier
- Relocated temporary concrete barrier
- Monodirectional barrier wall/guardrail marker
- Impact attenuator
- Relocated impact attenuator

**GENERAL NOTES**

This standard is used where at any time any vehicle, equipment, workers or their activities will encroach on the pavement or on the shoulder within 24 (600) of the edge of pavement for day light operation exceeding one day and where temporary concrete barrier is utilized. This detail must always be used in combination with Standard 701402. When work is being performed in the left lane, the set up would be a mirror image to what is shown.

FILE NAME *	USER NAME * Pately	DESIGNED - YOGESH PATEL	REVISED -	<b>STATE OF ILLINOIS DEPARTMENT OF TRANSPORTATION</b>	<b>LANE CLOSURE DETAILS FOR STRUCTURE NO. 078-0001</b>	F.A.I. RTE.	SECTION	COUNTY	TOTAL SHEETS	SHEET NO.
cd:\pw\work\p\idat\pately\140358830\036027-shc-details.dgn	DRAWN - YOGESH PATEL	REVISIONS -	180			(06-3,78-11PM-1)	BUREAU	9	5	
PLOT SCALE * 1/8" = 1'-0"	CHECKED - RON WOOSHANK	REVISIONS -	CONTRACT NO. 66027							
PLOT DATE * 12/9/2013	DATE -	REVISIONS -	ILLINOIS FED. AID PROJECT							
SCALE:		SHEET 1 OF 1 SHEETS		STA. TO STA.						