

F.A.I. RTE.	SECTION	COUNTY	TOTAL SHEETS	SHEET NO.
57	(38-6B)I-2	IROQUOIS	19	1
ILLINOIS			CONTRACT NO. 66C81	

STATE OF ILLINOIS
DEPARTMENT OF TRANSPORTATION
DIVISION OF HIGHWAYS

PROPOSED
HIGHWAY PLANS

FAI ROUTE 57 (I-57)
SECTION (38-6B)I-2

BRIDGE REPAIR
S.N. 038-0155 (SB) & S.N. 038-0156 (NB)
OVER SPRING CREEK
2.4 MILES SOUTH OF ONARGA
IROQUOIS COUNTY

C-93-051-13

INDEX OF SHEETS

1. COVER SHEET
2. GENERAL NOTES
3. SUMMARY OF QUANTITIES
4. TYPICAL SECTIONS
5. SCHEDULES
6. APPROACH TO LANE CLOSURE, FREEWAY/EXPRESSWAY
STANDARD 701400 (SPECIAL)
7. LANE CLOSURE, FREEWAY/EXPRESSWAY
STANDARD 701402 (SPECIAL)
8. STAGES OF CONSTRUCTION
9. TYPICAL PAVEMENT MARKINGS
- 10 - 19. STRUCTURE PLANS

STANDARDS

- | | |
|-----------|---|
| 000001-06 | STANDARD SYMBOLS, ABBREVIATIONS AND PATTERNS |
| 001001-02 | AREAS OF REINFORCEMENT BARS |
| 001006 | DECIMAL OF AN INCH AND OF A FOOT |
| 701101-04 | OFF-ROAD OPERATIONS MULTILANE, 15' (4.5 m) TO 24" (600 mm) FROM PAVEMENT EDGE |
| 701106-02 | OFF-ROAD OPERATIONS, MULTILANE, MORE THAN 15' (4.5 m) AWAY |
| 701426-06 | LANE CLOSURE, MULTILANE INTERMITTENT OR MOVING OPERATION, FOR SPEEDS ≥ 45 MPH |
| 701901-03 | TRAFFIC CONTROL DEVICES |
| 704001-07 | TEMPORARY CONCRETE BARRIER |

PROJECT LOCATION
STRUCTURE NO. 038-0155 (SB)
STRUCTURE NO. 038-0156 (NB)
STATION 928 + 50.00

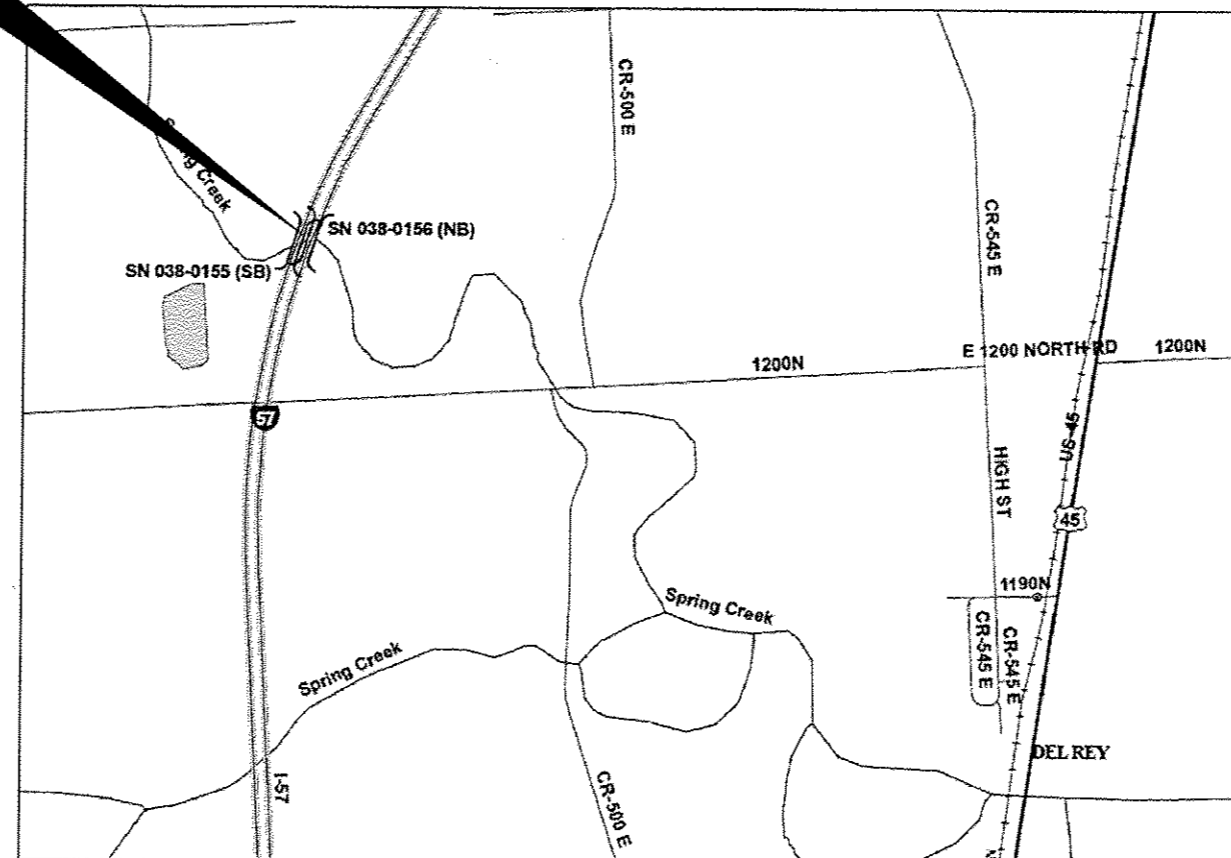

LOCATION MAP
POINT LOCATION
NOT TO SCALE

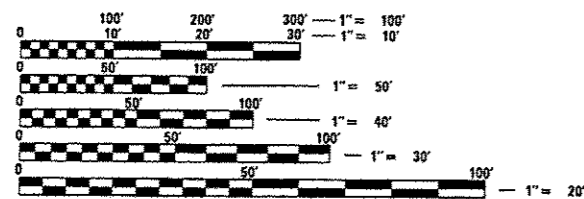

FULL SIZE PLANS HAVE BEEN PREPARED USING STANDARD ENGINEERING SCALES. REDUCED SIZED PLANS WILL NOT CONFORM TO STANDARD SCALES. IN MAKING MEASUREMENTS ON REDUCED PLANS, THE ABOVE SCALES MAY BE USED.

J.U.L.I.E.
JOINT UTILITY LOCATION INFORMATION FOR EXCAVATION
1-800-892-0123
OR 811

PROJECT ENGINEER JOE KANNEL P.E.
UNIT CHIEF RON WOODSHANK
TOWNSHIP ONARGA
CONTRACT NO. 66C81



RURAL	
INTERSTATE	
FAI 57 (I-57)	
2012	
ADT	14900
P.V.	63.76%
S.U.	2.68%
M.U.	33.56%

STATE OF ILLINOIS
DEPARTMENT OF TRANSPORTATION
DIVISION OF HIGHWAYS

SUBMITTED 12-9 2013
Paul A. Lockman
DEPUTY DIRECTOR OF HIGHWAYS, REGION ENGINEER

Jan 24 2014
John D. Baranzelli, P.E.
ENGINEER OF DESIGN AND ENVIRONMENT

Jan 24 2014
Omer Osman, P.E.
DIRECTOR OF HIGHWAYS, CHIEF ENGINEER

PRINTED BY THE AUTHORITY
OF THE STATE OF ILLINOIS