

| | |
|---------------|--|
| DATE | |
| BY | |
| SURVEYED | |
| PLOTTED | |
| TEMPLATE | |
| NOTE BOOK | |
| AREAS CHECKED | |
| NO. | |

| | |
|-----------------|--|
| DATE | |
| BY | |
| ORIGINAL SURVEY | |
| PLOTTED | |
| TEMPLATE | |
| NOTE BOOK | |
| AREAS CHECKED | |
| NO. | |

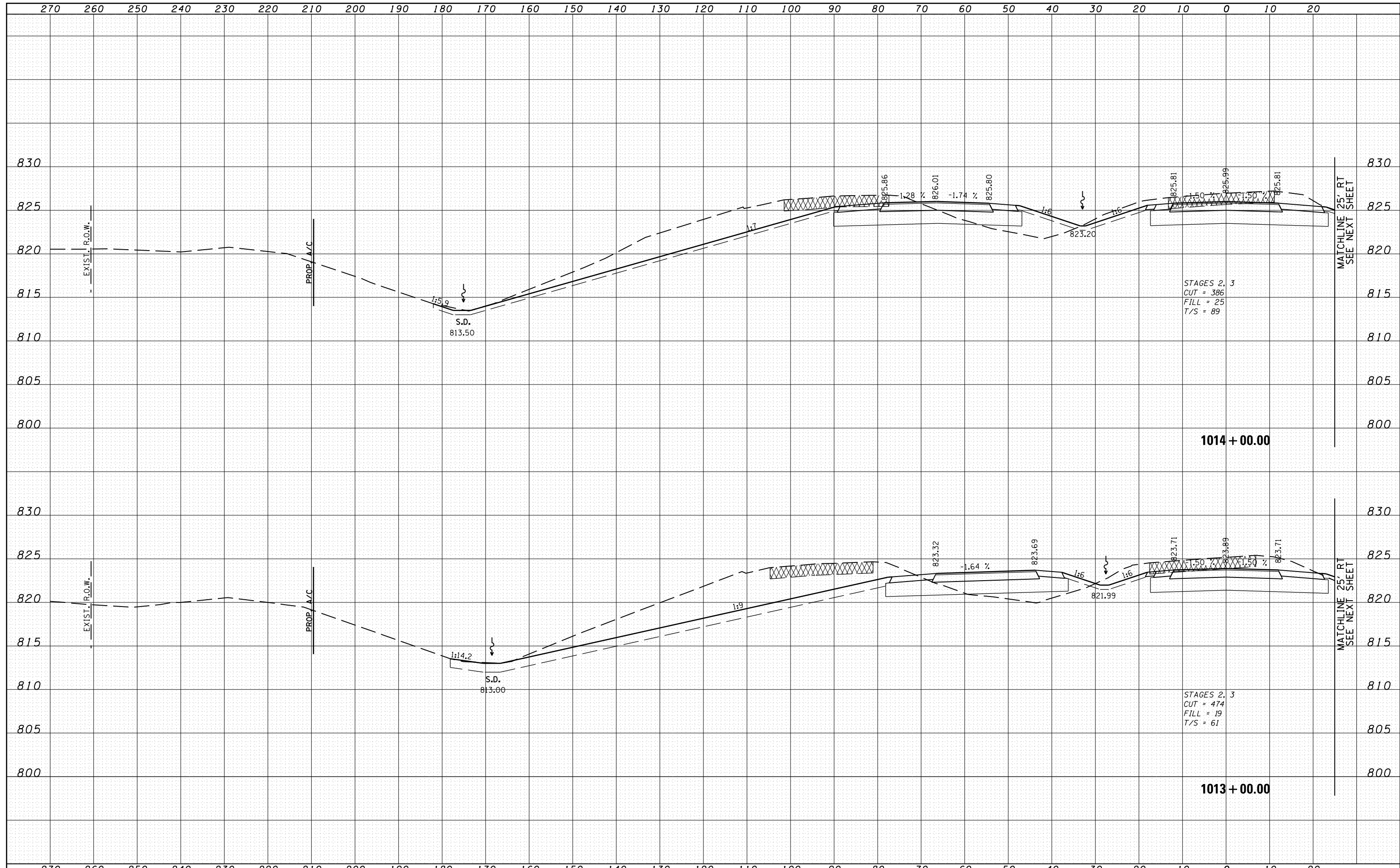

FILE NAME =
 c:\pw_work\pwidot\rundbladerr\d0331836\0264H70\shht-xssht-IL_Route_2.dgn

USER NAME =
 DESIGNED - RDT
 DRAWN - RDT
 PLOT SCALE =
 PLOT DATE

REVISIED -
 REVISIED -
 REVISIED -
 REVISIED -
 DATE - 10-05-2012

**STATE OF ILLINOIS
 DEPARTMENT OF TRANSPORTATION**

**ILLINOIS ROUTE 2
 CROSS SECTIONS**

H: 1" = 10'
 SCALE: V: 1" = 5'

SHEET NO. OF SHEETS STA. 1013+00.00 TO STA. 1014+00.00

| | | | | |
|---------------------------|---------|-----------|--------------------|-----------|
| F.A.P. RTE. | SECTION | COUNTY | TOTAL SHEETS | SHEET NO. |
| 734 | 77R-1 | WINNEBAGO | 179 | 148 |
| | | | CONTRACT NO. 64HT0 | |
| ILLINOIS FED. AID PROJECT | | | | |