

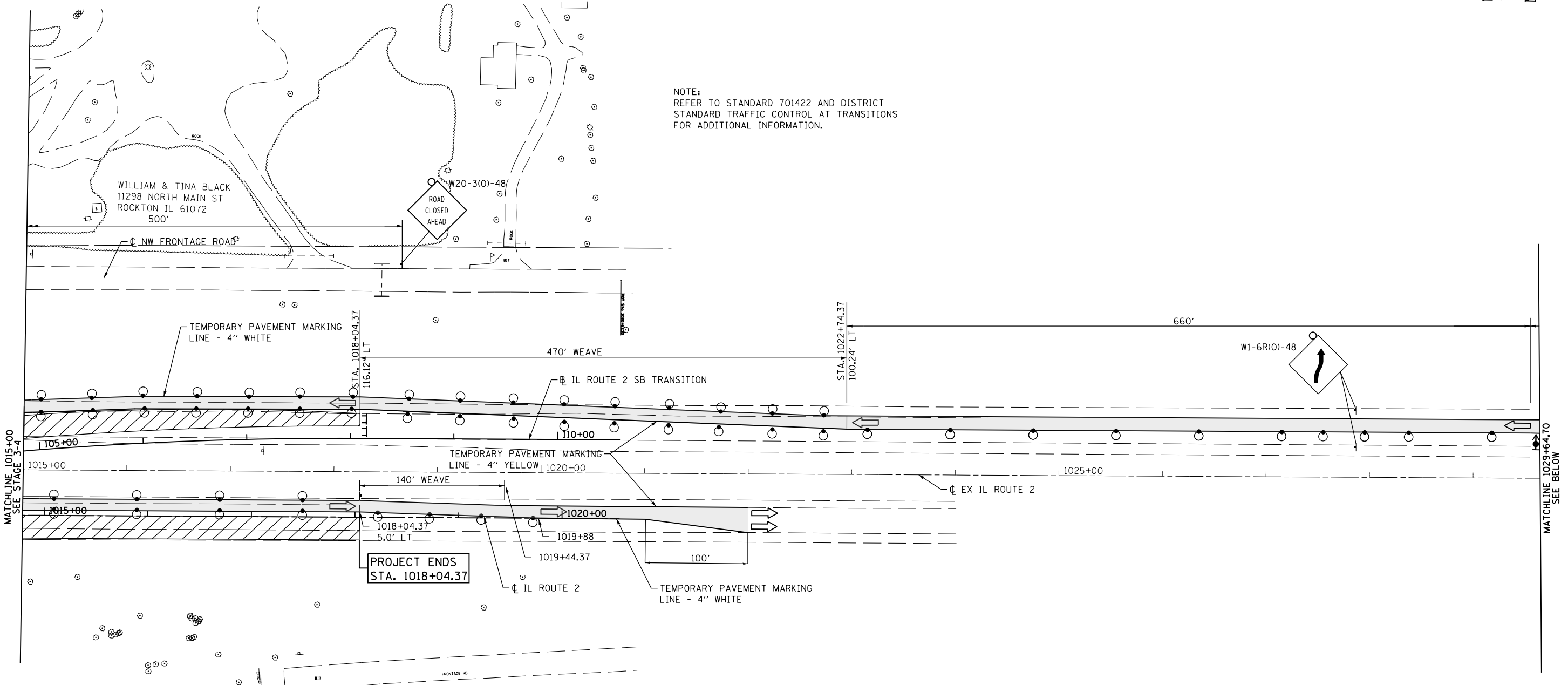

NOTE:  
REFER TO STANDARD 701422 AND DISTRICT  
STANDARD TRAFFIC CONTROL AT TRANSITIONS  
FOR ADDITIONAL INFORMATION.

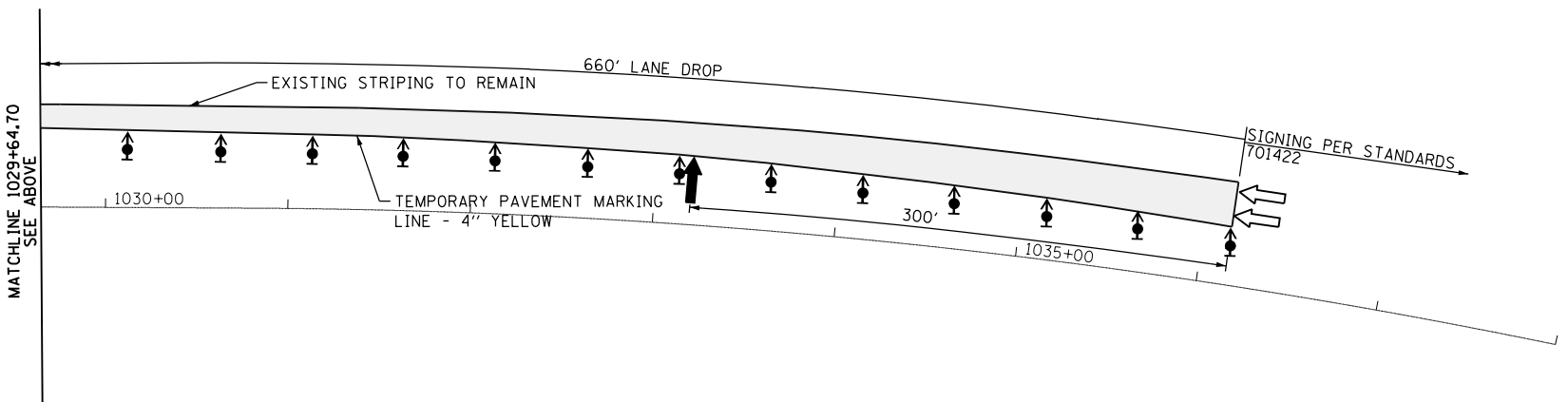

- LEGEND**
- CONSTRUCTION ZONE THIS STAGE
  - DIRECTION OF TRAVEL
  - TEMPORARY PAVEMENT (SEE TYPICAL SECTION FOR WIDENING)
  - BARRICADE, TYPE III
  - DRUM WITH STEADY BI-DIRECTIONAL BURNING LIGHT
  - ARROW BOARD
  - DIRECTION INDICATOR BARRICADE
  - VERTICAL PANEL



NOTE: NO DROP-OFF GREATER THAN 12" SHALL BE WITHIN 3' OF TRAFFIC FOR GREATER THAN 48 HOURS. IF THE DROP-OFF IS NOT CORRECTED IN THE TIME-FRAME, SAID AREA SHALL BE PROTECTED WITH BARRIER WALL AND IMPACT ATTENUATORS, APPROVED BY IDOT AT NO ADDITIONAL COST TO IDOT.

FILE NAME =	USER NAME =	DESIGNED - RDT	REVISED -	<b>STATE OF ILLINOIS DEPARTMENT OF TRANSPORTATION</b>	<b>ILLINOIS ROUTE 2 STAGE 3</b>		F.A.P. RTE.	SECTION	COUNTY	TOTAL SHEETS	SHEET NO.
et:\pw\work\p\dtd\rund\laderr\d0331856	0264h70-sh-t-staging03-05.dgn	DRAWN - RDT	REVISED -				734	77R-1	WINNEBAGO	179	67
		CHECKED - JAC	REVISED -				CONTRACT NO. 64H70			ILLINOIS FED. AID PROJECT	
		DATE - 10/05/2012	REVISED -				SCALE: 1"=50'	SHEET NO. 67 OF 179 SHEETS	STA. 1015+00 TO STA. 1036+15		