

EXIST. CURVE IL2.EX1-4
 PI STA. = 1012+81.23
 Δ = 8° 59' 54" (LT)
 D = 1° 47' 46"
 R = 3,190.00'
 T = 251.01'
 L = 501.00'
 E = 9.86'
 e = N/A
 P.C. STA. = 1010+30.22
 P.T. STA. = 1015+31.21

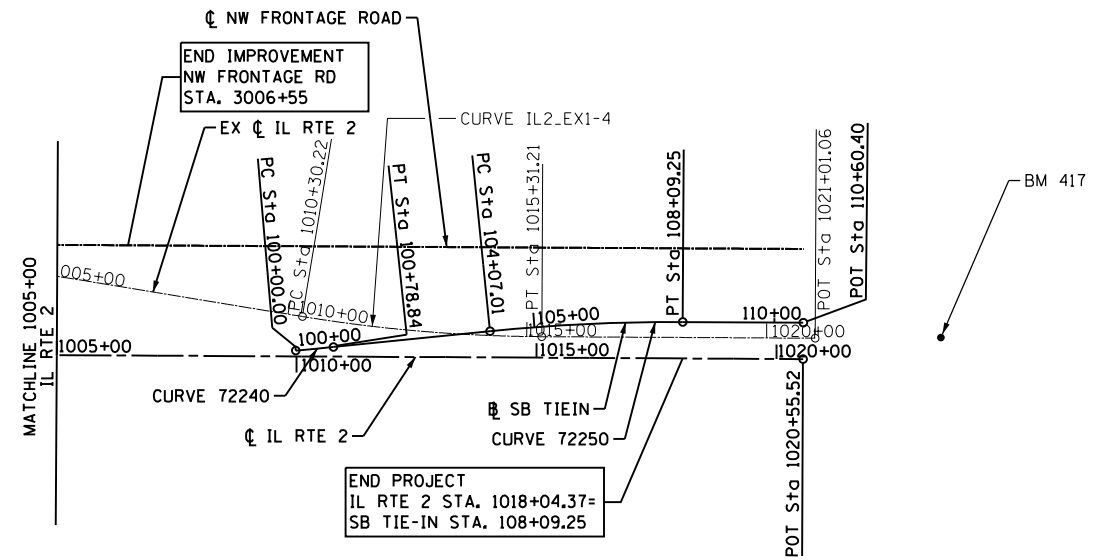

PROP. CURVE 72240
 PI STA. = 100+39.42
 Δ = 1° 10' 39" (LT)
 D = 1° 29' 37"
 R = 3,836.00'
 T = 39.42'
 L = 78.84'
 E = 0.20'
 e = N.C.
 P.C. STA. = 100+00.00
 P.T. STA. = 100+78.84

PROP. CURVE 72250
 PI STA. = 106+08.32
 Δ = 6° 04' 16" (RT)
 D = 1° 30' 34"
 R = 3,796.00'
 T = 201.31'
 L = 402.24'
 E = 5.33'
 e = N.C.
 P.C. STA. = 104+07.01
 P.T. STA. = 108+09.25

ALIGNMENT DATA

CHAIN	CURVE NO.	POINT	STATION	NORTHING	EASTING	DELTA	TANGENT	LENGTH	RADIUS
IL2-PR1.INTERIM	70012	70012	955+00.0000	2,092,244.4629	2,590,398.8332				
		CC		2,093,608.0653	2,605,334.7014				
	71260	PC	965+23.8170	2,093,268.0155	2,590,375.5659				
		PI	967+85.9368	2,093,530.0675	2,590,367.6090	2° 00' 26" RT	262.1197'	524.1858'	14,963.0000'
		PT	970+48.0029	2,093,792.1674	2,590,372.8340				
	71270	CC			2,096,285.3836	2,576,290.4442			
PC		993+67.7632	2,096,111.7521	2,590,401.3759					
PI		995+88.8977	2,096,332.8699	2,590,404.0967	1° 47' 44" LT	221.1346'	442.2330'	14,112.0000'	
PT		998+09.9961	2,096,553.9645	2,590,399.8881					
70013	70013	1020+55.5228	2,098,799.0844	2,590,357.1510					
	CC			2,097,319.0147	2,586,552.6307				
IL2.INT.TIEIN	72240	PC	100+00.0000	2,097,741.6482	2,590,365.2777				
		PI	100+39.4232	2,097,780.8314	2,590,360.9342	1° 10' 39" LT	39.4232'	78.8437'	3,836.0000'
	72250	PC	100+78.8437	2,097,819.9171	2,590,355.7864				
		CC			2,098,618.7778	2,594,081.2572			
ROSCOE.NW.FR	72220	PC	104+07.0129	2,098,145.5260	2,590,314.8731				
		PI	106+08.3194	2,098,345.2620	2,590,289.7760	6° 04' 16" RT	201.3065'	402.2362'	3,796.0000'
	72230	PC	108+09.2492	2,098,546.5320	2,590,285.9447				
		CC			2,095,001.5876	2,590,186.9147			
ROSCOE	72210	72210	2976+20.8328	2,094,478.0407	2,589,847.9556				
		CC			2,095,024.4043	2,589,837.6592			
	72220	PC	2981+68.3612	2,095,181.9732	2,589,847.9531	48° 33' 56" RT	157.90'	296.67'	350.00'
		PI	2983+26.2660	2,095,278.5288	2,589,972.8969				
		PT	2984+65.0319	2,095,616.6178	2,589,838.0052				
	70014	CC			2,095,616.6178	2,589,838.0052			
PC		2985+65.0319	2,095,339.6767	2,590,052.0230					
PI		2987+41.0306	2,095,447.2963	2,590,191.2837	53° 23' 29" LT	175.9987'	326.1494'	350.0000'	
ROSCOE	46	9000+00.0000	2,094,428.5518	2,587,555.8648					
		47	9026+70.0000	2,094,487.3663	2,590,225.2170				
		48	9042+70.0000	2,094,530.5055	2,591,824.6353				

CC = CENTER OF CURVE
 PC = POINT OF CURVATURE
 PI = POINT OF INTERCEPT
 PT = POINT OF TANGENCY

TIES DATA

POINT NO.	NORTHING	EASTING	DESCRIPTION
553	2,101,148.5255	2,590,435.7048	SHINER IN POWER POLE
554	2,101,155.2672	2,590,336.5318	SHINER IN SIGN POST
555	2,101,369.9706	2,590,243.4975	LIONS CLUB SIGN
556	2,100,095.7101	2,590,377.2771	SHINER IN SIGN POST
557	2,100,376.8148	2,590,459.6366	FACE OF 24" DECIDUOUS TREE
558	2,100,208.9256	2,590,543.4213	SHINER IN SIGN POST