

FILE NAME: \\stgpcoupsturncc.com\3\CHIL\Vol3\Projects\4015550\4015550_0001\90_CAD_Models_and_Sheets\04_Civil\Sheets\0264428-Detour_Complete.dgn

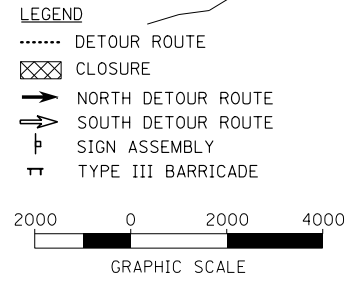
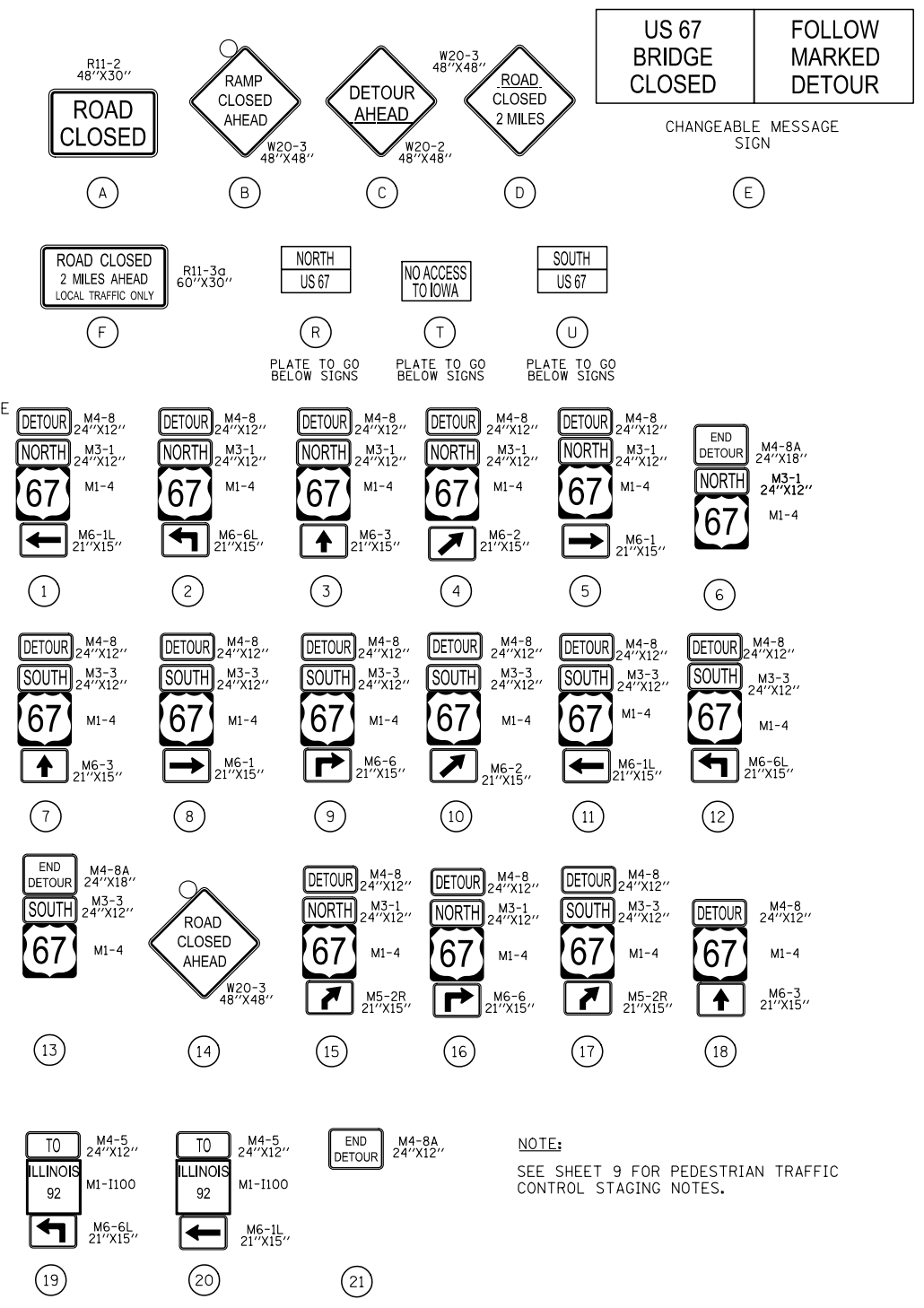
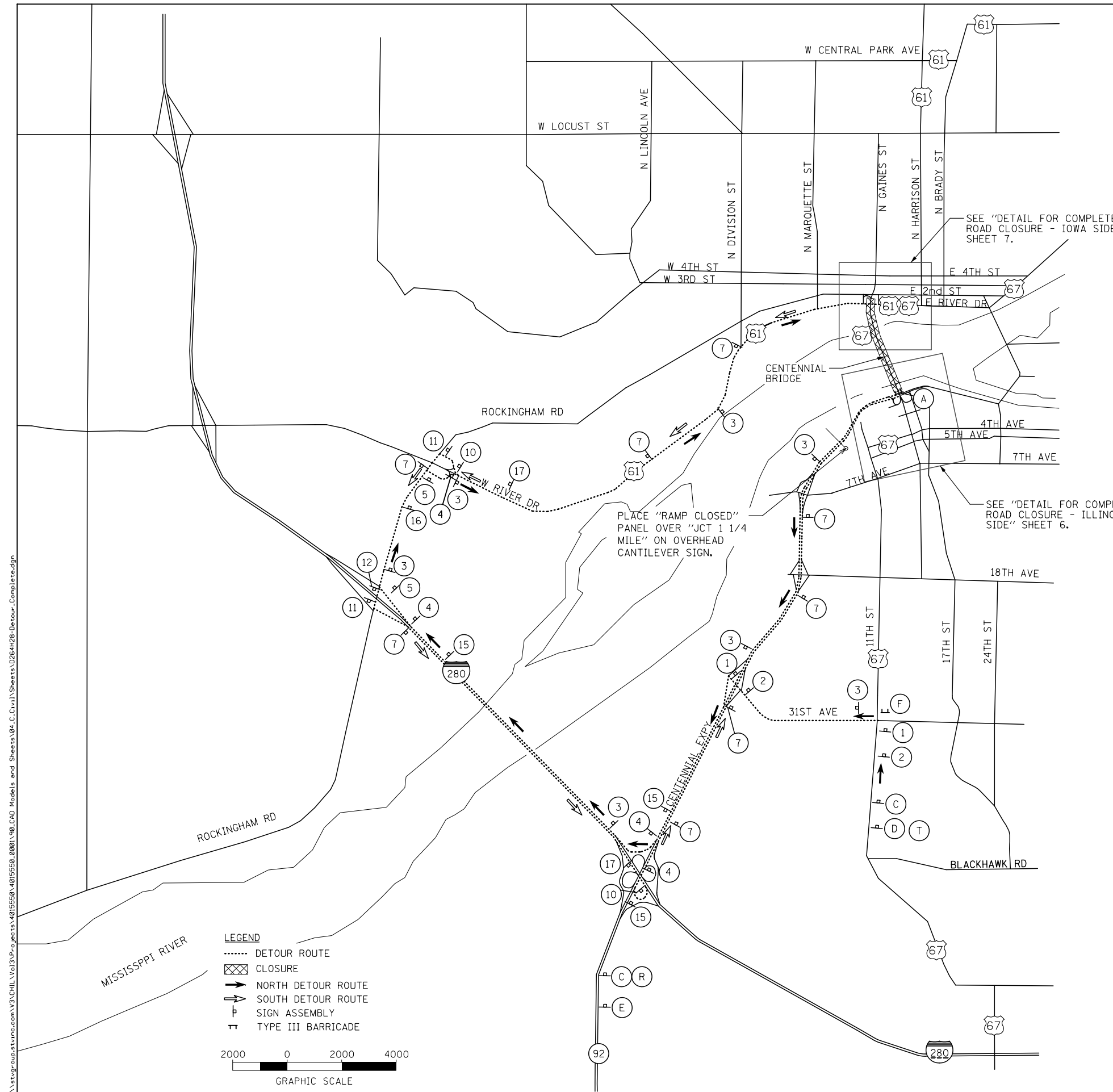

USER NAME = thompsrd	DESIGNED - RDT/GC	REVISED -
DRAWN - RDT	REVISED -	
PLOT SCALE = 4000.0000' / in.	CHECKED - JAC	REVISED -
PLOT DATE = 1/21/2014	DATE - 11-08-2013	REVISED -

**STATE OF ILLINOIS
DEPARTMENT OF TRANSPORTATION**

**US 67 OVER MISSISSIPPI RIVER STRUCTURE NO. 081-995
BRIDGE CLOSURE DETOUR PLAN**

F.A.P. RTE. 308	SECTION (3BRIM)	COUNTY ROCK ISLAND	TOTAL SHEETS 47	SHEET NO. 5
C-92-090-12		CONTRACT NO. 64H28		
ILLINOIS FED. AID PROJECT HSIP-XXXX (XXX)				

SCALE: 1" = 4000' SHEET NO. 5 OF 47 SHEETS STA. _____ TO STA. _____

NOTE:
SEE SHEET 9 FOR PEDESTRIAN TRAFFIC CONTROL STAGING NOTES.