

LONGITUDINAL SECTION

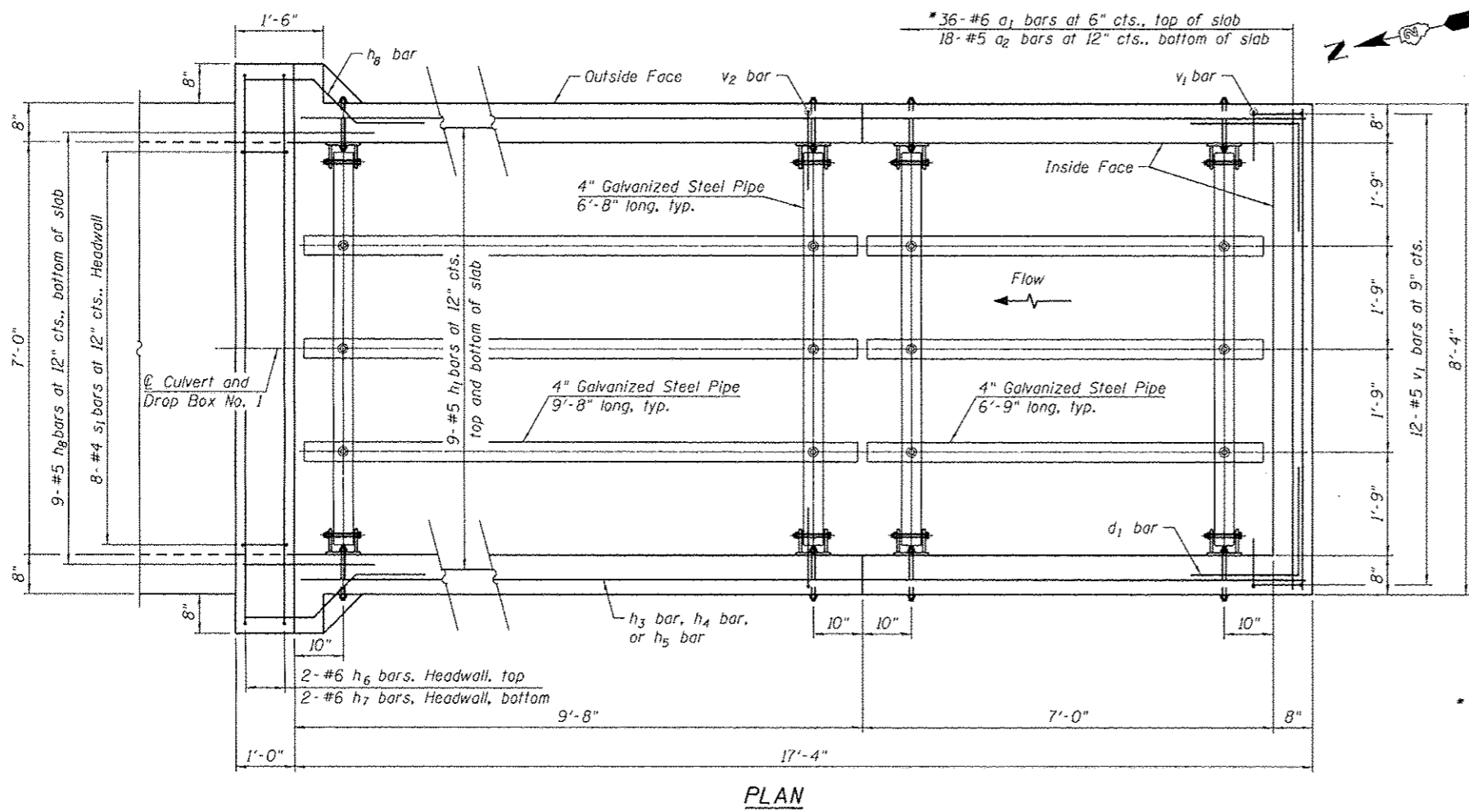

PLAN

GENERAL NOTES:

1. Reinforcement bars shall conform to the requirements of ASTM A 706 Gr. 60.
2. All exposed concrete edges shall be chamfered $\frac{3}{4}$ " unless otherwise noted.
3. All construction joints shall be bonded.
4. The contract unit price "Each" for Drop Box No. 1 shall include the Concrete Structures, Reinforcement Bars, earth excavation where required, backfilling and necessary grading to fit the structure as shown, or to the slope.
5. Contractor shall field verify galvanized pipe length.
6. The minimum distance from the center of a hole to the free edge of a structural shape or plate shall be $1\frac{1}{2}$ " unless noted otherwise.
7. This work shall be done according to the applicable portions of 501, 503, 505, 508, and 540 of the Standard Specifications.

DESIGN STRESSES
FIELD UNITS

$f'_c = 3,500$ psi
 $f_y = 60,000$ psi (Reinforcement)

TOTAL BILL OF MATERIAL

ITEM	UNIT	TOTAL
* Traversable Pipe Grate	Foot	76
Drop Box No. 1	Each	1

* Indicates Special Provision



Brian J. Malone DATE 9-18-2013
EXPIRES: 11-30-2014
SHEETS: S-1 thru S-2

* Tilt #6 a1 and #6 h6 bars as required to maintain clearance.

PLAN AND ELEVATION
DROP BOX NO. 1 RT
STATION 412+60.50

9/18/2013 3:17:26 PM I:\2008-64H04-S11-01-DE701.dgn



DESIGNED - BJM	REVISED -
CHECKED - MAS	REVISED -
DRAWN - MWS	REVISED -
CHECKED - BJM	REVISED -

PLOT DATE • 9/18/2013

STATE OF ILLINOIS
DEPARTMENT OF TRANSPORTATION

PLAN AND ELEVATION
DROP BOX NO. 1
SHEET NO. S-1 OF 2 SHEETS

F.A.P.	SECTION	COUNTY	TOTAL SHEETS	SHEET NO.
505	(W-150)T-2	WINNEBAGO	41	27

CONTRACT NO. 64H04
ILLINOIS FED. AID PROJECT