









EROSION CONTROL GENERAL NOTES

THIS PROJECT WILL REQUIRE AUTHORIZATION UNDER NPDES ILRIO (SWPPP PERMIT).

THE DEPARTMENT HAS NOT OBTAINED ANY PERMITS FOR OFFSITE BORROW, WASTE, USE (BWU) AREAS, PRIOR TO WORKING IN BWU AREAS, IF THE CONTRACTOR CHOOSES TO USE ACTIVITIES REQUIRING PERMITS IT IS THE CONTRACTORS RESPONSIBILITY TO SECURE THE PROPER PERMITS. IN ADDITION TO THE BORROW REVIEW (BDE 2289) AND USE/WASTE REVIEW (BDE 2290) SUBMITTALS, THE CONTRACTOR SHALL SUBMIT AN EROSION AND SEDIMENT CONTROL (ESC) PLAN FOR EVERY BWU SITE TO THE DEPARTMENT FOR ACCEPTANCE. GUIDELINES FOR ACCEPTABLE BWU PRACTICES CAN BE FOUND IN SECTION II.G.1 AND 2 OF THE SWPPP. THE COST OF ALL MATERIALS AND LABOR NECESSARY TO COMPLY WITH THE ABOVE PROVISIONS TO PREPARE AND IMPLEMENT ESC PLANS WILL NOT BE PAID FOR SEPARATELY, BUT SHALL BE CONSIDERED AS INCLUDED IN THE UNIT BID PRICES OF THE CONTRACT AND NO ADDITIONAL COMPENSATION WILL BE ALLOWED.

LEGEND

-  - PROP. TOPSOIL FURNISH AND PLACE, 4"
-  - PROP. SEEDING, CLASS 2
-  - PROP. MULCH, METHOD 1
-  - PERIMETER EROSION BARRIER
-  - TEMPORARY FENCE
-  - TEMPORARY DITCH CHECK
-  - EROSION CONTROL BLANKET
-  - INLET FILTER

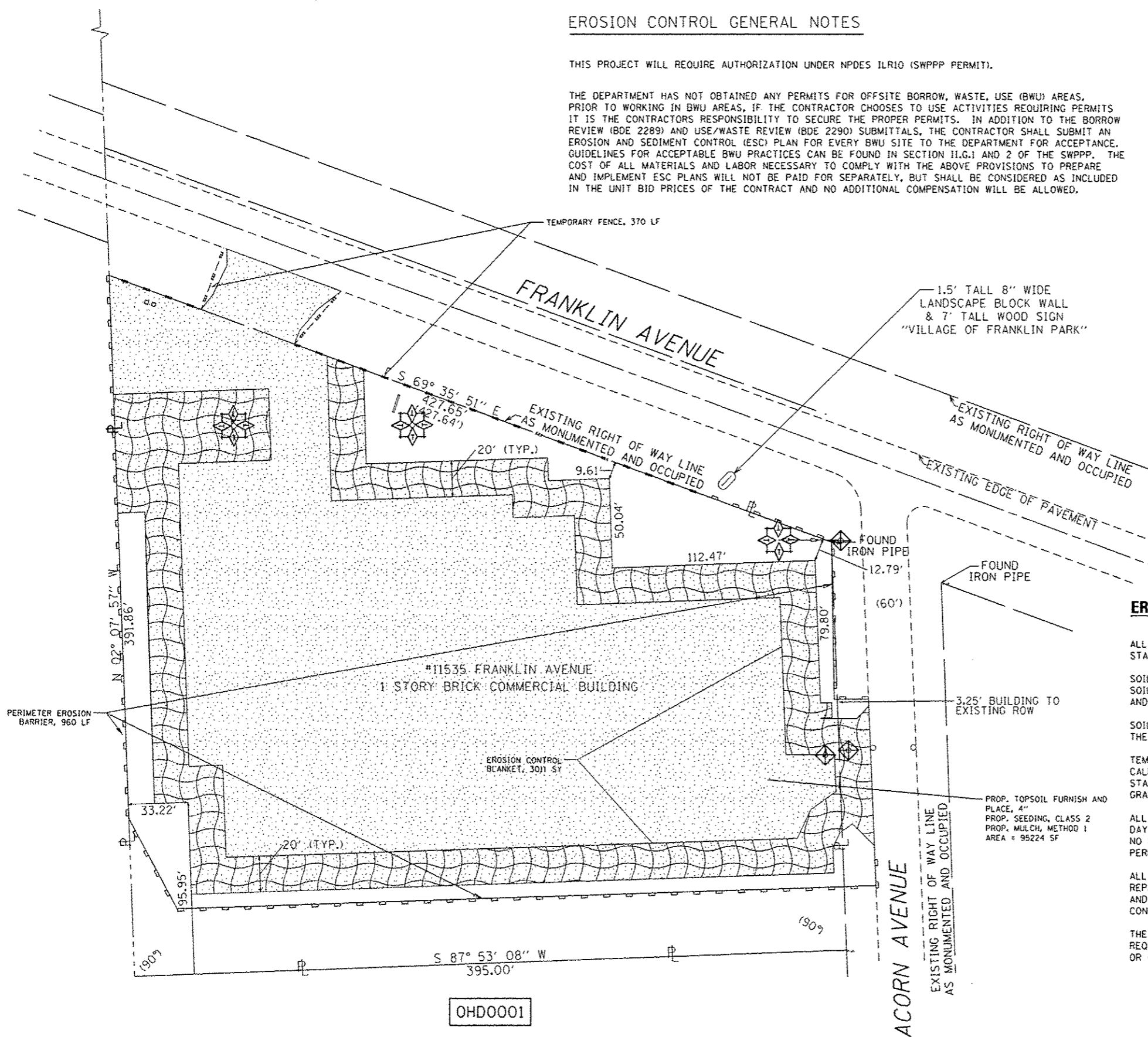

EROSION CONTROL GENERAL NOTES

ALL EROSION CONTROL MEASURES SHALL BE IN ACCORDANCE WITH THE PROCEDURES AND STANDARDS FOR URBAN SOIL EROSION AND SEDIMENTATION CONTROL MANUAL.

SOIL DISTURBANCE SHALL BE CONDUCTED IN SUCH A MANNER AS TO MINIMIZE EROSION. SOIL STABILIZATION MEASURES SHALL CONSIDER THE TIME OF YEAR, SITE CONDITIONS, AND THE USE OF TEMPORARY OR PERMANENT MEASURES.

SOIL EROSION AND SEDIMENTATION CONTROL FEATURES SHALL BE CONSTRUCTED PRIOR TO THE COMMENCEMENT OF UPLAND DISTURBANCE.

TEMPORARY SOIL STABILIZATION SHALL BE APPLIED TO DISTURBED AREAS WITHIN 14 CALENDAR DAYS OF THE END OF THE ACTIVE HYDROLOGIC DISTURBANCE. PERMANENT STABILIZATION SHALL BE DONE WITHIN 14 DAYS AFTER COMPLETION OF THE FINAL GRADING OF THE SOIL.

ALL TEMPORARY EROSION AND SEDIMENT CONTROL MEASURES SHALL BE REMOVED WITHIN 30 DAYS AFTER FINAL SITE STABILIZATION IS ACHIEVED OR AFTER TEMPORARY MEASURES ARE NO LONGER NEEDED. TRAPPED SEDIMENT AND OTHER DISTURBED SOIL AREAS SHALL BE PERMANENTLY STABILIZED.

ALL TEMPORARY AND PERMANENT EROSION CONTROL MEASURES MUST BE MAINTAINED AND REPAIRED AS NEEDED. THE GENERAL CONTRACTOR WILL BE RESPONSIBLE FOR INSPECTION AND REPAIR DURING CONSTRUCTION. THE OWNER WILL BE RESPONSIBLE IF EROSION CONTROL IS REQUIRED AFTER THE CONTRACTOR HAS COMPLETED THE PROJECT.

THE EROSION CONTROL MEASURES INDICATED ON THE PLANS ARE THE MINIMUM REQUIREMENTS. ADDITIONAL MEASURES MAY BE REQUIRED, AS DIRECTED BY THE ENGINEER OR GOVERNING AGENCY.

OHDO001

Rev. 2-18-14

FILE NAME =	USER NAME = terrqfm	DESIGNED -	REVISED - PLP Q2/11/2014	STATE OF ILLINOIS DEPARTMENT OF TRANSPORTATION		LANDSCAPING AND EROSION CONTROL PLAN 11535 FRANKLIN AVENUE, FRANKLIN PARK, IL 60131 (LOCATION 3)			F.A.P. RTE.	SECTION	COUNTY	TOTAL SHEETS	SHEET NO.
c:\pwwork\pwwork\terrqfm\115352312\115352312.dgn	DRAWN -	REVISED -	345						2013-0730M	DUPAGE/COOK	13	9	
PLOT SCALE = 60.0000' / 1" =	CHECKED -	REVISED -	CONTRACT NO. 60X50										
PLOT DATE = 2/13/2014	DATE -	REVISED -	ILLINOIS FED. AID PROJECT										
				SCALE: 1"=30'	SHEET NO. 3 OF 3 SHEETS	STA.	TO STA.						