

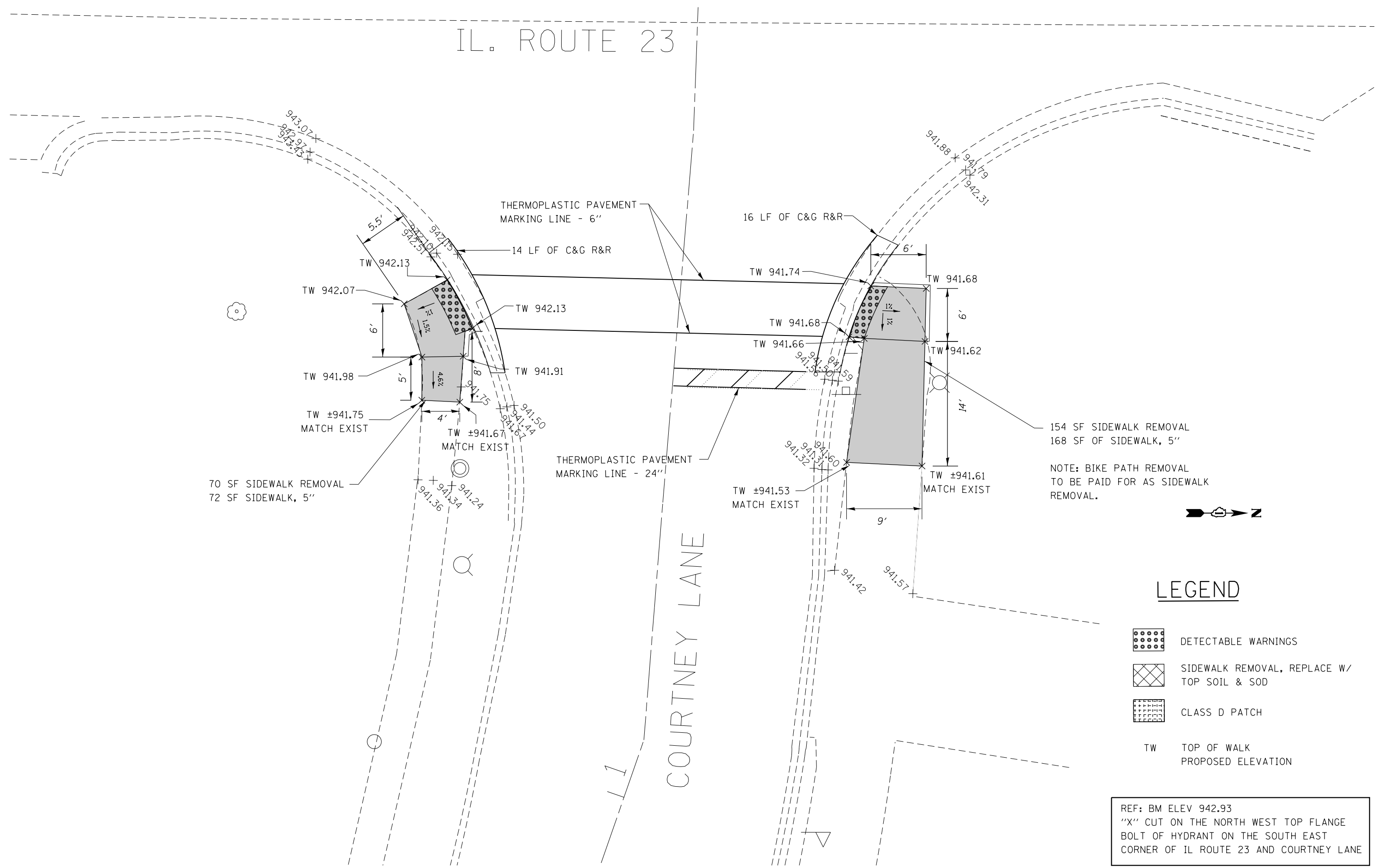

IL. ROUTE 23

COURTNEY LANE

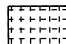

LEGEND

-  DETECTABLE WARNINGS
-  SIDEWALK REMOVAL, REPLACE W/ TOP SOIL & SOD
-  CLASS D PATCH
- TW TOP OF WALK PROPOSED ELEVATION

REF: BM ELEV 942.93
 "X" CUT ON THE NORTH WEST TOP FLANGE
 BOLT OF HYDRANT ON THE SOUTH EAST
 CORNER OF IL ROUTE 23 AND COURTNEY LANE

FILE NAME =	USER NAME = Bilgramisa	DESIGNED -	REVISED -	STATE OF ILLINOIS DEPARTMENT OF TRANSPORTATION	ROADWAY PLAN - IL 23 (US 20 TO COURTNEY LANE) AT COURTNEY LANE			F.A. RTE.	SECTION	COUNTY	TOTAL SHEETS	SHEET NO.
Default	Plot Scale = 10.0000' / in.	DRAWN -	REVISED -					VAR	2013-058I	McHENRY	58	40
	PLOT DATE = 12/18/2013	CHECKED -	REVISED -		SCALE: 1:5			SHEET OF SHEETS STA. TO STA.			CONTRACT NO. 60X36	
		DATE -	REVISED -		ILLINOIS FED. AID PROJECT							