

IL. ROUTE 23

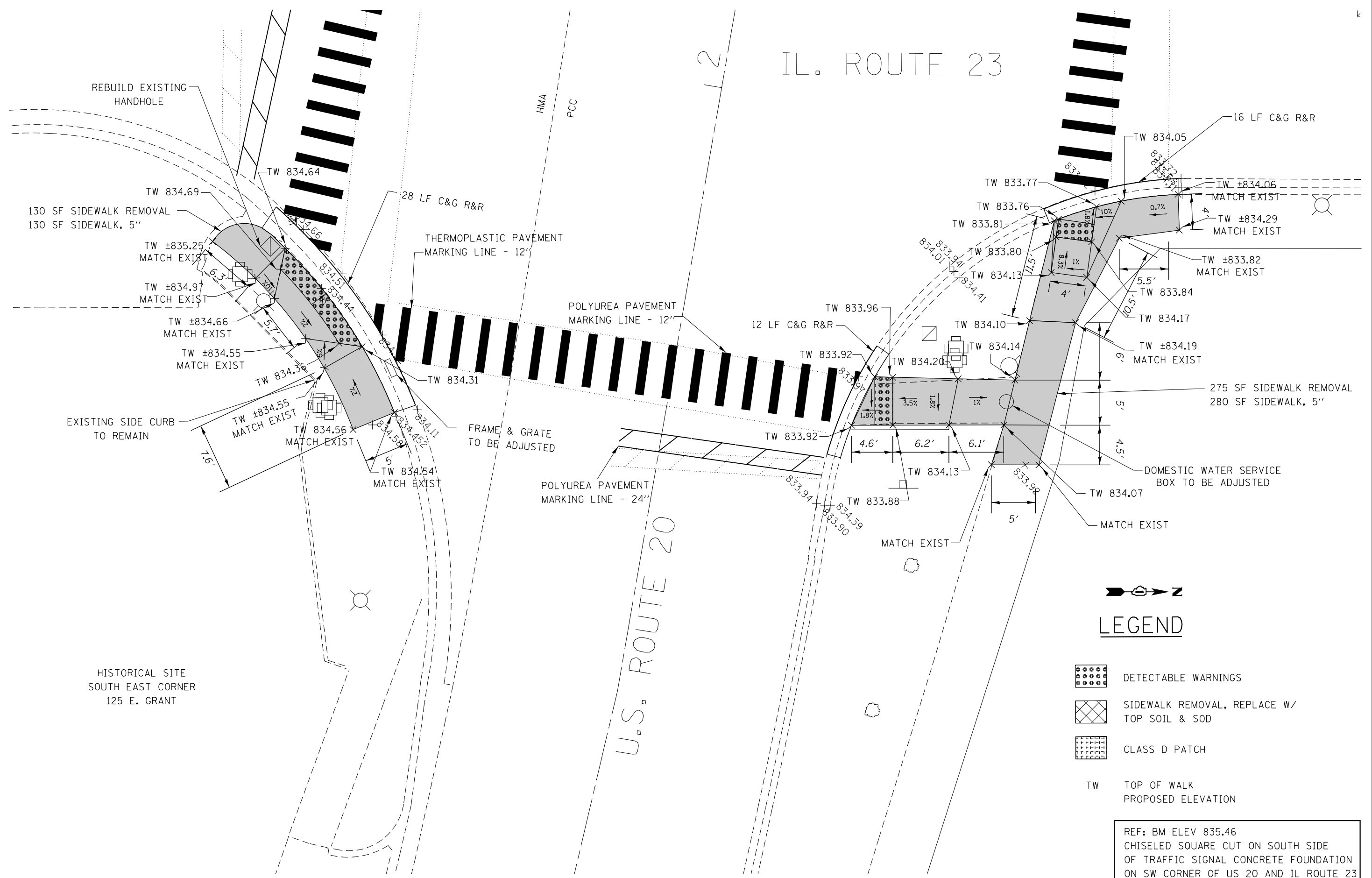
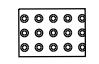
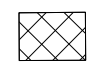
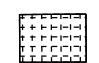

HISTORICAL SITE
SOUTH EAST CORNER
125 E. GRANT

LEGEND

-  DETECTABLE WARNINGS
-  SIDEWALK REMOVAL, REPLACE W/
TOP SOIL & SOD
-  CLASS D PATCH
- TW TOP OF WALK
PROPOSED ELEVATION

REF: BM ELEV 835.46
CHISELED SQUARE CUT ON SOUTH SIDE
OF TRAFFIC SIGNAL CONCRETE FOUNDATION
ON SW CORNER OF US 20 AND IL ROUTE 23

FILE NAME =	USER NAME = Bilgramisa	DESIGNED -	REVISED -
ct:\pw_work\p\idot\bilgramisa\d0362927\0107714-shr-Marengo.dgn		DRAWN -	REVISED -
Default	PLOT SCALE = 10.0000' / in.	CHECKED -	REVISED -
	PLOT DATE = 12/18/2013	DATE -	REVISED -

**STATE OF ILLINOIS
DEPARTMENT OF TRANSPORTATION**

**ROADWAY PLAN - IL 23 (US 20 TO COURTNEY LANE)
AT US 20 (EAST)**

SCALE: 1:5	SHEET	OF	SHEETS	STA.	TO	STA.
------------	-------	----	--------	------	----	------

F.A. RTE.	SECTION	COUNTY	TOTAL SHEETS	SHEET NO.
VAR	2013-058I	McHENRY	58	36
CONTRACT NO. 60X36				
ILLINOIS FED. AID PROJECT				