



LEGEND 

-  DETECTABLE WARNINGS
-  SIDEWALK REMOVAL, REPLACE W/
TOP SOIL & SOD
-  CLASS D PATCH
- TW TOP OF WALK
PROPOSED ELEVATION

NOTE: ANY DAMAGE TO THE EXISTING BRICK SIDEWALK SHALL BE FIXED AT CONTRACTOR'S EXPENSE.

HISTORICAL SITE
SOUTH WEST CORNER
109 W. GRANT
320 S. STATE

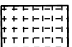
U.S. ROUTE 20
13

IL. ROUTE 23

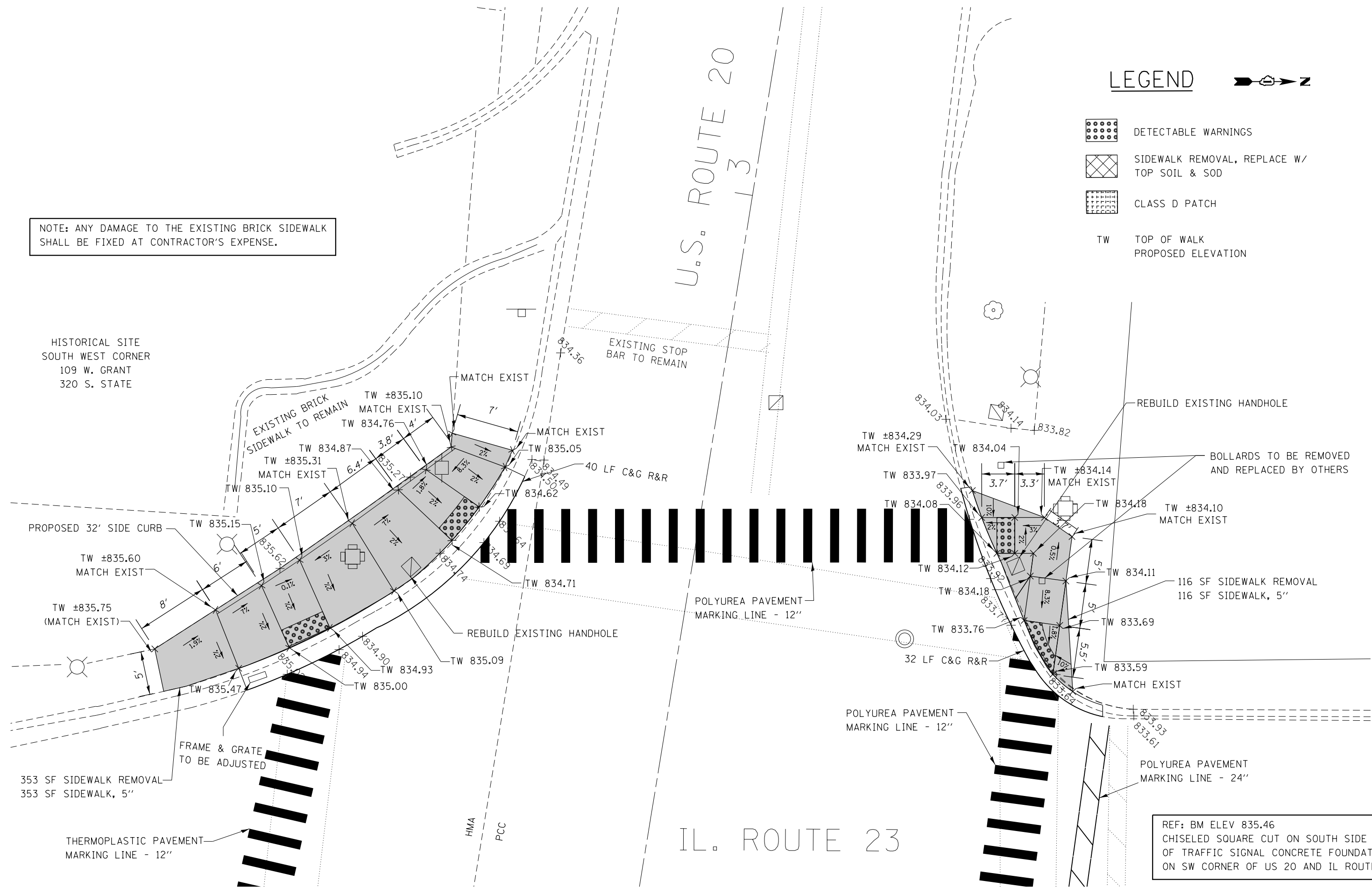

REF: BM ELEV 835.46
CHISELED SQUARE CUT ON SOUTH SIDE
OF TRAFFIC SIGNAL CONCRETE FOUNDATION
ON SW CORNER OF US 20 AND IL ROUTE 23

FILE NAME =	USER NAME = Bilgramis	DESIGNED -	REVISED -
ei:\pwork\pwork\dot\bilgramis\d0362927\07714-sh1-Marengo.dgn		DRAWN -	REVISED -
Default	PLOT SCALE = 10.0000 "/> <td>CHECKED -</td> <td>REVISED -</td>	CHECKED -	REVISED -
	PLOT DATE = 12/18/2013	DATE -	REVISED -

**STATE OF ILLINOIS
DEPARTMENT OF TRANSPORTATION**

ROADWAY PLAN - IL 23 (US 20 TO COURTNEY LANE) AT US 20 (WEST)			
SCALE: 1:5	SHEET	OF SHEETS	STA. TO STA.

F.A. RTÉ.	SECTION	COUNTY	TOTAL SHEETS	SHEET NO.
VAR	2013-0581	McHENRY	58	35
CONTRACT NO. 60X36				
ILLINOIS FED. AID PROJECT				