



IL. ROUTE 173

LEGEND



-  DETECTABLE WARNINGS
-  SIDEWALK REMOVAL
-  CLASS D PATCH
- TW TOP OF WALK
PROPOSED ELEVATION

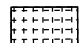
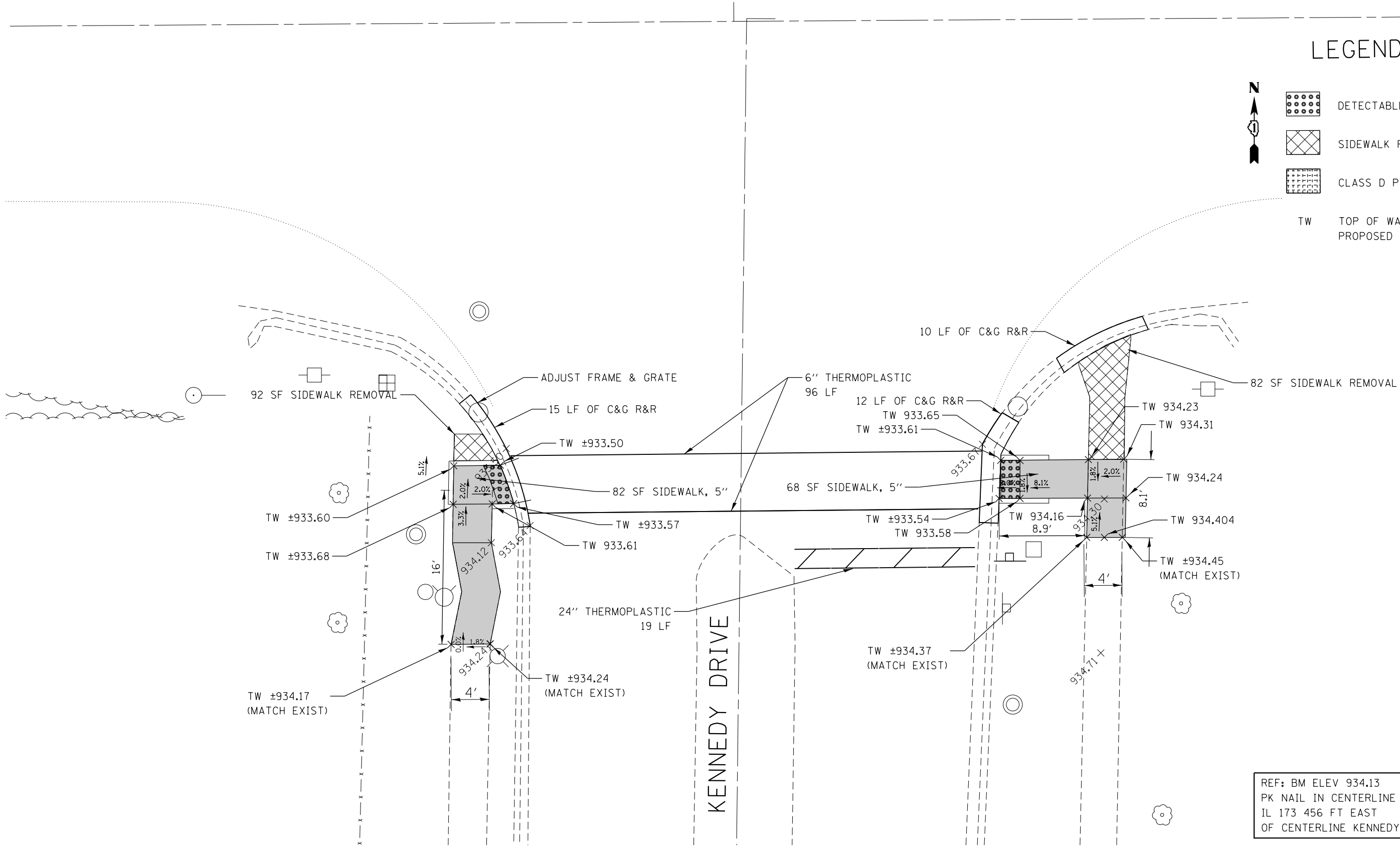

REF: BM ELEV 934.13
 PK NAIL IN CENTERLINE
 IL 173 456 FT EAST
 OF CENTERLINE KENNEDY DRIVE

FILE NAME =	USER NAME = Bilgramisa	DESIGNED -	REVISED -
et:\pw\work\p\idot\bilgramisa\d0362927\0107714-shr-Hebron.dgn		DRAWN -	REVISED -
Default	PLOT SCALE = 10.0000' / in.	CHECKED -	REVISED -
	PLOT DATE = 12/18/2013	DATE -	REVISED -

STATE OF ILLINOIS
 DEPARTMENT OF TRANSPORTATION

ROADWAY PLAN - IL 173 (KENNEDY DR. TO CENTER ST.) AT KENNEDY DRIVE			
SCALE: 1:5	SHEET	OF SHEETS	STA. TO STA.

F.A. RTÉ.	SECTION	COUNTY	TOTAL SHEETS	SHEET NO.
VAR.	2013-0581	McHENRY	58	23
				CONTRACT NO. 60X36
ILLINOIS FED. AID PROJECT				