

EXISTING CONTROLLER SEQUENCE

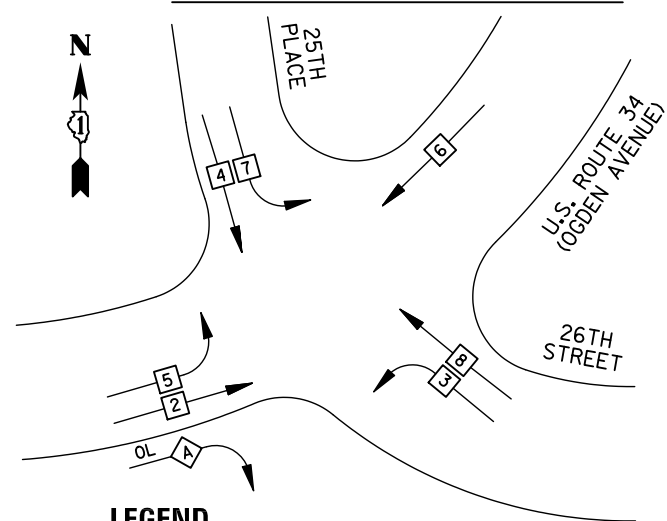

LEGEND

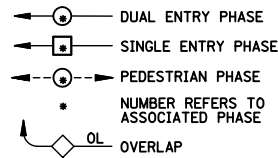

**RIGHT TURN OVERLAP
PHASE DESIGNATION**

OVERLAP LETTER PERMISSIVE PHASE PROTECTED PHASE
A = 2 + 3

**EXISTING
PHASE DESIGNATION DIAGRAM**

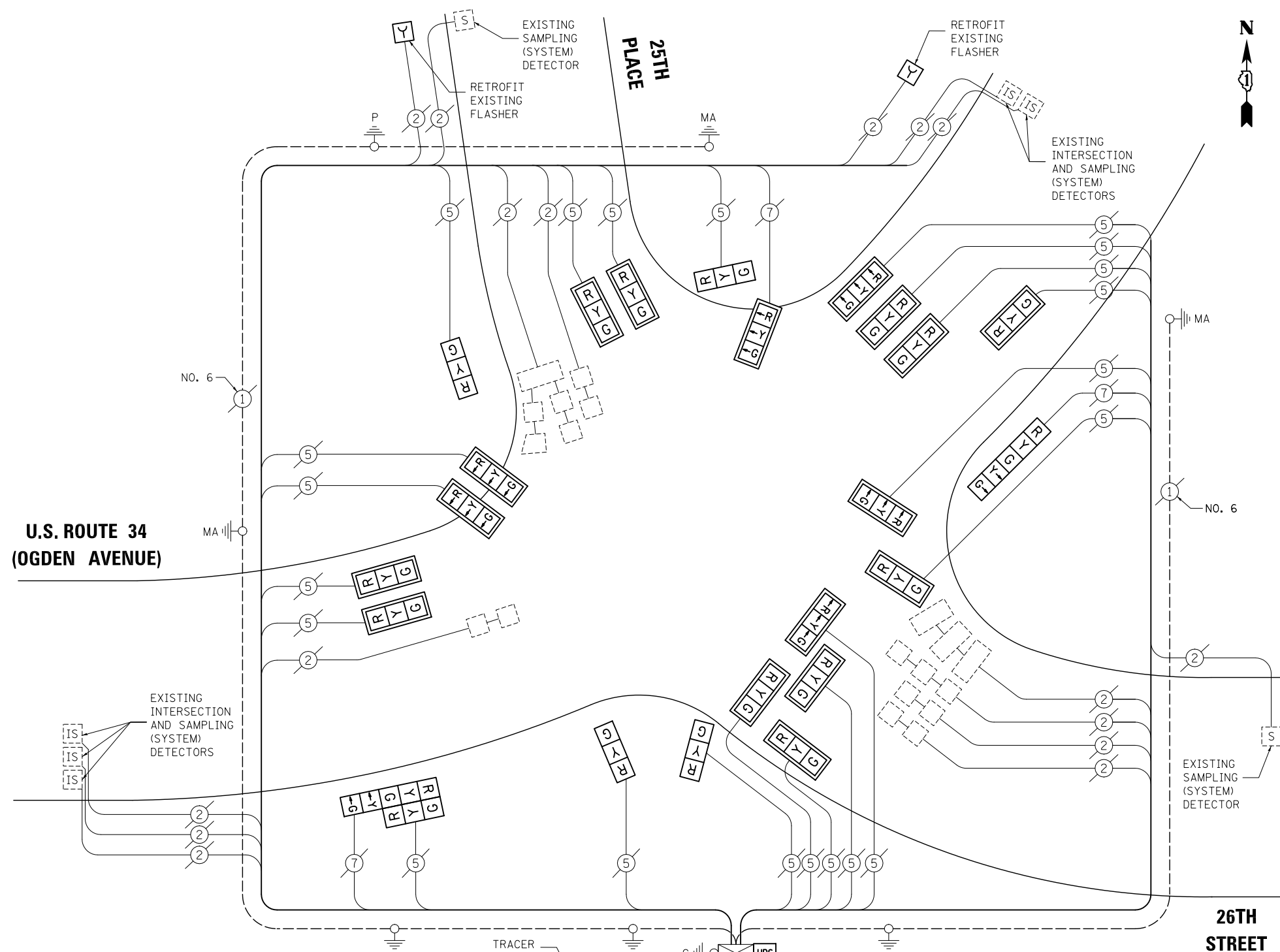

SCHEDULE OF QUANTITIES

ITEM
 MAINTENANCE OF EXISTING TRAFFIC SIGNAL INSTALLATION
 MODIFY EXISTING CONTROLLER CABINET
 UNINTERRUPTIBLE POWER SUPPLY, SPECIAL
 SIGNAL HEAD, LED, 2-FACE, 1-3 SECTION, 1-5 SECTION, BRACKET MOUNTED, RETROFIT
 SIGNAL HEAD, LED, 1-FACE, 3-SECTION, BRACKET MOUNTED, RETROFIT
 SIGNAL HEAD, LED, 1-FACE, 3-SECTION, MAST ARM MOUNTED, RETROFIT
 SIGNAL HEAD, LED, 1-FACE, 5-SECTION, BRACKET MOUNTED, RETROFIT
 SIGNAL HEAD, LED, 1-SECTION, POST MOUNTED, RETROFIT
 SIGNAL HEAD, LED, 3-SECTION, HORIZONTAL MOUNTED, RETROFIT

UNIT	QUANTITY
EACH	1
EACH	1
EACH	1
EACH	1
EACH	4
EACH	14
EACH	1
EACH	2
EACH	3

CABLE PLAN

NOTE:
 THE TRAFFIC SIGNAL CONTROL EQUIPMENT FOR THIS PROJECT SHALL BE "ECONOLITE" TO MATCH THE EXISTING ADJACENT SYSTEM.

**RETROFIT ALL VEHICULAR
SIGNAL HEADS TO L.E.D.**

I.D.O.T TRAFFIC SIGNAL INSTALLATION ELECTRICAL SERVICE REQUIREMENTS					
TYPE	NO. LAMPS	WATTAGE		%OPERATION	TOTAL WATTAGE
		INCAND.	LED		
SIGNAL (RED)	24	135	17	0.50	204
(YELLOW)	24	135	25	0.25	150
(GREEN)	24	135	15	0.25	90
ARROW	4	135	12	0.10	4.8
PED. SIGNAL		90	25	1.00	
CONTROLLER	1	100	100	1.00	100
ILLUM. SIGN		84	100	0.50	
FLASHER	2	135	25	0.50	25
ENERGY COSTS TO: ILLINOIS DEPARTMENT OF TRANSPORTATION 201 WEST CENTER COURT SCHAUMBURG, IL 60196-1096					TOTAL = 573.8
ENERGY SUPPLY CONTACT:	X				
PHONE:	X				
COMPANY:	X				

FILE NAME = \MICROST\352108\62-5556.DGN
 USER NAME = JGC
 DESIGNED - BPT
 DRAWN - JGC/RDS
 PLOT SCALE = NOT TO SCALE
 PLOT DATE = X
 CHECKED - BPT
 DATE - 12-04-13
 REVISED -
 REVISED -
 REVISED -
 REVISED -

**STATE OF ILLINOIS
DEPARTMENT OF TRANSPORTATION**

**SCHEDULE OF QUANTITIES, CABLE PLAN
AND PHASE DESIGNATION DIAGRAM
U.S. ROUTE 34 (OGDEN AVENUE) AT 25TH PLACE / 26TH STREET**
 SCALE: N.T.S. SHEET NO. OF SHEETS STA. TO STA.

PREPARED BY:
CEMCON, Ltd.
 Consulting Engineers, Land Surveyors & Planners
 2280 White Oak Circle, Suite 100
 Aurora, Illinois 60504-9675
 Ph: 630.862.2100 Fax: 630.862.2199
 E-Mail: cadd@cemcon.com Website: www.cemcon.com

F.A.P. RTE.	SECTION	COUNTY	TOTAL SHEETS	SHEET NO.
VAR.	2013-054TS	COOK	92	69

CONTRACT NO. 60X29
 FED. ROAD DIST. NO. ILLINOIS FED. AID PROJECT

TS# 5556
CICERO