

EXISTING CONTROLLER SEQUENCE

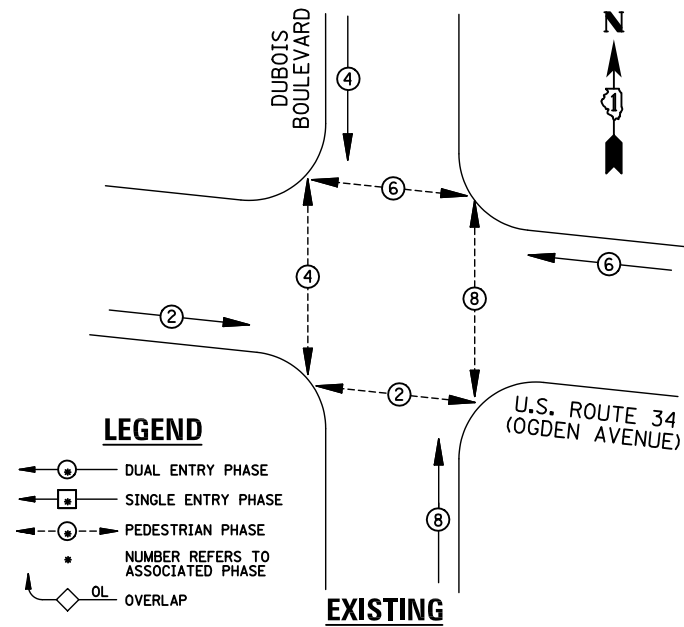

EXISTING PHASE DESIGNATION DIAGRAM

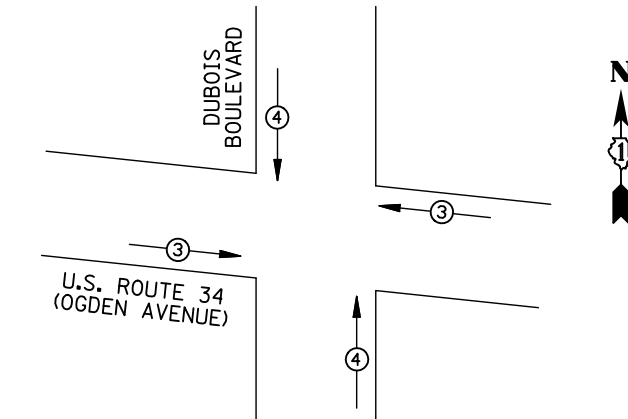

| EMERGENCY VEHICLE PREEMPTORS | | | |
|------------------------------|----|----|--|
| EMERGENCY VEHICLE PREEMPTOR | 3 | 4 | |
| MOVEMENT | ←→ | ↑↓ | |

EXISTING EMERGENCY VEHICLE PREEMPTION SEQUENCE

| I.D.O.T TRAFFIC SIGNAL INSTALLATION ELECTRICAL SERVICE REQUIREMENTS | | | | | |
|---|---------------------------|-----------------|-----------|------------|---------------|
| TYPE | NO. LAMPS | WATTAGE | | %OPERATION | TOTAL WATTAGE |
| | | INCAND. | LED | | |
| SIGNAL (RED) | 12 | 135 | 17 | 0.50 | 102 |
| (YELLOW) | 12 | 135 | 25 | 0.25 | 75 |
| (GREEN) | 12 | 135 | 15 | 0.25 | 45 |
| ARROW | | 135 | 12 | 0.10 | |
| PED. SIGNAL | 8 | 90 | 25 | 1.00 | 200 |
| CONTROLLER | 1 | 100 | 100 | 1.00 | 100 |
| ILLUM. SIGN | | 84 | 100 | 0.50 | |
| FLASHER | | 135 | 25 | 0.50 | |
| ENERGY COSTS TO: ILLINOIS DEPARTMENT OF TRANSPORTATION 201 WEST CENTER COURT SCHAUMBURG, IL 60196-1096 | | | | | TOTAL = 522 |
| ENERGY SUPPLY | CONTACT: X | | | | |
| | PHONE: X | | | | |
| | COMPANY: X | | | | |
| FILE NAME = MICROST\352108\ 35-13871.DGN | USER NAME = JGC | DESIGNED - BPT | REVISED - | | |
| | | DRAWN - JGC/RDS | REVISED - | | |
| | PLOT SCALE = NOT TO SCALE | CHECKED - BPT | REVISED - | | |
| | PLOT DATE = X | DATE - 12-04-13 | REVISED - | | |

REMOVAL OF EXISTING TRAFFIC SIGNAL EQUIPMENT

THE FOLLOWING ITEMS SHALL BE REMOVED BY THE CONTRACTOR AND SHALL BE DISPOSED OF BY THEM OUTSIDE THE RIGHT-OF-WAY AT THEIR EXPENSE. THE SALVAGE VALUE OF THE REMOVED EQUIPMENT SHALL BE REFLECTED IN THE CONTRACT BID PRICE.

- 8 EACH PEDESTRIAN SIGNAL HEAD
- 4 EACH PEDESTRIAN PUSH-BUTTON

SCHEDULE OF QUANTITIES

| ITEM | UNIT | QUANTITY |
|---|------|----------|
| MAINTENANCE OF EXISTING TRAFFIC SIGNAL INSTALLATION | EACH | 1 |
| PEDESTRIAN SIGNAL HEAD, LED, 2-FACE, BRACKET MOUNTED WITH COUNTDOWN TIMER | EACH | 4 |
| MODIFY EXISTING CONTROLLER CABINET | EACH | 1 |
| REMOVE EXISTING TRAFFIC SIGNAL EQUIPMENT | EACH | 1 |
| UNINTERRUPTIBLE POWER SUPPLY, SPECIAL | EACH | 1 |
| PEDESTRIAN PUSH-BUTTON, NON-LATCHING | EACH | 4 |
| SIGNAL HEAD, LED, 1-FACE, 3-SECTION, BRACKET MOUNTED, RETROFIT | EACH | 4 |
| SIGNAL HEAD, LED, 1-FACE, 3-SECTION, MAST ARM MOUNTED, RETROFIT | EACH | 8 |

STATE OF ILLINOIS
DEPARTMENT OF TRANSPORTATION

**SCHEDULE OF QUANTITIES, CABLE PLAN,
PHASE DESIGNATION DIAGRAM AND EMERGENCY VEHICLE PREEMPTION
U.S. ROUTE 34 (OGDEN AVENUE) AT DUBOIS BOULEVARD**

SCALE: N.T.S. SHEET NO. OF SHEETS STA. TO STA.

NOTE:

- PUSH-BUTTON "A" SHALL PLACE A CALL IN PHASES 2 AND 4.
- PUSH-BUTTON "B" SHALL PLACE A CALL IN PHASES 4 AND 6.
- PUSH-BUTTON "C" SHALL PLACE A CALL IN PHASES 6 AND 8.
- PUSH-BUTTON "D" SHALL PLACE A CALL IN PHASES 2 AND 8.

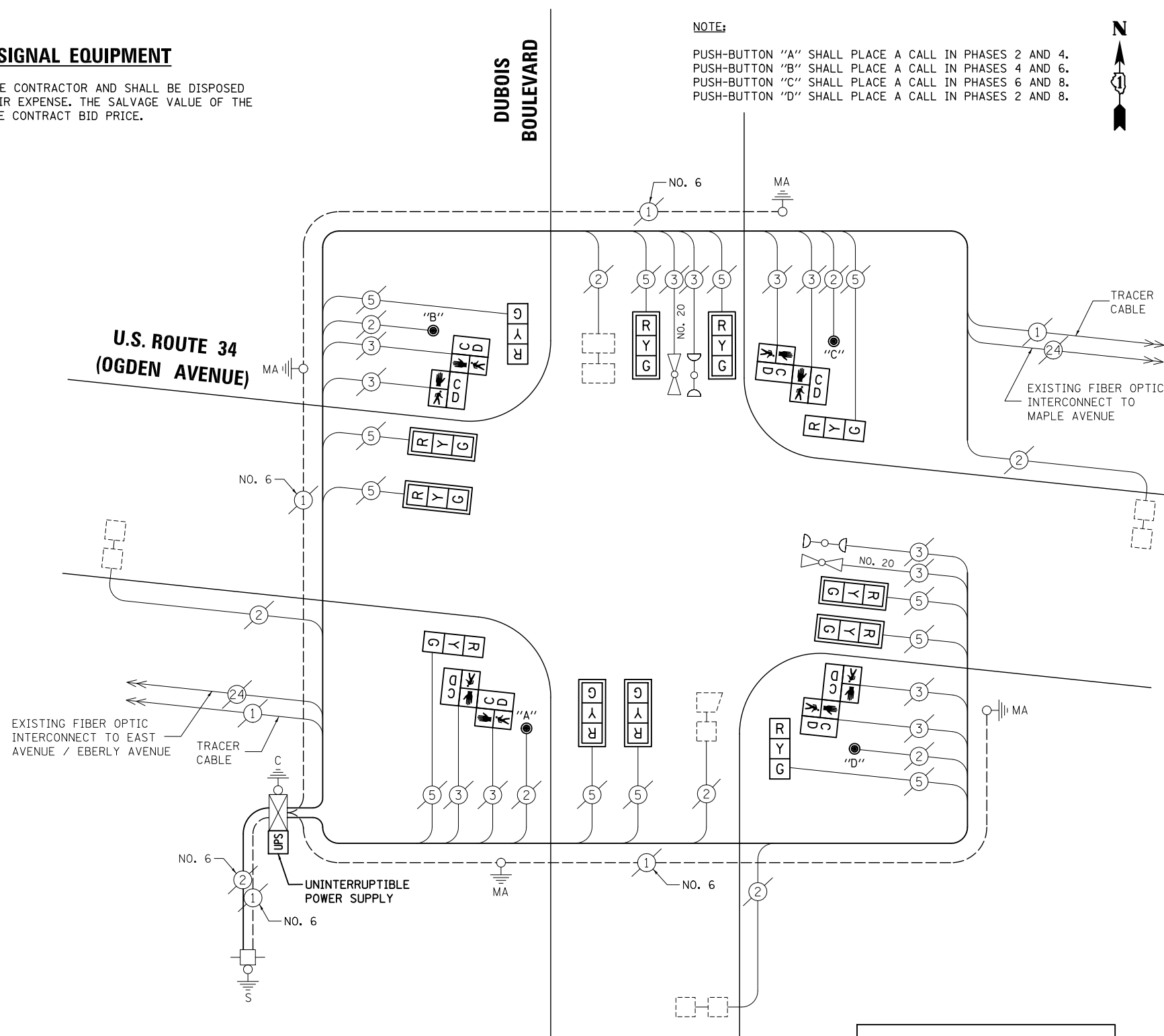

CABLE PLAN

NOTE:
THE TRAFFIC SIGNAL CONTROL EQUIPMENT FOR THIS PROJECT SHALL BE "EAGLE" TO MATCH THE EXISTING ADJACENT SYSTEM.

**RETROFIT ALL VEHICULAR
SIGNAL HEADS TO L.E.D.**

PREPARED BY:
CEMCON, Ltd.
Consulting Engineers, Land Surveyors & Planners
2280 White Oak Circle, Suite 100
Aurora, Illinois 60504-9675
Ph: 630.862.2100 Fax: 630.862.2199
E-Mail: cadd@cemcon.com Website: www.cemcon.com

| F.A.P. RTE. | SECTION | COUNTY | TOTAL SHEETS | SHEET NO. |
|---|------------|--------|--------------|--------------------|
| VAR. | 2013-054TS | COOK | 92 | 49 |
| | | | | CONTRACT NO. 60X29 |
| FED. ROAD DIST. NO. ILLINOIS FED. AID PROJECT | | | | |

TS# 13871
BROOKFIELD