

**EXISTING CONTROLLER SEQUENCE**

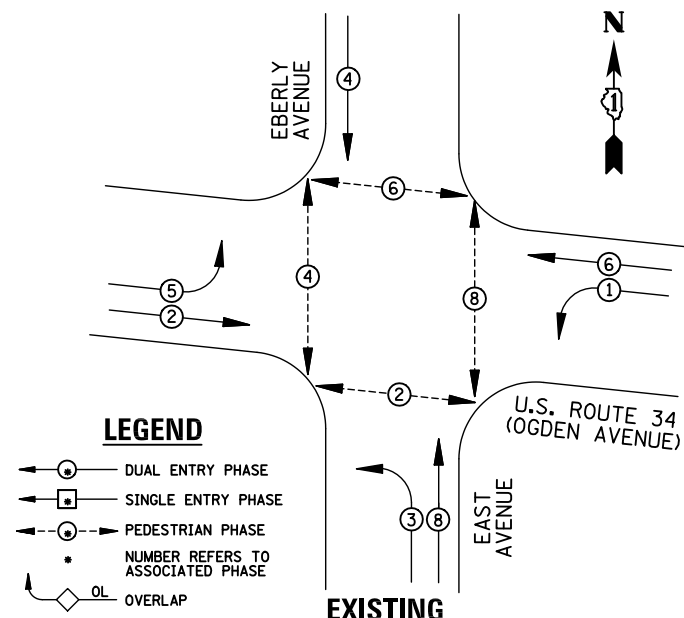

**EXISTING PHASE DESIGNATION DIAGRAM**

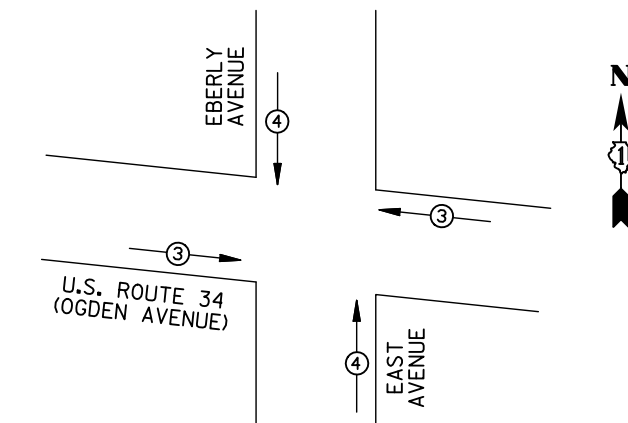

| EMERGENCY VEHICLE PREEMPTORS |    |    |  |
|------------------------------|----|----|--|
| EMERGENCY VEHICLE PREEMPTOR  | 3  | 4  |  |
| MOVEMENT                     | ←→ | ↑↓ |  |

**EXISTING EMERGENCY VEHICLE PREEMPTION SEQUENCE**

**REMOVAL OF EXISTING TRAFFIC SIGNAL EQUIPMENT**

THE FOLLOWING ITEMS SHALL BE REMOVED BY THE CONTRACTOR AND SHALL BE DISPOSED OF BY THEM OUTSIDE THE RIGHT-OF-WAY AT THEIR EXPENSE. THE SALVAGE VALUE OF THE REMOVED EQUIPMENT SHALL BE REFLECTED IN THE CONTRACT BID PRICE.

- 8 EACH SIGNAL HEAD, 3-SECTION
- 6 EACH SIGNAL HEAD, 5-SECTION
- 3 EACH TRAFFIC SIGNAL BACKPLATE
- 4 EACH PEDESTRIAN PUSH-BUTTON

**NOTE:**  
 PUSH-BUTTON "A" SHALL PLACE A CALL IN PHASES 2 AND 4.  
 PUSH-BUTTON "B" SHALL PLACE A CALL IN PHASES 4 AND 6.  
 PUSH-BUTTON "C" SHALL PLACE A CALL IN PHASES 6 AND 8.  
 PUSH-BUTTON "D" SHALL PLACE A CALL IN PHASES 2 AND 8.

**SCHEDULE OF QUANTITIES**

| ITEM  | UNIT | QUANTITY |
|---|------|----------|
| MAINTENANCE OF EXISTING TRAFFIC SIGNAL INSTALLATION                 | EACH | 1        |
| SIGNAL HEAD, LED, 1-FACE, 3-SECTION, BRACKET MOUNTED                | EACH | 3        |
| SIGNAL HEAD, LED, 1-FACE, 5-SECTION, MAST-ARM MOUNTED               | EACH | 3        |
| SIGNAL HEAD, LED, 2-FACE, 3-SECTION, BRACKET MOUNTED                | EACH | 1        |
| SIGNAL HEAD, LED, 2-FACE, 1-3 SECTION, 1-5 SECTION, BRACKET MOUNTED | EACH | 3        |
| TRAFFIC SIGNAL BACKPLATE, LOUVERED, ALUMINUM                        | EACH | 3        |
| PEDESTRIAN PUSH-BUTTON, NON-LATCHING                                | EACH | 4        |
| REMOVE EXISTING TRAFFIC SIGNAL EQUIPMENT                            | EACH | 1        |

**STATE OF ILLINOIS  
 DEPARTMENT OF TRANSPORTATION**

**SCHEDULE OF QUANTITIES, CABLE PLAN,  
 PHASE DESIGNATION DIAGRAM AND EMERGENCY VEHICLE PREEMPTION  
 U.S. ROUTE 34 (OGDEN AVENUE) AT EBERLY AVENUE / EAST AVENUE**

SCALE: N.T.S. SHEET NO. OF SHEETS STA. TO STA.

**EBERLY AVENUE**

**EAST AVENUE**

**U.S. ROUTE 34  
 (OGDEN AVENUE)**

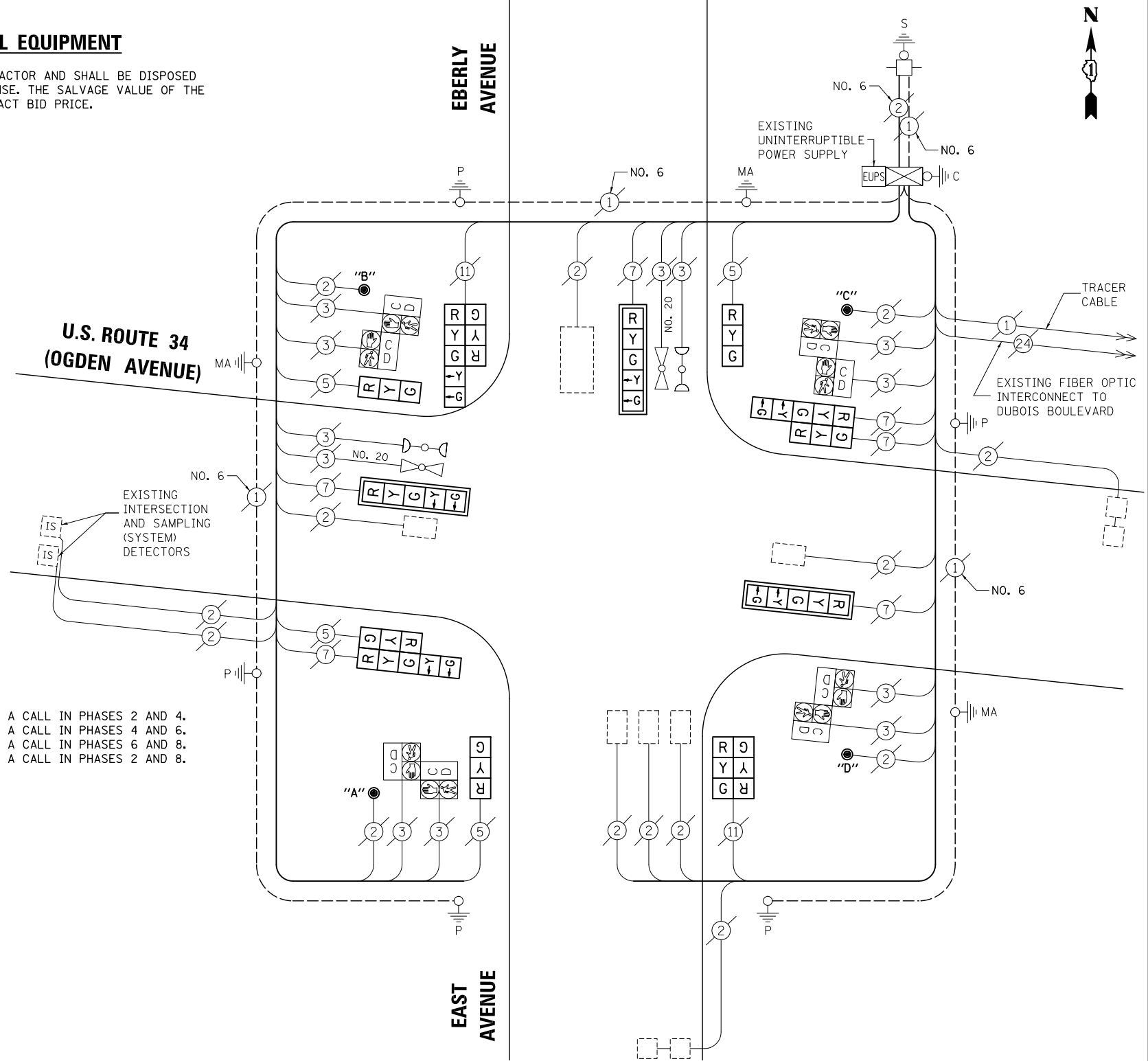

**CABLE PLAN**

**NOTE:**  
 THE TRAFFIC SIGNAL CONTROL EQUIPMENT FOR THIS PROJECT SHALL BE "EAGLE" TO MATCH THE EXISTING ADJACENT SYSTEM.

| I.D.O.T<br>TRAFFIC SIGNAL INSTALLATION<br>ELECTRICAL SERVICE REQUIREMENTS                                       |                 |                           |                 |            |               |
|---|-----------------|---------------------------|-----------------|------------|---------------|
| TYPE  | NO. LAMPS       | WATTAGE                   |                 | %OPERATION | TOTAL WATTAGE |
|   |                 | INCAND.                   | LED             |            |               |
| SIGNAL (RED)  | 14              | 135                       | 17              | 0.50       | 119           |
| (YELLOW)  | 14              | 135                       | 25              | 0.25       | 87.5          |
| (GREEN)   | 14              | 135                       | 15              | 0.25       | 52.5          |
| ARROW   | 12              | 135                       | 12              | 0.10       | 14.4          |
| PED. SIGNAL   | 8               | 90                        | 25              | 1.00       | 200           |
| CONTROLLER  | 1               | 100                       | 100             | 1.00       | 100           |
| ILLUM. SIGN   |                 | 84                        | 100             | 0.50       |               |
| FLASHER   |                 | 135                       | 25              | 0.50       |               |
| ENERGY COSTS TO:<br>ILLINOIS DEPARTMENT OF TRANSPORTATION<br>201 WEST CENTER COURT<br>SCHAUMBURG, IL 60196-1096 |                 |                           |                 |            | TOTAL = 573.4 |
| ENERGY SUPPLY   | CONTACT: X      |                           |                 |            |               |
|   | PHONE: X        |                           |                 |            |               |
|   | COMPANY: X      |                           |                 |            |               |
| FILE NAME =<br>\MICROST\352108\<br>31-13870.DGN   | USER NAME = JGC | DESIGNED - BPT            | REVISED -       |            |               |
|   |                 | DRAWN - JGC/RDS           | REVISED -       |            |               |
|   |                 | PLOT SCALE = NOT TO SCALE | CHECKED - BPT   | REVISED -  |               |
|   |                 | PLOT DATE = X             | DATE - 12-04-13 | REVISED -  |               |

PREPARED BY:  
**CEMCON, Ltd.**  
 Consulting Engineers, Land Surveyors & Planners  
 2280 White Oak Circle, Suite 100  
 Aurora, Illinois 60504-9675  
 Ph: 630.862.2100 Fax: 630.862.2199  
 E-Mail: cadd@cemcon.com Website: www.cemcon.com

|   |            |        |              |           |
|---|------------|--------|--------------|-----------|
| F.A.P. RTE.                                   | SECTION    | COUNTY | TOTAL SHEETS | SHEET NO. |
| VAR.  | 2013-054TS | COOK   | 92           | 45        |
| CONTRACT NO. 60X29                            |            |        |              |           |
| FED. ROAD DIST. NO. ILLINOIS FED. AID PROJECT |            |        |              |           |

TS# 13870  
 BROOKFIELD