

RESTORATION OF WORK AREA
 RESTORATION OF THE TRAFFIC SIGNAL WORK AREA SHALL BE INCIDENTAL TO THE RELATED PAY ITEM SUCH AS FOUNDATION, CONDUIT, HANDHOLE, TRENCH AND BACKFILL, ETC., AND NO EXTRA COMPENSATION SHALL BE ALLOWED. ALL ROADWAY SURFACES SUCH AS SHOULDERS, MEDIANS, SIDEWALKS, PAVEMENT, ETC. SHALL BE PLACED IN KIND. ALL DAMAGE TO MOWED LAWNS SHALL BE REPLACED WITH AN APPROVED SOD, AND ALL DAMAGE TO UNMOWED FIELDS SHALL BE SEED IN ACCORDANCE WITH STANDARD SPECIFICATIONS 252 AND 250 RESPECTIVELY.

NOTE:
 THE TRAFFIC SIGNAL CONTROLLER EQUIPMENT FOR THIS PROJECT SHALL BE "ECONOLITE" TO MATCH THE EXISTING ADJACENT SYSTEM.

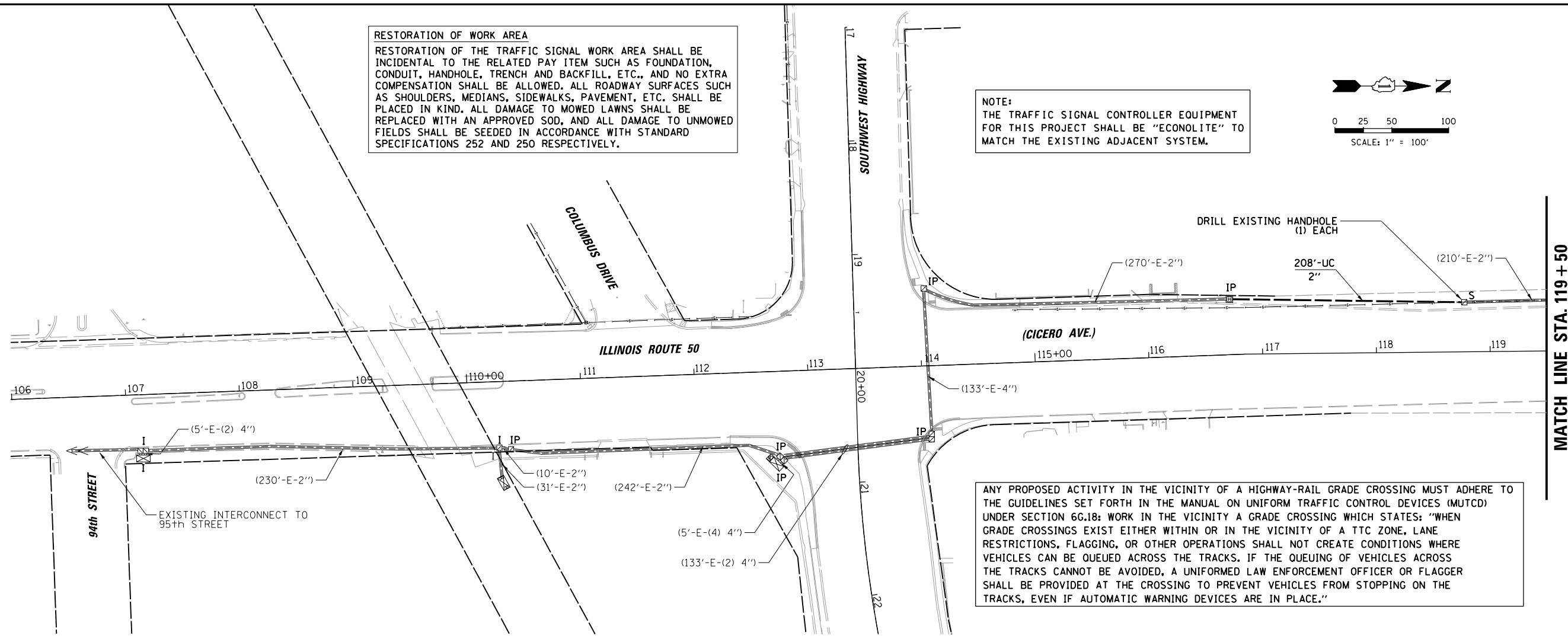

ANY PROPOSED ACTIVITY IN THE VICINITY OF A HIGHWAY-RAIL GRADE CROSSING MUST ADHERE TO THE GUIDELINES SET FORTH IN THE MANUAL ON UNIFORM TRAFFIC CONTROL DEVICES (MUTCD) UNDER SECTION 6G.18; WORK IN THE VICINITY A GRADE CROSSING WHICH STATES: "WHEN GRADE CROSSINGS EXIST EITHER WITHIN OR IN THE VICINITY OF A TTC ZONE, LANE RESTRICTIONS, FLAGGING, OR OTHER OPERATIONS SHALL NOT CREATE CONDITIONS WHERE VEHICLES CAN BE QUEUED ACROSS THE TRACKS. IF THE QUEUING OF VEHICLES ACROSS THE TRACKS CANNOT BE AVOIDED, A UNIFORMED LAW ENFORCEMENT OFFICER OR FLAGGER SHALL BE PROVIDED AT THE CROSSING TO PREVENT VEHICLES FROM STOPPING ON THE TRACKS, EVEN IF AUTOMATIC WARNING DEVICES ARE IN PLACE."

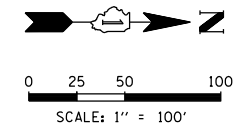
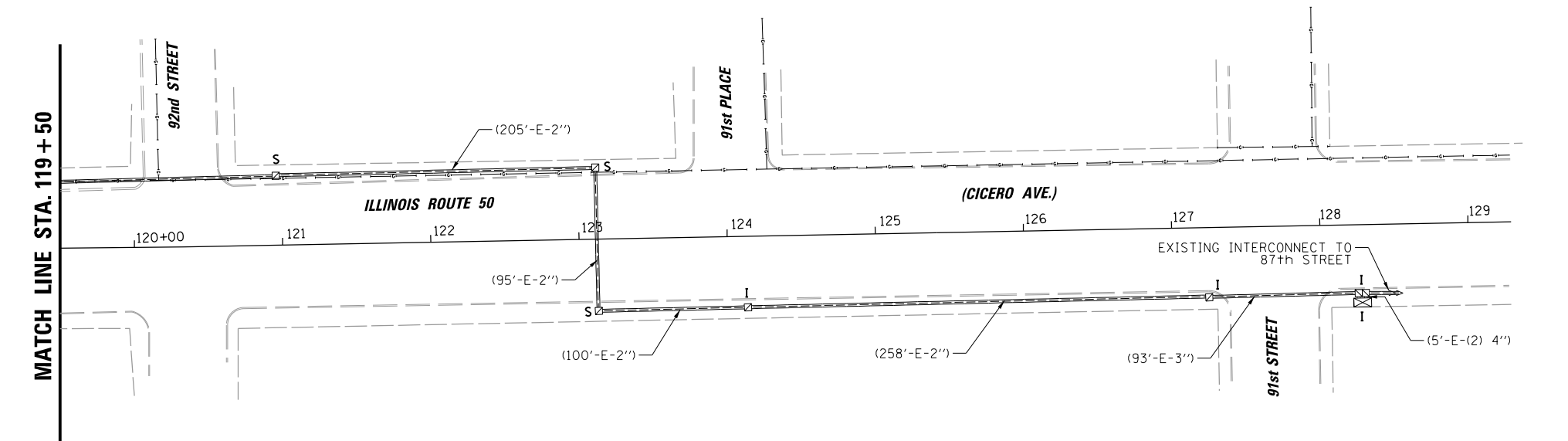

PROFILE	SURVEYED	DATE
	GRADES CHECKED	
PLAN	NOTE BOOK	BY
	NO.	
SURVEYED ALIGNMENT CHECKED RT. OF WAY CHECKED SADDY FILE NAME		
CHRISTOPHER B. BURKE ENGINEERING LTD. 9575 West Higgins Road, Suite 600 Rosemont, Illinois 60018 (647) 923-5930		
PROFILE	SURVEYED	DATE
	GRADES CHECKED	
PLAN	NOTE BOOK	BY
	NO.	
SURVEYED ALIGNMENT CHECKED RT. OF WAY CHECKED SADDY FILE NAME		
CHRISTOPHER B. BURKE ENGINEERING LTD. 9575 West Higgins Road, Suite 600 Rosemont, Illinois 60018 (647) 923-5930		

FILE NAME =	USER NAME = ejensen	DESIGNED - LJ	REVISED -	STATE OF ILLINOIS DEPARTMENT OF TRANSPORTATION	INTERCONNECT PLAN IL ROUTE 50 (CICERO AVENUE) FROM 94th STREET TO 91st STREET	F.A.P. RTE.	SECTION	COUNTY	TOTAL SHEETS	SHEET NO.	
N:\Idot\130116\Work Order 13018 - IL585W	W:\Traffic\INT_IL50-Swhy.sht	DRAWN - FPB / FCP	REVISED -			350	461TS-2(13)	COOK	42	30	
	PLOT SCALE = 100'	CHECKED - GMZ	REVISED -			CONTRACT NO. 60X25					
	PLOT DATE = 12/11/2013	DATE -	REVISED -			FED. ROAD DIST. NO. ILLINOIS FED. AID PROJECT					
SCALE:		SHEET NO. OF SHEETS STA. TO STA.									