

- KEY NOTES:
1. PLATFORM CANOPY ABOVE.
 2. PLATFORM EDGE.
 3. EXISTING STATION COLUMN TO REMAIN.
 4. EXISTING PLATFORM CANOPY COLUMN TO REMAIN, TYP.
 5. NEW PLATFORM CANOPY COLUMN.
 6. BENCH FROM EXISTING GLASS HOUSE.
 7. RELOCATE EXISTING CANE RAIL PREP & PAINT.
 8. RELOCATE EXISTING WEST STAIR STEEL STRINGERS AND GLASS TUBE STEEL FRAME. PREP / PAINT ALL STEEL. REUSE EXISTING CAST IRON TREADS.
 9. EXISTING CANE RAIL, PREP & PAINT.
 10. EXISTING EAST STAIR STRINGERS, TUBESTEEL GLASS FRAME, PREP & PAINT REUSE EXISTING CAST IRON TREADS. INSTALL NEW GLAZING AND GLAZING STOPS AFTER REMOVAL OF TEMPORARY BRIDGE SHORING. SEE STRUCTURAL DRAWINGS.
 11. NEW CONCRETE PLATFORM INFILL SLAB SEE STRUCTURAL DRAWINGS.
 12. STATION HOUSE ABOVE.
 13. NEW COLUMN SEE STRUCTURAL DRAWINGS.
 14. NEW ALUMINUM PLATFORM CANOPY (ABOVE).

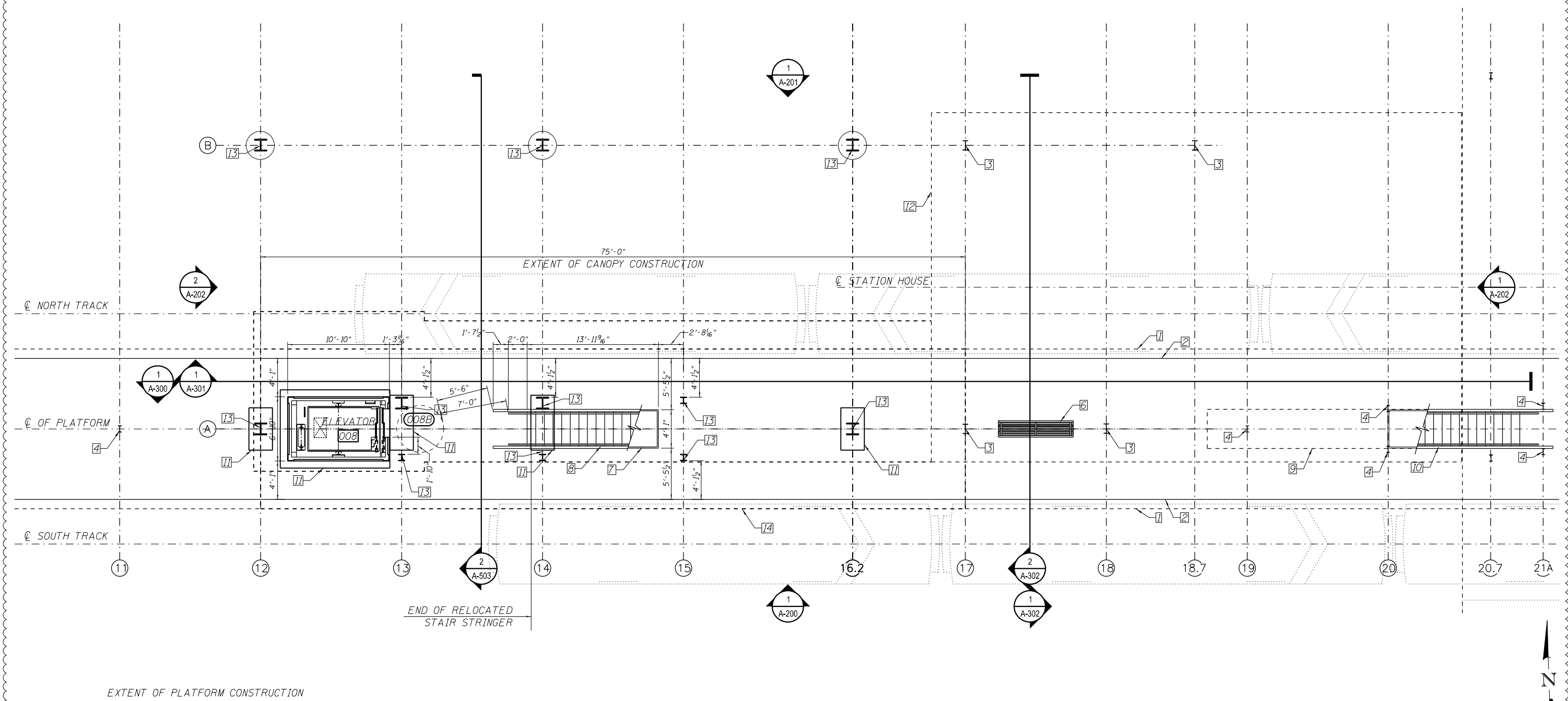

1 PLATFORM FLOOR PLAN
SCALE: 3/16" = 1'-0"



4:31:31 PM 01/17/08-60W29-A-101.dgn



| | | |
|----------------------------------|----------------|---------------------|
| USER NAME = whbruce | DESIGNED - WHB | REVISED - 1/20/2014 |
| | CHECKED - CRR | REVISED - |
| PLOT SCALE = 10:8.0012 '4" / 16" | DRAWN - WHB | REVISED - |
| PLOT DATE = 1/20/2014 | CHECKED - CRR | REVISED - |

STATE OF ILLINOIS
DEPARTMENT OF TRANSPORTATION

PEORIA STREET STATION
PARTIAL PLATFORM FLOOR PLAN

SHEET NO. A-101 OF 117 SHEETS

| | | | | |
|--|-----------|--------|--------------|-----------|
| MUN | SECTION | COUNTY | TOTAL SHEETS | SHEET NO. |
| 2090 | 2013-011R | COOK | 356 | 230 |
| CONTRACT NO. 60W29 | | | | |
| ILLINOIS FED. AID PROJECT FED. AID PROJECT | | | | |