

10:31:32 AM
0161708-60W29-5019-Deck_PnlDet4.dgn

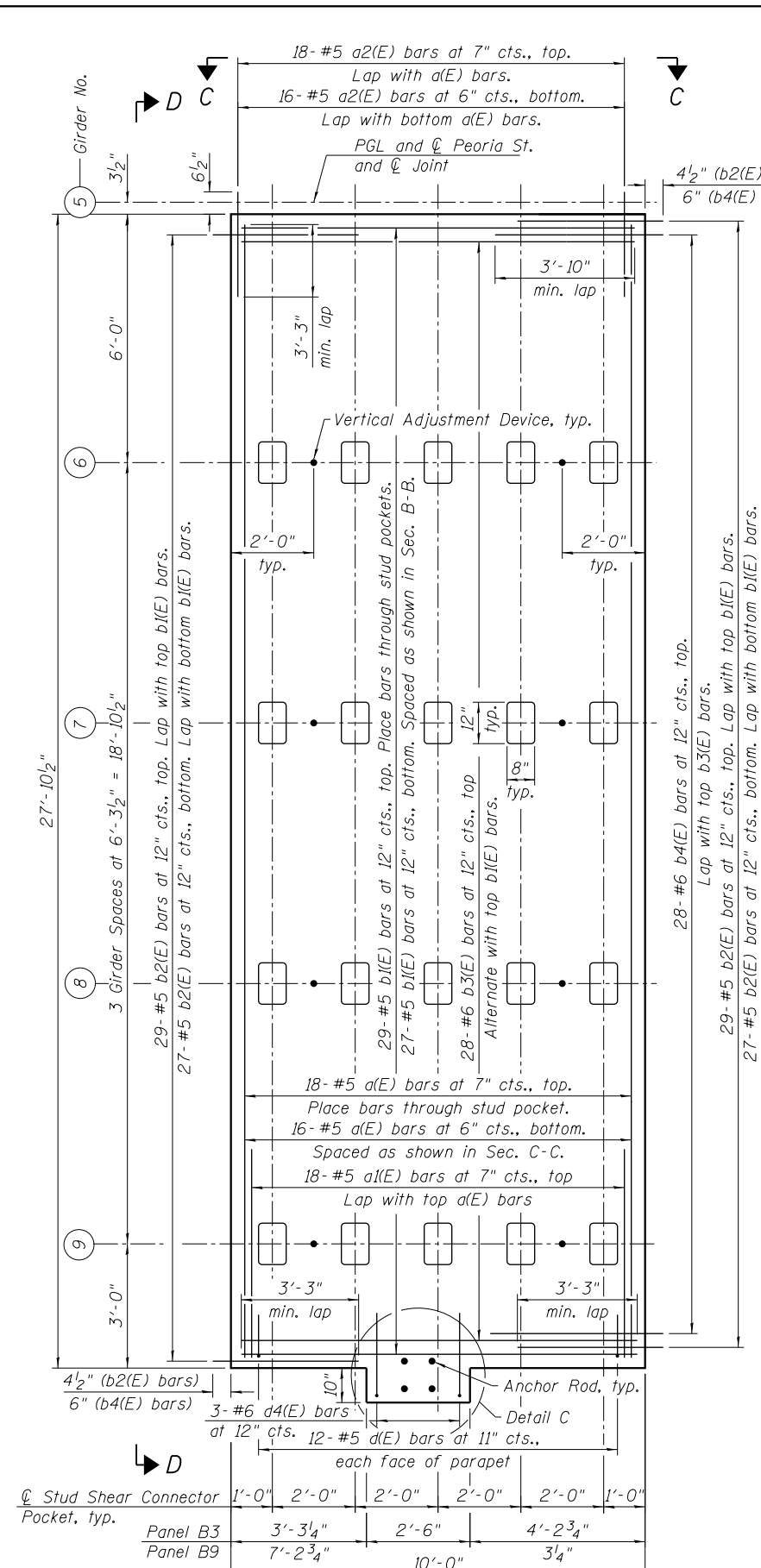

REINFORCING PLAN - DECK PANEL B3

(1 required)
Deck Panel B9 opposite hand (1 required)

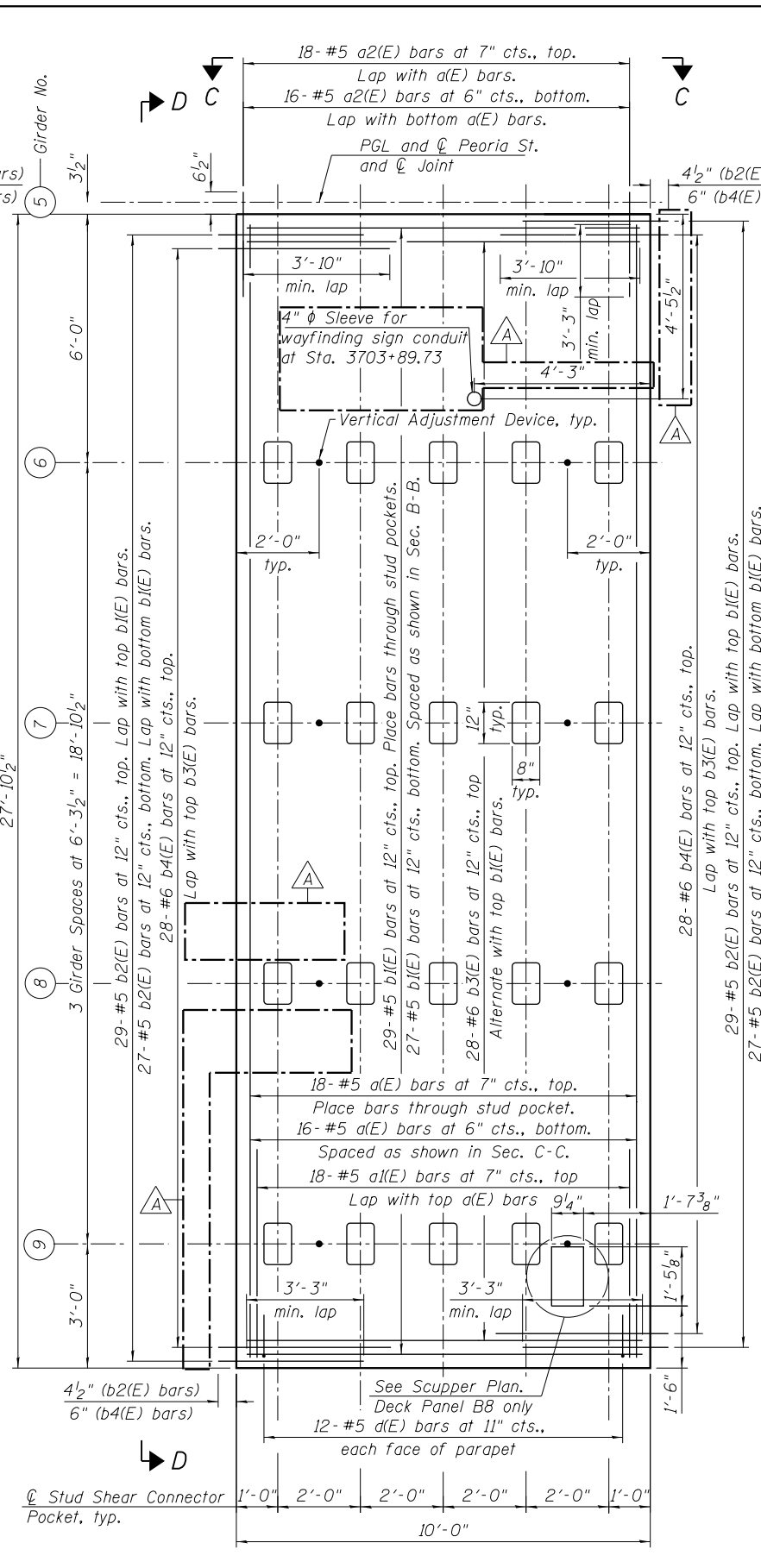

REINFORCING PLAN - DECK PANELS B4 AND B8

(8 required)

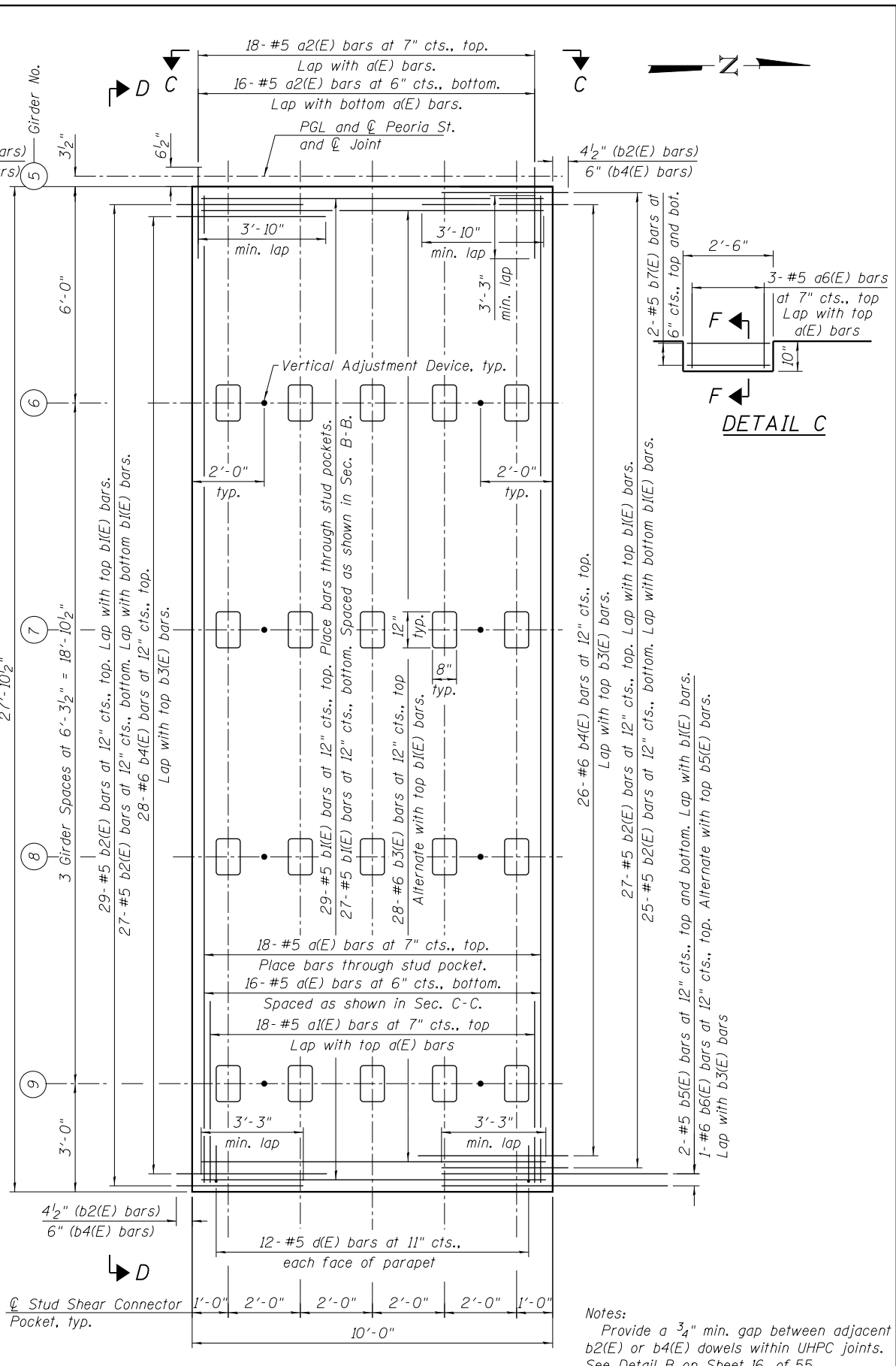

REINFORCING PLAN - DECK PANEL B5

(1 required)
Deck Panel B7 opposite hand (1 required)

Notes:
Provide a 3/4\" min. gap between adjacent b2(E) or b4(E) dowels within UHPC joints. See Detail B on Sheet 16 of 55.
For Sections C-C and D-D see Sheet 20 of 55.
For Scupper Plan, see Sheet 18 of 55.
For Section F-F, see Sheet 21 of 55.



USER NAME = BAWIort	DESIGNED JRM	REVISED A 12/18/2013 JRM
PLOT SCALE = 4:0.0000 '1' / in.	CHECKED WJC	REVISED
PLOT DATE = 12/19/2013	DRAWN RLS	REVISED
	CHECKED DL	REVISED

**STATE OF ILLINOIS
DEPARTMENT OF TRANSPORTATION**

**PRECAST DECK PANEL DETAILS 4
STRUCTURE NO. 016-1708**

SHEET NO. 19 OF 55 SHEETS

MUN	SECTION	COUNTY	TOTAL SHEETS	SHEET NO.
2090	2013-011R	COOK	356	151
CONTRACT NO.			60W29	
ILLINOIS FED. AID PROJECT				