

GENERAL NOTES:

- Fasteners shall be ASTM A325 Type 1, hot dip galvanized bolts. Bolts $\frac{7}{8}$ in. ϕ , holes $\frac{15}{16}$ in. ϕ , unless otherwise noted (See special provision for Hot Dip Galvanizing for Structural Steel).
- Calculated weight of Structural Steel = $\frac{475,950}{1}$ pounds (AASHTO M270 Grade 50).
Calculated weight of Structural Steel = $\frac{42,720}{1}$ pounds (AASHTO M270 Grade 36).
- All structural steel shall be hot dip galvanized. Cost included in Furnishing and Erecting Structural Steel. See special provisions for Hot Dipped Galvanizing for Structural Steel.
- Girders have bearing stiffeners and connection plates as required design. Additional stiffeners may be added at the Contractor's expense as necessary to prevent distortion of the girders during galvanizing. The Contractor shall coordinate with the fabricator and the galvanizer to determine if additional stiffeners are necessary, and where these should be placed. Any proposed changes shall be submitted to the Engineer for approval prior to making any changes.
- Temporary stiffener angles shall be bolted to each side of the splice ends of each girder segment to prevent distortion during galvanizing. Temporary stiffener angles shall bolt or fit tight against the top and bottom flanges and shall include spacer tubes to minimize damage to galvanizing during removal. Cost included with "Furnishing and Erecting Structural Steel".
- No field welding is permitted except as specified in the contract documents.
- Reinforcement bars designated (E) shall be epoxy coated.
- Plan dimensions and details relative to existing plans are subject to nominal construction variations. The Contractor shall field verify existing dimensions and details affecting new construction and make necessary approved adjustments prior to construction or ordering of materials. Such variations shall not be cause for additional compensation for a change in scope of the work, however, the Contractor will be paid for the quantity actually furnished at the unit price bid for the work.
- Bearing seat surfaces shall be constructed or adjusted to the designated elevations within a tolerance of $\frac{1}{8}$ inch (0.01 ft.). Adjustment shall be made either by grinding the surface or by shimming the bearings.
- Concrete Sealer shall be applied to the designated areas of the Piers, Abutments and Wingwalls.
- For Conduit Attached to Structure quantities and details, see Electrical Plans.
- The contractor shall exercise extreme caution during construction to make certain that construction activities, live load surcharge and other loads applied to the structures will not have detrimental effects on the adjacent building foundations. Driving piles and temporary sheet piling is not allowed.
- For light pole support system, see Electrical Plans.
- Abandoned 5' diameter CTA Water Tunnel shall be filled prior to the start of drilled shaft construction in a previous contract. The Contractor shall verify with the Engineer that the tunnel has been filled prior to the start of drilled shaft construction. A number of the drilled shaft foundations will be placed through this tunnel. Drilling operations must account for the presence of debris, brick material, CLSM and bedding material in addition to soil and other expected materials to be encountered.
- The existing structural steel coating contains lead. The Contractor shall take appropriate precautions to deal with the presence of lead on this project.
- Slipforming of parapets is not allowed.
- Cast-in-place deck except parapets is not allowed.
- For drilled shaft locations where permanent casing is required as shown on the plans, the casing will be paid for under the Permanent Casing pay item. If contractor elects to use permanent casing for ease of construction in locations where permanent casing is not required on the plans the casing will not be paid for separately and is included in the Drilled Shaft in Soil pay item.
- Post-tensioning for precast deck panel is not allowed.

INDEX OF SHEETS

- General Plan and Elevation
- General Data 1
- General Data 2
- Foundation Layout
- Temporary Soil Retention Details 1
- Temporary Soil Retention Details 2
- Existing Structure Removal Details 1
- Existing Structure Removal Details 2
- Existing Structure Removal Details 3
- Top of Slab Elevations 1
- Top of Slab Elevations 2
- Top of Slab Elevations 3
- Top of Approach Slab Elevations
- Bridge Deck Overlay
- Precast Deck Panel Plan and Cross Section
- Precast Deck Panel Details 1
- Precast Deck Panel Details 2
- Precast Deck Panel Details 3
- Precast Deck Panel Details 4
- Precast Deck Panel Details 5
- Parapet Elevations and Details
- Superstructure Details 1
- Superstructure Details 2
- Bridge Approach Slab Details 1
- Bridge Approach Slab Details 2
- Decorative Railing Parapet Mounted
- Parapet Architectural Treatment
- Bridge Fence Railing (Special) Elevations
- Bridge Fence Railing (Special)
- Bridge Drainage System
- Drainage Scupper, DS-II
- Framing Plan
- Structural Steel Details 1
- Structural Steel Details 2
- Structural Steel Details 3
- Abutment Bearing Details
- Pier Bearing Details
- South Abutment Plan and Elevation
- South Abutment Details 1
- South Abutment Details 2
- North Abutment Plan and Elevation
- North Abutment Details 1
- North Abutment Details 2
- Pier 1 Plan and Elevation
- Pier 1 Details
- Pier 1 Architectural Details
- Pier 2 Plan and Elevation
- Pier 2 Details
- Pier 2 Architectural Details
- ComEd Bridge Deck Cross Section
- Conduit Support Hanger Detail and Bill of Materials
- Conduit Support and Conduit Layout
- AT&T Conduit Hangers Precast Deck Panel Layout
- AT&T Conduit Hangers Precast Deck Cross Section
- AT&T Conduit Hangers Section and Details
- AT&T Conduit Hangers Precast Panel Details
- Boring Logs 1
- Boring Logs 2
- Boring Logs 3

STATION 3703+94.18
BUILT 20-- BY
STATE OF ILLINOIS
M.U.N. 2090 SEC. 2013-011R
LOADING HL-93
STR. NO. 016-1708

NAME PLATE

See Std. 515001

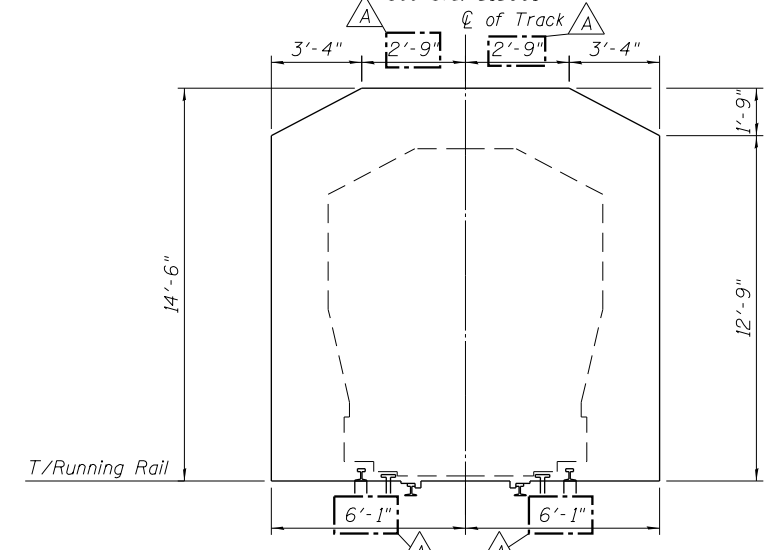

MINIMUM CTA CONSTRUCTION CLEARANCES

TOTAL BILL OF MATERIAL

Item	Unit	Super	Sub	Total
Removal of Existing Structures	Each			1
Protective Shield	Sq. Yd.	1394		1394
Structure Excavation	Cu. Yd.		3293	3293
Concrete Structures	Cu. Yd.		1031.2	1031.2
Rubbed Finish	Sq. Ft.	1945	2120	4065
Concrete Superstructure	Cu. Yd.	209.3		209.3
Form Liner Textured Surface	Sq. Ft.		1020	1020
Protective Coat	Sq. Yd.	395		395
Furnishing and Erecting Structural Steel	L. Sum		1	1
Stud Shear Connectors	Each	6,806		6,806
Reinforcement Bars	Pound		292,640	292,640
Reinforcement Bars, Epoxy Coated	Pound	18,270	148,620	166,890
Name Plates	Each		1	1
Permanent Casing	Foot		1554	1554
Drilled Shaft in Soil	Cu. Yd.		1318.9	1318.9
Drilled Shaft in Rock	Cu. Yd.		38.2	38.2
Elastomeric Bearing Assembly, Type I	Each	18		18
Elastomeric Bearing Assembly, Type II	Each	9		9
Anchor Bolts, 1 1/4"	Each	18		18
Anchor Bolts, 1 1/4"	Each	36		36
Concrete Sealer	Sq. Ft.		8,122	8,122
Geocomposite Wall Drain	Sq. Yd.		498	498
Chain Link Fence, 4'	Foot		5	5
Pile Extraction	Each		77	77
Decorative Railing (Parapet Mounted)	Foot	496		496
Crosshole Sonic Logging	Each		4	4
Foundation Removal	Each		8	8
Bridge Fence Railing (Special)	Foot	129		129
Granular Backfill for Structures	Cu. Yd.		647	647
Bridge Deck Latex Concrete Overlay, 2 1/4 Inches	Sq. Yd.	1614		1,614
Welded Wire Fabric 6x6	Sq. Yd.	66		66
Drainage Scuppers, DS-II	Each	2		2
Drainage System	L. Sum	1		1
Pipe Underdrains for Structures 4"	Foot		267	267
Temporary Soil Retention System	Sq. Ft.		9,532	9,532
Soil Retention System	Sq. Ft.		104	104
Precast Concrete Deck Panels	Sq. Ft.	15,272		15,272

4:59:40 PM 0161708-60W29-5002-GenNote-1.dgn



USER NAME = wjcollett1	DESIGNED KAH	REVISED 12/18/2013 JRM/KAH
CHECKED MDS	REVISOR	
PLOT SCALE = 0x2.0000 '1' / 1in.	DRAWN RLS	REVISOR
PLOT DATE = 1/10/2014	CHECKED MDS	REVISOR

**STATE OF ILLINOIS
DEPARTMENT OF TRANSPORTATION**

**GENERAL DATA 1
STRUCTURE NO. 016-1708**

SHEET NO. 2 OF 55 SHEETS

MUN 2090	SECTION 2013-011R	COUNTY COOK	TOTAL SHEETS 356	SHEET NO. 134
CONTRACT NO. 60W29			ILLINOIS FED. AID PROJECT	