

FILE PATH = p:\388935-par\1\escom\1\local\p\wec\000\Documents\01_Americas\Transportation\60269938_Circle\Phase_1\1\000_CAD\005_Roadway_Sheets\60W29_Sht_Scoring_01.dgn

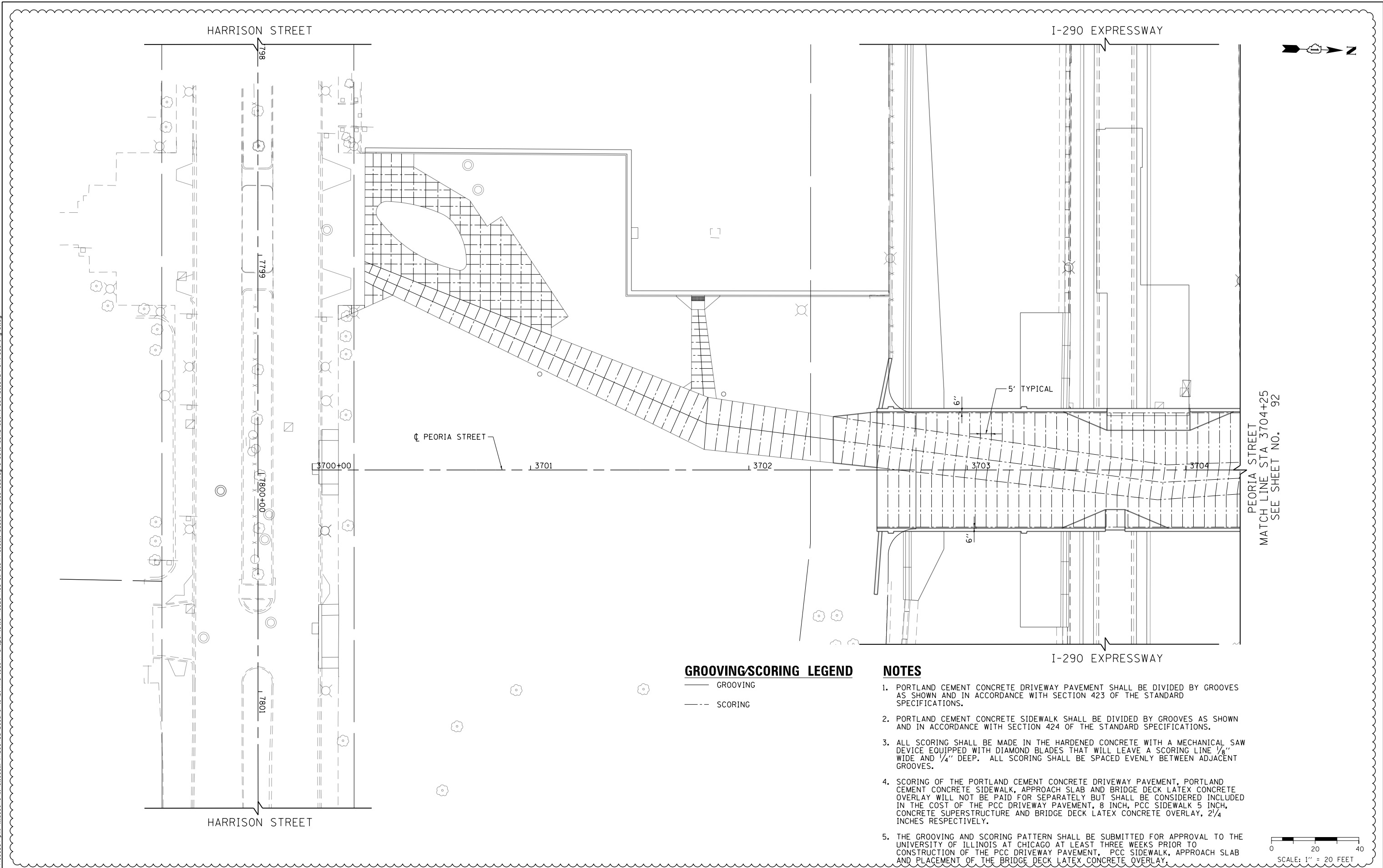

GROOVING/SCORING LEGEND
 — GROOVING
 - - - SCORING

NOTES

1. PORTLAND CEMENT CONCRETE DRIVEWAY PAVEMENT SHALL BE DIVIDED BY GROOVES AS SHOWN AND IN ACCORDANCE WITH SECTION 423 OF THE STANDARD SPECIFICATIONS.
2. PORTLAND CEMENT CONCRETE SIDEWALK SHALL BE DIVIDED BY GROOVES AS SHOWN AND IN ACCORDANCE WITH SECTION 424 OF THE STANDARD SPECIFICATIONS.
3. ALL SCORING SHALL BE MADE IN THE HARDENED CONCRETE WITH A MECHANICAL SAW DEVICE EQUIPPED WITH DIAMOND BLADES THAT WILL LEAVE A SCORING LINE 1/8" WIDE AND 1/4" DEEP. ALL SCORING SHALL BE SPACED EVENLY BETWEEN ADJACENT GROOVES.
4. SCORING OF THE PORTLAND CEMENT CONCRETE DRIVEWAY PAVEMENT, PORTLAND CEMENT CONCRETE SIDEWALK, APPROACH SLAB AND BRIDGE DECK LATEX CONCRETE OVERLAY WILL NOT BE PAID FOR SEPARATELY BUT SHALL BE CONSIDERED INCLUDED IN THE COST OF THE PCC DRIVEWAY PAVEMENT, 8 INCH, PCC SIDEWALK 5 INCH, CONCRETE SUPERSTRUCTURE AND BRIDGE DECK LATEX CONCRETE OVERLAY, 2 1/4 INCHES RESPECTIVELY.
5. THE GROOVING AND SCORING PATTERN SHALL BE SUBMITTED FOR APPROVAL TO THE UNIVERSITY OF ILLINOIS AT CHICAGO AT LEAST THREE WEEKS PRIOR TO CONSTRUCTION OF THE PCC DRIVEWAY PAVEMENT, PCC SIDEWALK, APPROACH SLAB AND PLACEMENT OF THE BRIDGE DECK LATEX CONCRETE OVERLAY.

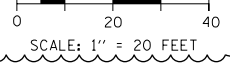

D:\60W29-Sht-Scoring-01.dgn	DESIGNED - JLV	REVISED - 12/18/2013
USER NAME = BAW:tor t	DRAWN - KAL	REVISED -
PLOT SCALE = 40.0000' / in.	CHECKED - JMG	REVISED -
PLOT DATE = 12/19/2013	DATE - 10/30/2013	REVISED -

**STATE OF ILLINOIS
DEPARTMENT OF TRANSPORTATION**

**ROADWAY DETAILS
PEORIA STREET SCORING PLAN**

SCALE: 1"=20' SHEET 1 OF 2 SHEETS STA. 3700+00 TO STA. 3704+25

F.A.I. RTE. 90/94/290	SECTION 2013-011R	COUNTY COOK	TOTAL SHEETS 356	SHEET NO. 91
CONTRACT NO. 60W29				ILLINOIS FED. AID PROJECT

PEORIA STREET
MATCH LINE STA 3704+25
SEE SHEET NO. 92