

FILE PATH = p:\388035-projects\transportation\60269938 - Roadway\Sheets\60W29_Sht-Intersec-04.dgn

| | STATION | OFFSET | LT/RT | ELEVATION | TOP OF CURB / GROUND ELEVATION BEHIND WALL (IF APPLICABLE) |
|----|------------|--------|-------|-----------|--|
| CA | 3706+20.00 | 5.00' | LT | 594.53 | N/A |
| CB | 3706+20.00 | 13.00' | LT | 594.41 | 594.66 |
| CC | 3706+20.00 | 19.58' | LT | 593.37 | 594.12 |
| CD | 3706+20.00 | 32.97' | LT | 593.36 * | N/A |
| CE | 3706+28.90 | 5.00' | LT | 594.21 | N/A |
| CF | 3706+28.90 | 13.00' | LT | 594.09 | 594.34 |
| CG | 3706+28.90 | 19.58' | LT | 593.39 | 594.16 |
| CH | 3706+33.90 | 13.00' | LT | 593.84 | 594.09 |
| CI | 3706+32.90 | 19.58' | LT | 593.39 | 594.14 |
| CJ | 3706+34.90 | 21.58' | LT | 593.40 | 594.15 |
| CK | 3706+34.90 | 24.96' | LT | 593.35 | 594.1 |
| CL | 3706+38.90 | 5.00' | LT | 593.93 | N/A |
| CM | 3706+38.90 | 18.00' | LT | 593.46 | 594.02 |
| CN | 3706+38.90 | 23.00' | LT | 593.28 | 594.03 |
| CO | 3706+38.90 | 24.96' | LT | 593.29 | 594.04 |
| CP | 3706+38.90 | 32.96' | LT | 593.34 * | N/A |
| CQ | 3706+44.06 | 23.00' | LT | 593.28 * | N/A |
| CR | 3706+06.00 | 24.58' | LT | 593.23 | 593.98 |
| CS | 3706+08.00 | 22.58' | LT | 593.28 | 594.03 |
| CT | 3706+50.39 | 32.96' | LT | 593.33 * | N/A |
| CU | 3706+50.67 | 5.00' | LT | 593.67 | N/A |
| CV | 3706+50.67 | 26.96' | LT | 593.30 | N/A |
| CW | 3706+55.30 | 26.96' | LT | 593.28 | N/A |
| CX | 3706+55.30 | 32.96' | LT | 593.31 | N/A |
| CY | 3706+58.94 | 13.00' | LT | 593.45 | N/A |
| CZ | 3706+60.68 | 6.31' | LT | 593.55 | N/A |
| DA | 3706+59.30 | 32.96' | LT | 593.37 * | N/A |
| DB | 3706+60.53 | 26.96' | LT | 593.27 | N/A |
| DC | 3706+08.00 | 21.58' | LT | 593.30 | 594.05 |
| DD | 3706+62.18 | 5.84' | LT | 593.28 | 593.53 |
| DE | 3706+64.36 | 10.27' | LT | 593.23 | 593.40 |
| DF | 3706+72.10 | 32.96' | LT | 593.45 * | N/A |
| DG | 3706+73.32 | 26.96' | LT | 593.21 | N/A |
| DH | 3706+75.20 | 17.93' | LT | 593.08 | 593.24 |
| DI | 3706+79.75 | 18.50' | LT | 593.03 | 593.28 |
| DJ | 3706+79.75 | 20.08' | LT | 593.28 | N/A |
| DK | 3706+79.75 | 26.96' | LT | 593.28 | N/A |
| DL | 3706+79.75 | 32.96' | LT | 593.32 * | N/A |
| DM | 3706+10.00 | 19.58' | LT | 593.35 | 594.10 |
| DN | 3706+90.99 | 18.50' | LT | 592.90 | 593.23 |
| DO | 3706+90.99 | 32.96' | LT | 593.28 * | N/A |

• MATCH EXISTING

| CURB TRANSITION | | | |
|-----------------|-------------|----------|-------------|
| FROM POINT | CURB HEIGHT | TO POINT | CURB HEIGHT |
| CH | 3" | CN | 9" |
| AN | 2" | DD | 3" |
| DD | 3" | DE | 2" |
| DH | 2" | DI | 3" |
| DI | 3" | DM | 4" |

• MATCH EXISTING

NOTES

- SEE NOTE 35 ON THE GENERAL NOTES SHEET FOR INFORMATION REGARDING REMOVAL, STORAGE, AND RELOCATION OF BIKE RACKS.
- STATIONS, OFFSETS, AND ELEVATIONS ON PEORIA STREET ARE GIVEN ALONG THE FLOW LINE.

LEGEND

■ PCC SIDEWALK, 5 INCH SAND CUSHION, 4 INCH, (CDOT)

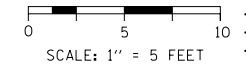
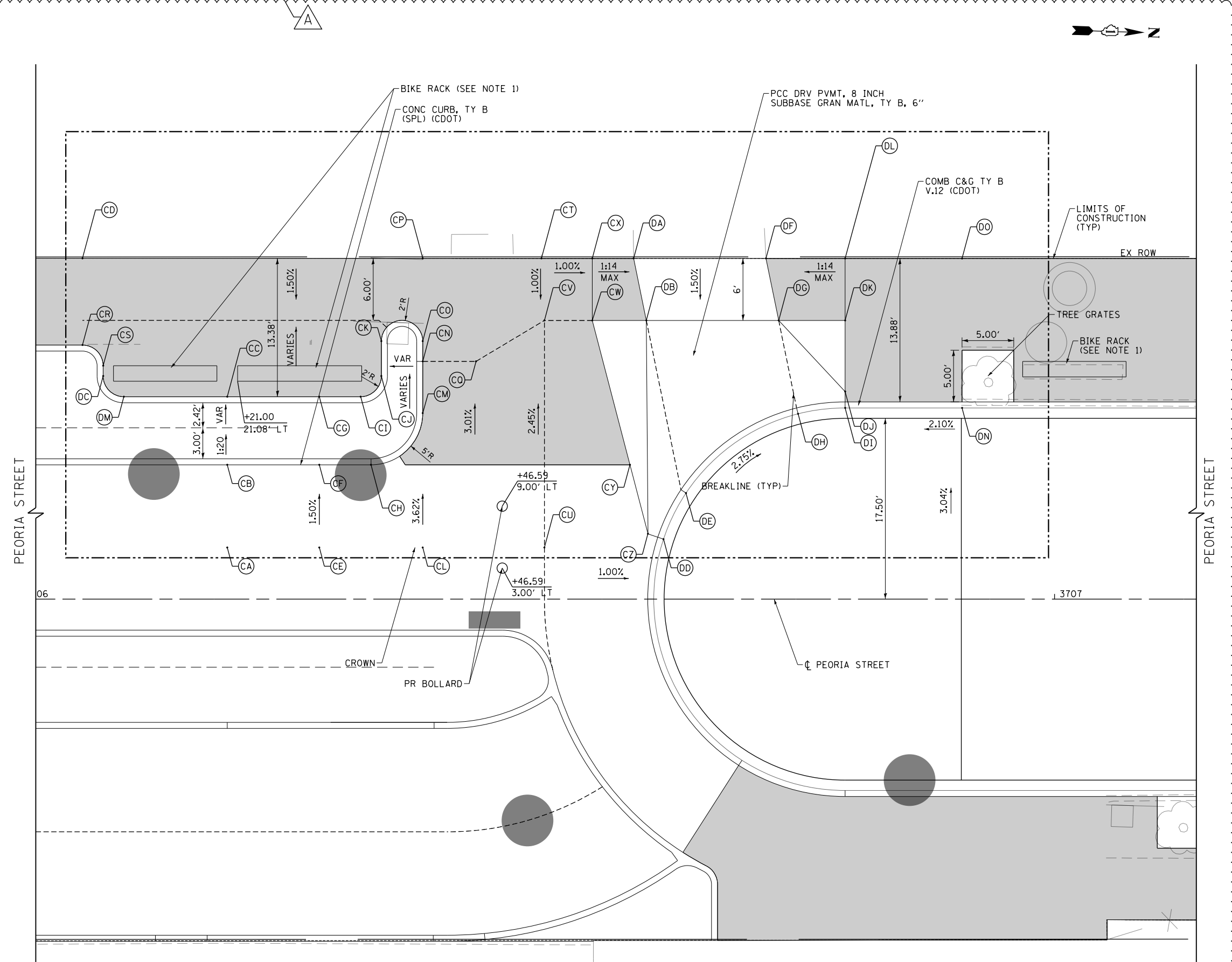

| | | |
|------------------------------|-------------------|----------------------|
| D:\60W29-Sht-Intersec-04.dgn | DESIGNED - JLV | REVISED - 12/18/2013 |
| USER NAME = BAW\jlv | DRAWN - KAL | REVISED - |
| PLOT SCALE = 10.0000' / 1" | CHECKED - JMG | REVISED - |
| PLOT DATE = 12/19/2013 | DATE - 10/30/2013 | REVISED - |

**STATE OF ILLINOIS
DEPARTMENT OF TRANSPORTATION**

**ROADWAY AND GRADING PLAN DETAILS
PEORIA STREET**

SCALE: 1"=5' SHEET 4 OF 5 SHEETS STA. 3705+93 TO STA. 3707+28

| | | | | |
|---------------------------|-----------|--------|--------------|-----------|
| F.A.I. R.E. | SECTION | COUNTY | TOTAL SHEETS | SHEET NO. |
| 90/94/290 | 2013-011R | COOK | 356 | 89 |
| CONTRACT NO. 60W29 | | | | |
| ILLINOIS FED. AID PROJECT | | | | |