

| | | | | |
|-------------|-----------|--------|--------------|-----------|
| PROJECT NO. | SECTION | COUNTY | TOTAL SHEETS | SHEET NO. |
| P.A. 181 | 2525.1-1B | COOK | 30 | 2 |

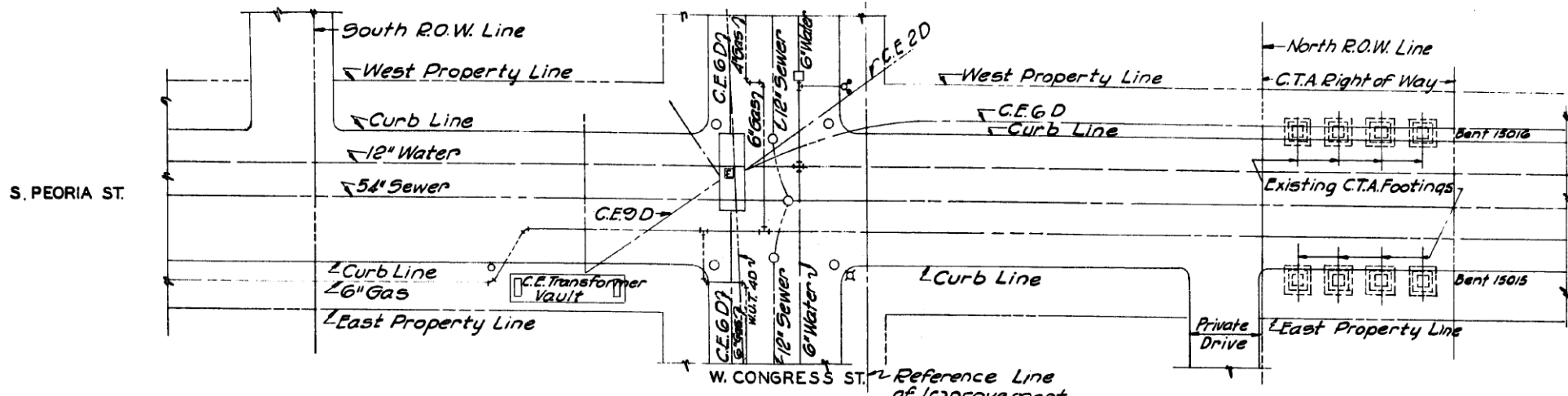

Notes:
 For General Plan of Sewer Siphon see Sheet 20
 For Plan of Bituminous Macadam Pavement and Sidewalk see Sheet 24
 For Excavation Pay Limits see Sheet 3

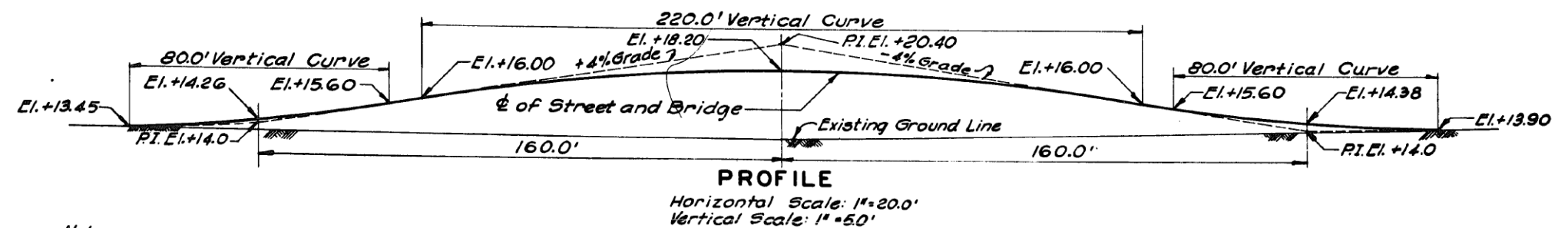
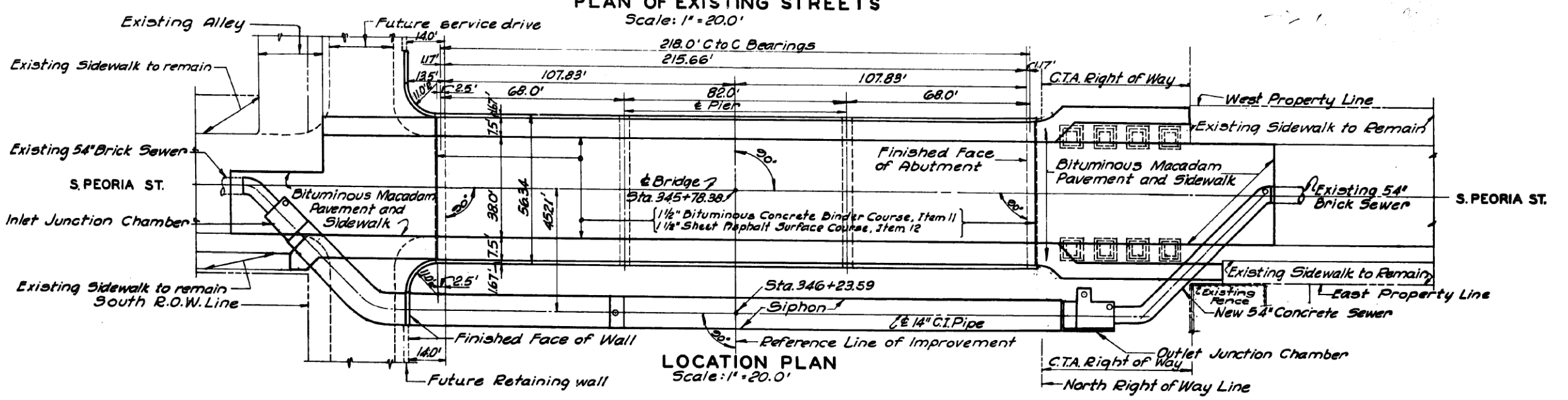

Notes:
 The location and sizes of the conduits, pipes, manholes, and other sub-surface utility equipment shown on this drawing are based on the best information obtainable and are believed to be accurate but cannot be guaranteed. Additional abandoned utilities may be encountered. For procedure in handling these abandoned utilities see Section 18 of Special Provisions (City of Chicago)

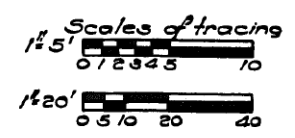

Drawn By E. Zullo
 Traced By E. Zullo
 Checked By Jan. J. [unclear]
 Approved [unclear]

CITY OF CHICAGO
 DEPARTMENT OF SUBWAYS AND SUPERHIGHWAYS
 WEST ROUTE SUPERHIGHWAY
 SECTION 2525.1-1B
 PEORIA STREET BRIDGE

LOCATION PLAN AND PROFILE
 SCALE: AS NOTED
 SEPTEMBER, 1949
 SHEET NO. 2 OF 30 SHEETS

FILE PATH = p:\388035\pmt\lsc\com\lme\local\p\w\ec\000\Documents\01_Americas\Transportation\60269938_Circle\Phase_1\1000_CAD\005_Roadway_Sheets\60W29_sht-Ex-Siphon-02.dgn



| | | | |
|------------------------------|-------------------|-----------|------------|
| D160W29-sht-Ex-Siphon-02.dgn | DESIGNED - | REVISED - | 12/18/2013 |
| USER NAME = BAW1tor1 | DRAWN - BAW | REVISED - | |
| PLOT SCALE = 100.0000' / in. | CHECKED - JWC | REVISED - | |
| PLOT DATE = 12/19/2013 | DATE - 10/30/2013 | REVISED - | |

STATE OF ILLINOIS
 DEPARTMENT OF TRANSPORTATION

AS BUILT SIPHON PLANS
 PEORIA STREET

SCALE: NONE SHEET 2 OF 14 SHEETS STA. TO STA.

| | | | | |
|---------------------------|-----------|--------|--------------|-----------|
| F.A.I. RTE. | SECTION | COUNTY | TOTAL SHEETS | SHEET NO. |
| 90/94/290 | 2013-011R | COOK | 356 | 76C |
| CONTRACT NO. 60W29 | | | | |
| ILLINOIS FED. AID PROJECT | | | | |