

- NOTES:
- ALL DIMENSIONS, ELEVATIONS AND PIPE SIZES SHOWN HAVE BEEN TAKEN FROM RECORD DRAWINGS TITLED (INCLUDED IN THE PLANS):

WEST ROUTE SUPER HIGHWAY
PLANS FOR PEORIA STREET BRIDGE
SECTION 2525.1B
F.A. ROUTE NO. 131 PROJECT UI261(29)
APPROVED JULY 1, 1949
 - CONTRACTOR SHALL VERIFY ALL DIMENSIONS, ELEVATIONS AND SIZES PRIOR TO CONSTRUCTION OR DEMOLITION AND REPORT DISCREPANCIES TO THE ENGINEER BEFORE PROCEEDING.
 - CONDITION OF THE EXISTING 54" BRICK COMBINED SEWER PIPE IS EXPECTED TO BE GOOD AND THE EXTERIOR SURFACE SUITABLE FOR APPLICATION OF AN ADHESIVE WATER STOP SYSTEM.
 - ALL NEW SIPHON PIPE SHALL BE DUCTILE IRON PIPE BELLED JOINT.
 - ALL FITTINGS SHALL BE DUCTILE IRON MECHANICAL JOINT FITTINGS.
 - DESIGN CODES:
A. AMERICAN CONCRETE INSTITUTE ACI-318
B. AASHTO
 - SEE SPECIAL PROVISION SIPHON RECONSTRUCTION FOR ADDITIONAL CONSTRUCTION REQUIREMENTS AND MATERIAL SPECIFICATIONS.
 - DESIGN STRENGTH OF CAST IN PLACE CONCRETE, F'C 4000 PSI
 - YIELD STRESS OF REINFORCEMENT STEEL, F_y 60,000 PSI
 - ALLOWABLE SOIL BEARING PRESSURE BASED ON THE SOILS REPORT PREPARED BY WANG ENGINEERING WEI #1100-04-01.

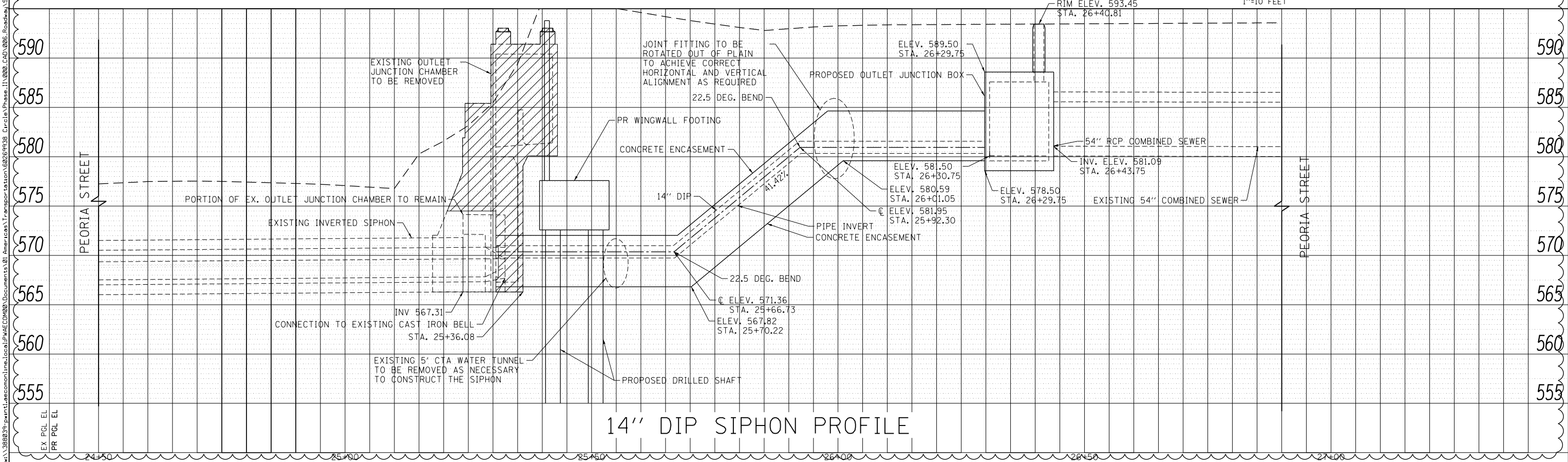

D:\160W29-sht-Siphon-02.dgn	DESIGNED - JEH	REVISED - A 01/20/2014
USER NAME = BAWitort	DRAWN - CWD	REVISED -
PLOT SCALE = 100.0000' / 1"	CHECKED - JWC	REVISED -
PLOT DATE = 1/21/2014	DATE - 10/30/2013	REVISED -

**STATE OF ILLINOIS
DEPARTMENT OF TRANSPORTATION**

SCALE: NONE		SIPHON PROFILES	
SCALE: SHEET 3 OF 11 SHEETS		PEORIA STREET	
STA.	TO STA.	CONTRACT NO. 60W29	SHEET NO. 72

F.A.I. RTE. 90/94/290	SECTION 2013-011R	COUNTY COOK	TOTAL SHEETS 356	SHEET NO. 72
ILLINOIS FED. AID PROJECT				

FILE PATH = p:\1388039-p\unit\loc\mon\line\local\FWECM000\Documents\01_Americas\Transportation\60W29\93B_Circle\Phase_11\000_CAD\006_Roadway\Sheet\60W29-sht-Siphon-02.dgn