

FILE PATH = p:\1\388035-par\1\ae\000\Documents\01_Americas\Transportation\60269938_Circle\Phase\1\000_CAD\005_Roadway_Sheets\60W29_Sht-4B-04.dgn

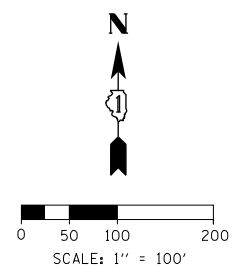

STATION EQUATIONS

POINT	CENTERLINE	STATION	BASELINE	STATION
Q	PR PEORIA ST	3699+75.1365	P-HAR-CL	7799+98.3673
S	PR PEORIA ST	3708+69.1690	P-TAY-ES	7300+01.0500
T	PR PEORIA ST	3703+06.4044	E-CIR-ES	100+78.6594
U	PR PEORIA ST	3703+17.7691	E-IKE-EB	345+80.1224
V	PR PEORIA ST	3704+56.8532	E-IKE-WB	345+73.5334
W	PR PEORIA ST	3704+64.0465	E-CIR-NW	28+76.8615
X	PR PEORIA ST	3707+88.8780	P-VAN-CL	8139+85.0728

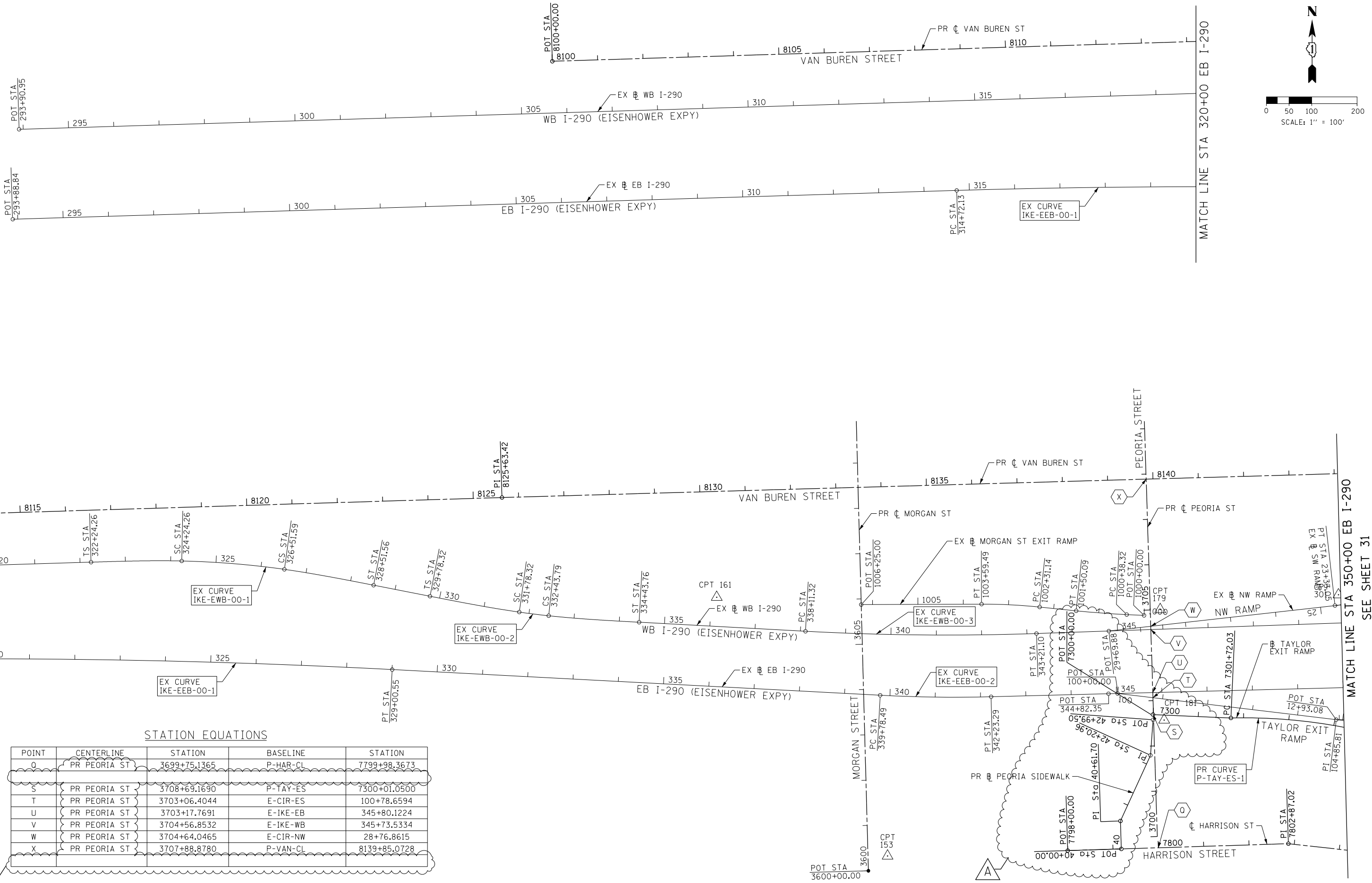

DI60W29-Sht-4B-04.dgn	DESIGNED - JLV	REVISED - A 12/18/2013
USER NAME = BAWtor t	DRAWN - BAW	REVISED -
PLOT SCALE = 200.0000' / in.	CHECKED - JMG	REVISED -
PLOT DATE = 12/19/2013	DATE - 10/30/2013	REVISED -

**STATE OF ILLINOIS
DEPARTMENT OF TRANSPORTATION**

ALIGNMENT, TIES AND BENCHMARKS	
SCALE: 1" = 100'	SHEET 4 OF 9 SHEETS STA. TO STA.

F.A.I. R.E. 90/94/290	SECTION 2013-01R	COUNTY COOK	TOTAL SHEETS 356	SHEET NO. 33
ILLINOIS FED. AID PROJECT			CONTRACT NO. 60W29	

SEE SHEET 31