



EXISTING BENCH TO BE REMOVED, AND REINSTALLED ON PLATFORM. LOCATION TO BE DETERMINED BY CTA.

EXISTING BENCH



EXISTING BIKE RACK TO BE REMOVED, MODIFIED AND REINSTALLED.

EXISTING BIKE RACK

- KEY NOTES:
1. REMOVE GLAZING AND GLAZING STOPS AND SCREWS.
  2. NOT USED.
  3. REMOVE EXISTING PLATFORM CANOPY DECKING TO NEAREST FULL PANEL ASSOCIATED STRUCTURE. DRAINAGE POWER, COMMUNICATIONS AND LIGHTING. COORDINATE WITH STRUCTURAL, PLUMBING, COMMUNICATION, AND ELECTRICAL DRAWINGS. REMOVE AND STORE FOR REINSTALLATION EXISTING LIGHTING FIXTURES.
  4. REMOVE GUARDRAILS AT WINDOW WALL AND STAIR IN THEIR ENTIRETY.
  5. EXISTING PLATFORM CANOPY STRUCTURE TO REMAIN.
  6. REMOVE EXISTING PEORIA STREET STATION WEST STAIR SALVAGE STRINGERS AND CAST IRON TREADS.
  7. EXISTING STEEL TUBE STRUCTURE TO REMAIN. REMOVE FASTENERS.
  8. REMOVE EXISTING MASONRY WALL AND METAL DOOR FRAMES IN THEIR ENTIRETY AT EAST FACADE.
  9. EXISTING PEORIA STREET STATION EAST STAIR STRINGERS AND GLASS FRAMES TO REMAIN. REMOVE AND STORE FOR REINSTALLATION EXISTING CAST IRON TREADS. REMOVE GLASS AND GLASS STOPS.
  10. EXISTING 3/2"x3/2" STEEL COLUMNS TO REMAIN.
  11. NEW BRIDGE. SEE BRIDGE STRUCTURAL DRAWINGS.
  12. REMOVE EXISTING CONCRETE FLOOR TOPPING ABOVE PRECAST CONCRETE PLANKS. SEE STATION FLOOR PLAN, AND STRUCTURAL DRAWINGS.
  13. REMOVE EXISTING CONTROL JOINT. VERIFY LOCATION.

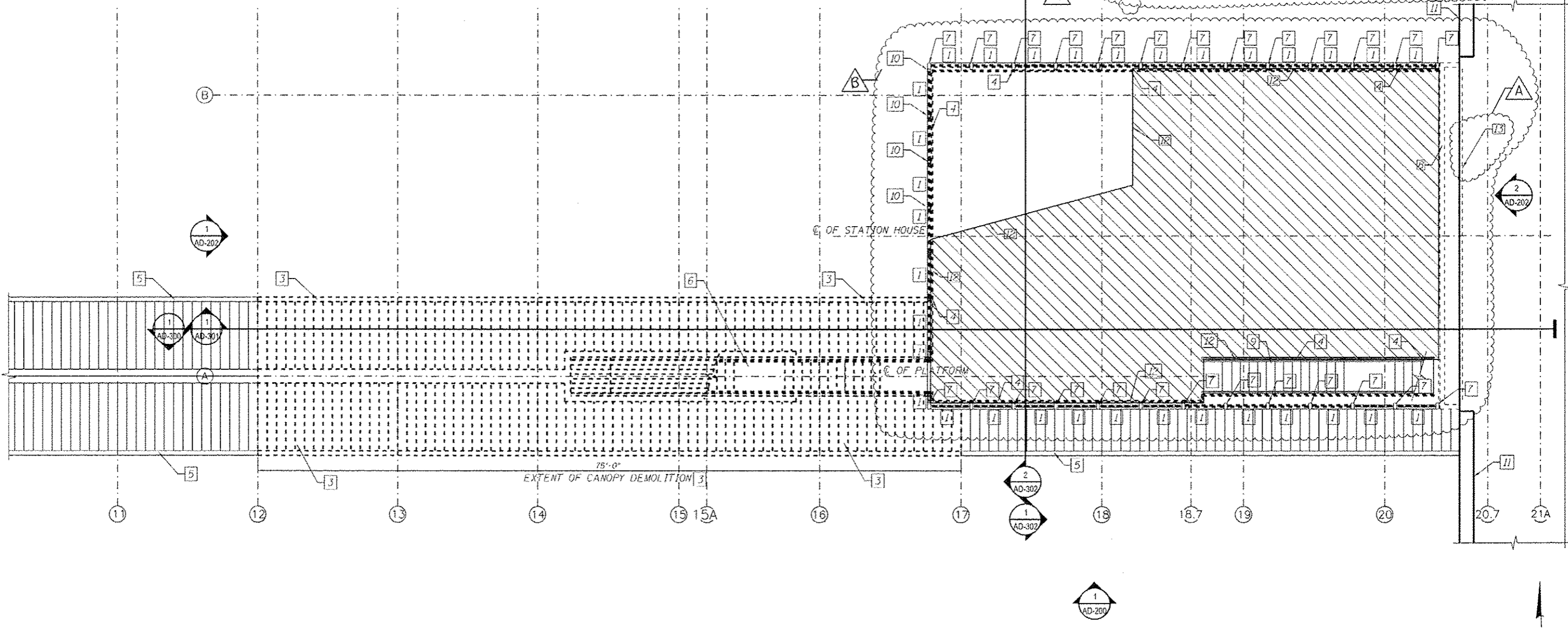

1 DEMOLITION STATION FLOOR PLAN  
SCALE: 3/16" = 1'-0"



5:05:35 PM 5/17/14 601708-ED-029-40-120.dgn

	USER NAME * whbruce	DESIGNED - WHB	REVISED - 12/18/2013
		CHECKED - CRR	REVISED - 2/18/2014
	PLOT SCALE * 5:4.0006 "1" / In.	DRAWN - WHB	REVISED
	PLOT DATE * 2/18/2014	CHECKED - CRR	REVISED

STATE OF ILLINOIS  
DEPARTMENT OF TRANSPORTATION

PEORIA STREET STATION  
DEMOLITION STATION FLOOR PLAN

SHEET NO. AD-120 OF 117 SHEETS

MUN	SECTION	COUNTY	TOTAL SHEETS	SHEET NO.
2090	2013-011R	COOK	356	217
CONTRACT NO. 60W29				

[ILLINOIS] FED. AID PROJECT / FED. AID PROJECT