

**LEGEND**

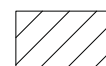

TEMPORARY PAVEMENT



CONSTRUCTION WORK ZONE

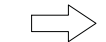

DIRECTION OF TRAFFIC FLOW



DRUM OR TYPE II BARRICADE WITH BI-DIRECTIONAL STEADY-BURN LIGHT IN 2-LANE SECTIONS  
MONO-DIRECTIONAL STEADY BURN LIGHT IN MULTI-LANE SECTIONS (TYP.)



TYPE II DIRECTION INDICATOR BARRICADE WITH MONO-DIRECTIONAL STEADY BURN LIGHT



DOUBLE VERTICAL PANEL WITH BI-DIRECTIONAL STEADY-BURN LIGHT



TYPE III BARRICADE WITH FLASHING LIGHTS



FLASHING ARROW BOARD

**NOTES:**

1. DRUMS OR TYPE II BARRICADES SHALL BE SPACED AT 50' C-C INTANGENTS, 20' C-C IN TAPERS, AND 10' C-C IN RADII.
2. SIGN W20-I103 MAY BE OMITTED IF IT IS WITHIN AN EXISTING WORK ZONE.
3. IMPACT ATTENUATORS SHALL BE PLACED AND INSTALLED PER MANUFACTURER'S SPECIFICATIONS.

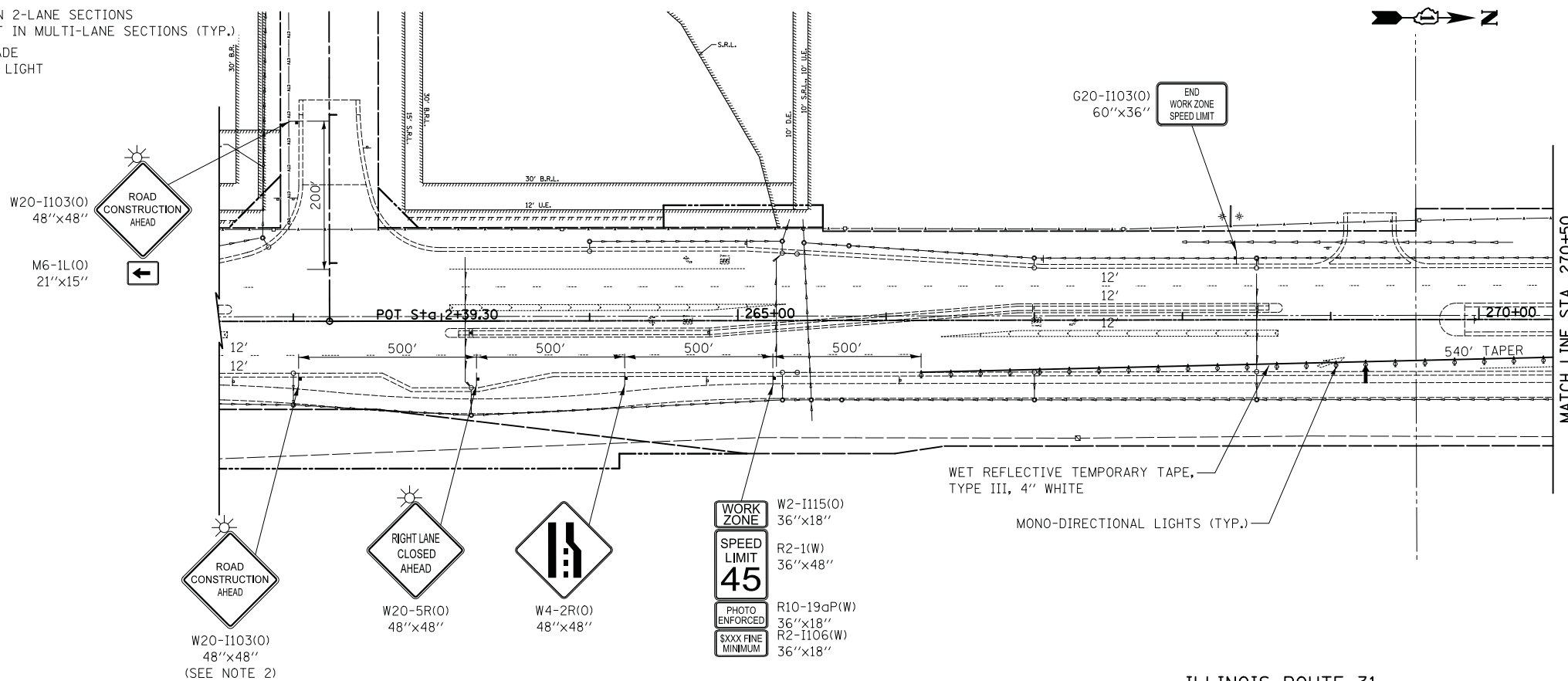

ILLINOIS ROUTE 31

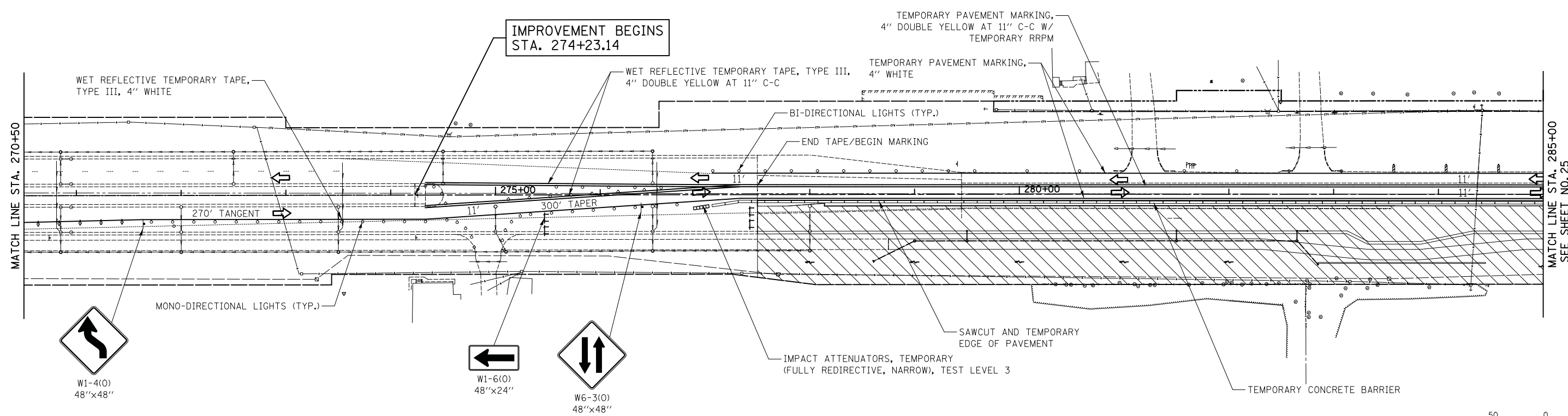

ILLINOIS ROUTE 31

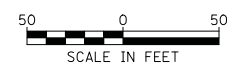

FILE NAME = ...\\06-MOT\2278NG_MOT_S1_01.dgn	USER NAME = kwh	DESIGNED - KWH	REVISED -	<b>STATE OF ILLINOIS DEPARTMENT OF TRANSPORTATION</b>	<b>MAINTENANCE OF TRAFFIC - STAGE 1A &amp; B</b>	F.A.P. RTE. 3887	SECTION 18W&RS-5 (12)	COUNTY MCHENRY	TOTAL SHEETS 151	SHEET NO. 24	
PLOT SCALE = 50.0000' / in.	CHECKED - GAB	DATE - 06/24/2013	REVISED -			SCALE: 1" = 50'	SHEET NO. 5 OF 13 SHEETS	STA. 274+23.14 TO STA. 285+00	CONTRACT NO. 60V72		
PLOT DATE = 9/6/2013	DATE - 06/24/2013	REVISED -						FED. ROAD DIST. NO. 1 ILLINOIS FED. AID PROJECT			