

BENCHMARKS

BM #	APPROXIMATE LOCATION	ELEVATION
3	RAILROAD SPIKE (SET) IN POWER POLE ON WEST SIDE OF ILLINOIS ROUTE 31 AS SHOWN HEREON.	887.92
4	BOX CUT (SET) IN CONCRETE BASE OF TRAFFIC SIGNAL WITH MAST ARM IN THE SOUTHWEST QUADRANT OF THE INTERSECTION OF ILLINOIS ROUTE 31 & JAMES R. RAKOW ROAD.	892.21

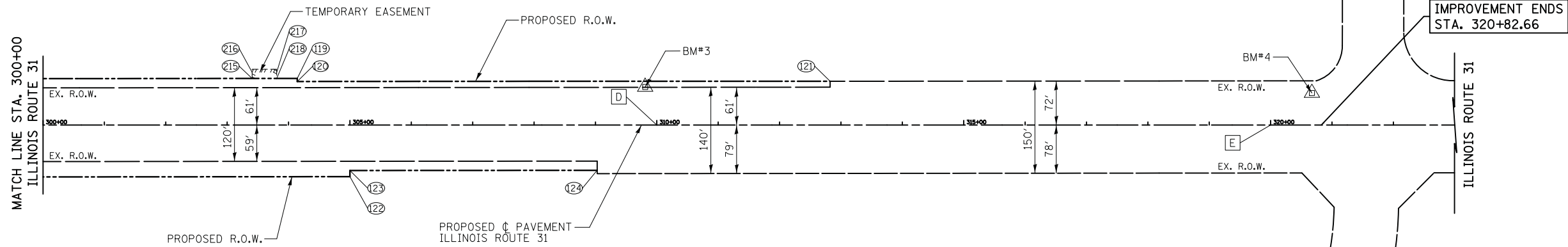
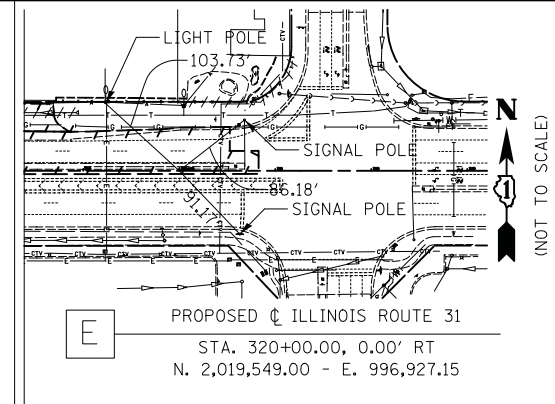
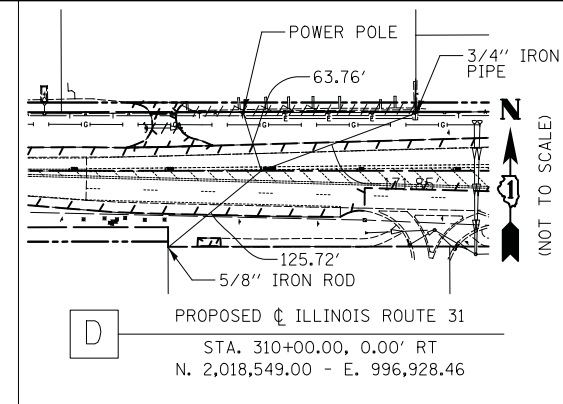

PROPOSED R.O.W. COORDINATE TABLE

POINT #	DESCRIPTION	STATION	OFFSET	NORTHING	EASTING
119	PROPOSED R. O. W.	304+14.17	75.91' LT	2,017,963.07	996,853.32
120	PROPOSED R. O. W.	304+14.19	70.91' LT	2,017,963.10	996,858.32
121	PROPOSED R. O. W.	312+82.35	71.25' LT	2,018,831.26	996,856.84
122	PROPOSED R. O. W.	305+00.00	84.02' RT	2,018,049.11	997,013.13
123	PROPOSED R. O. W.	305+00.00	74.02' RT	2,018,049.10	997,003.13
124	PROPOSED R. O. W.	309+02.84	73.67' RT	2,018,451.94	997,002.26

PROPOSED EASEMENTS COORDINATE TABLE

POINT #	DESCRIPTION	STATION	OFFSET	NORTHING	EASTING
215	TEMPORARY EASEMENT	303+40.61	75.85' LT	2,017,889.52	996,853.48
216	TEMPORARY EASEMENT	303+40.61	90.85' LT	2,017,889.50	996,838.48
217	TEMPORARY EASEMENT	303+80.61	90.88' LT	2,017,929.50	996,838.39
218	TEMPORARY EASEMENT	303+80.61	75.88' LT	2,017,929.52	996,838.39

LEGEND

- EXISTING R.O.W.
- PROPOSED R.O.W.
- PROPOSED PERMANENT EASEMENT
- PROPOSED TEMPORARY EASEMENT
- TIE POINT
- BENCHMARK

NOTE:

COORDINATES ARE BASED ON THE PUBLISHED METRIC COORDINATE VALUES AT FOUND GEODETIC SURVEY CONTROL MONUMENT "MCH31 1A", P.I.D. AJ2855, OF N.613,205.182-E.303,895.917. SURFACE COORDINATES ARE SHOWN IN U.S. SURVEY FEET. ELEVATIONS ARE ON NAVD 88 DATUM.



FILE NAME = ... \2278NG-sht-ATB-02.dgn

USER NAME = kwh

DESIGNED - KWH

REVISED -

DRAWN - AKW

REVISED -

PLOT SCALE = 100.0000' / 1in.

DATE = 06/24/2013

CHECKED - GAB

REVISED -

STATE OF ILLINOIS
DEPARTMENT OF TRANSPORTATION

ALIGNMENT TIES & BENCHMARKS

SCALE: 1" = 100'

SHEET NO. 2 OF 2 SHEETS

STA. 300+00 TO STA. 320+82.66

F.A.U. RTE.	SECTION	COUNTY	TOTAL SHEETS	SHEET NO.
3887	18W&RS-5 (12)	McHENRY	151	19
CONTRACT NO. 60V72			FED. ROAD DIST. NO. 1 ILLINOIS FED. AID PROJECT	