







ROUTE MARKERS

 FOR U.S. ROUTES
M1-40-2424

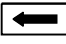

 FOR ILLINOIS ROUTES
M1-50-2424

 R.R., UNMARKED ROUTES
SPECIAL 24" x 18" VARIABLE
4" BLACK LETTERS ON WHITE
REFLECTIVE BACKGROUND

ARROWS SIGNS

-  M5-1L-2115
-  M5-1R-2115
-  M6-1-2115
-  M6-1-2115
-  M6-3-2115

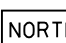
CARDINAL DIRECTION & DETOUR SIGNS

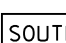
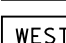
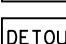
-  NORTH M3-1-2412
-  EAST M3-2-2412
-  SOUTH M3-3-2412
-  WEST M3-4-2412
-  DETOUR M4-8-2412

STATE ROUTE

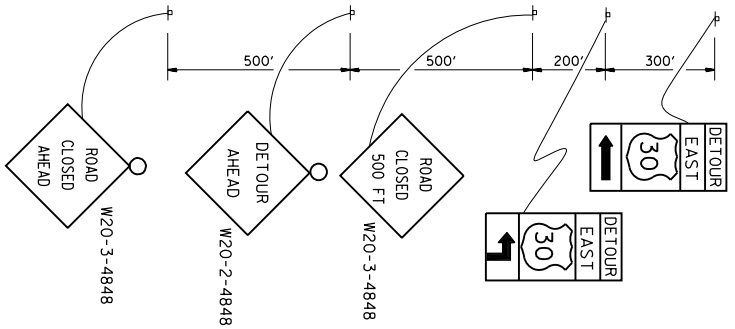

COMPLETELY CLOSED PORTION

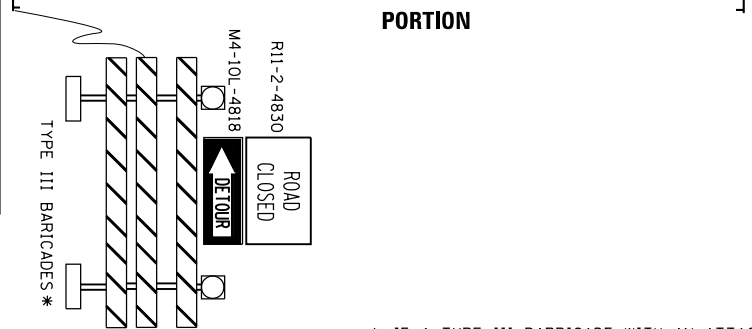

PARTIALLY CLOSED PORTION

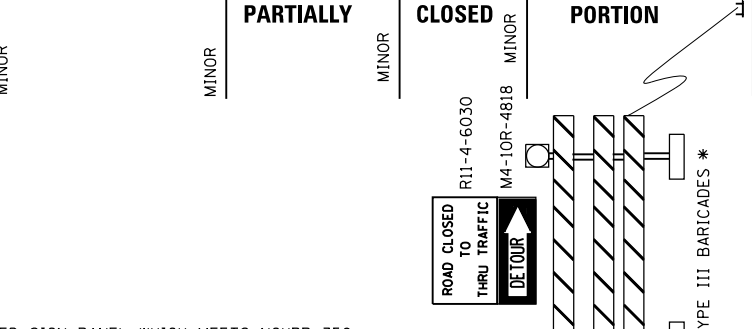

STATE ROUTE

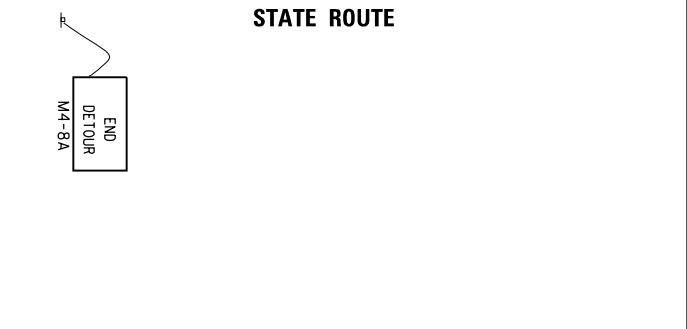

* IF A TYPE III BARRICADE WITH AN ATTACHED SIGN PANEL WHICH MEETS NCHRP 350 REQUIREMENTS IS NOT AVAILABLE, THE SIGNS SHALL BE MOUNTED, ABOVE THE BARRICADES, ON SEPARATE SIGNS SUPPORTS THAT MEET NCHRP 350 REQUIREMENTS.

FILE NAME =	USER NAME = Kjelc	DESIGNED -	REVISED - 10-18-02
M:\IL 132 over DesPlaines River\112-154-00\DRAWINGS\CADD Sheets\DISTRICT 1 STANDARD DRAWING\TC21.dgn		CHECKED -	REVISED - R. BORO 09-14-09
		DATE -	REVISED -
			REVISED -

**STATE OF ILLINOIS
DEPARTMENT OF TRANSPORTATION**

DETOUR SIGNING FOR CLOSING STATE HIGHWAYS			
SCALE: NONE	SHEET NO. 1 OF 1 SHEETS	STA.	TO STA.

F.A.P. RTE.	SECTION	COUNTY	TOTAL SHEETS	SHEET NO.
541	X-6-B-1-1	LAKE	93	76
TC-21		CONTRACT NO. 60N22		
FED. ROAD DIST. NO. 1 ILLINOIS FED. AID PROJECT				