

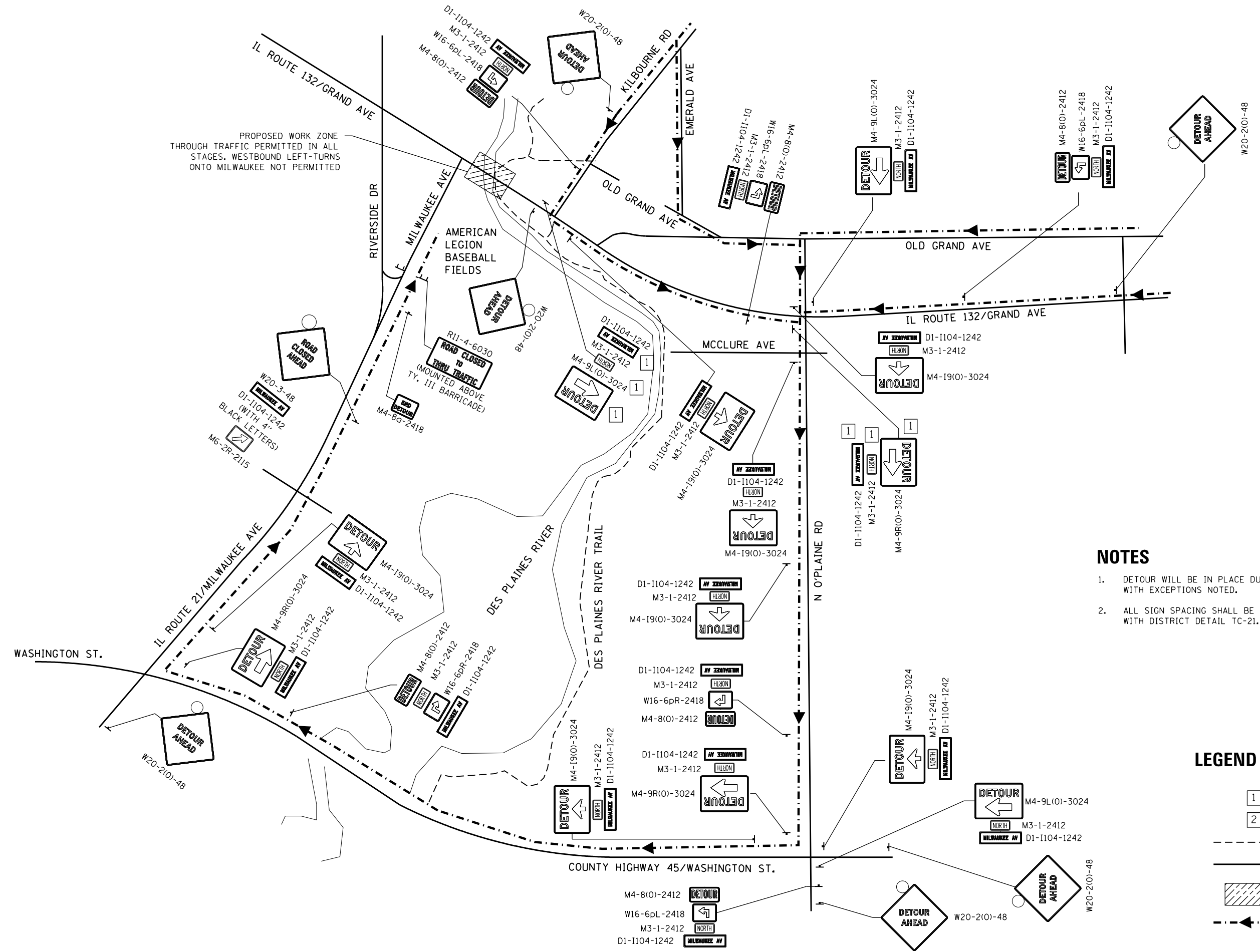

PROPOSED WORK ZONE
THROUGH TRAFFIC PERMITTED IN ALL
STAGES. WESTBOUND LEFT-TURNS
ONTO MILWAUKEE NOT PERMITTED



NOTES

1. DETOUR WILL BE IN PLACE DURING STAGE 1 AND STAGE 2, WITH EXCEPTIONS NOTED.
2. ALL SIGN SPACING SHALL BE IN ACCORDANCE WITH DISTRICT DETAIL TC-21.

LEGEND

- 1 STAGE 1 ONLY
- 2 STAGE 2 ONLY
- - - - - EXISTING TRAIL
- EXISTING ROADWAY
- PROPOSED WORK ZONE
- - - - -> DETOUR ROUTE

M:\IL_132_cover_DesPlaines_River\12-154-001\DRAWINGS\CADD_Sheets\1132-ht-staging02.dgn



USER NAME = JPS	DESIGNED - HTL	REVISED -
	DRAWN - HTL	REVISED -
PLOT SCALE =	CHECKED - DPA	REVISED -
PLOT DATE = 9/25/13	DATE - 09/25/13	REVISED -

**STATE OF ILLINOIS
DEPARTMENT OF TRANSPORTATION**

**IL 132 (GRAND AVE.) OVER DES PLAINES RIVER
MAINTENANCE OF TRAFFIC – MILWAUKEE AVE DETOUR**

SCALE: N/A SHEET NO. 2 OF 2 SHEETS STA. TO STA.

F.A.P. RTE. 541	SECTION X-6-B-1-1	COUNTY LAKE	TOTAL SHEETS 93	SHEET NO. 27
CONTRACT NO. 60N22				
ILLINOIS FED. AID PROJECT				