

*** IT IS ASSUMED THAT THE UNSUITABLE MATERIAL FROM THE I-57 MEDIAN AND OUTSIDE SHOULDERS WILL REMAIN ON-SITE AND BE USED FOR GRADING AND RESTORATION OPERATIONS AT THESE LOCATIONS.

DATE	
BY	
FINAL SURVEY	
FLATTED	
TEMPLATE	
NOTE BOOK	
AREAS	
CHECKED	

DATE	
BY	
ORIGINAL SURVEY	
FLATTED	
TEMPLATE	
NOTE BOOK	
AREAS	
CHECKED	

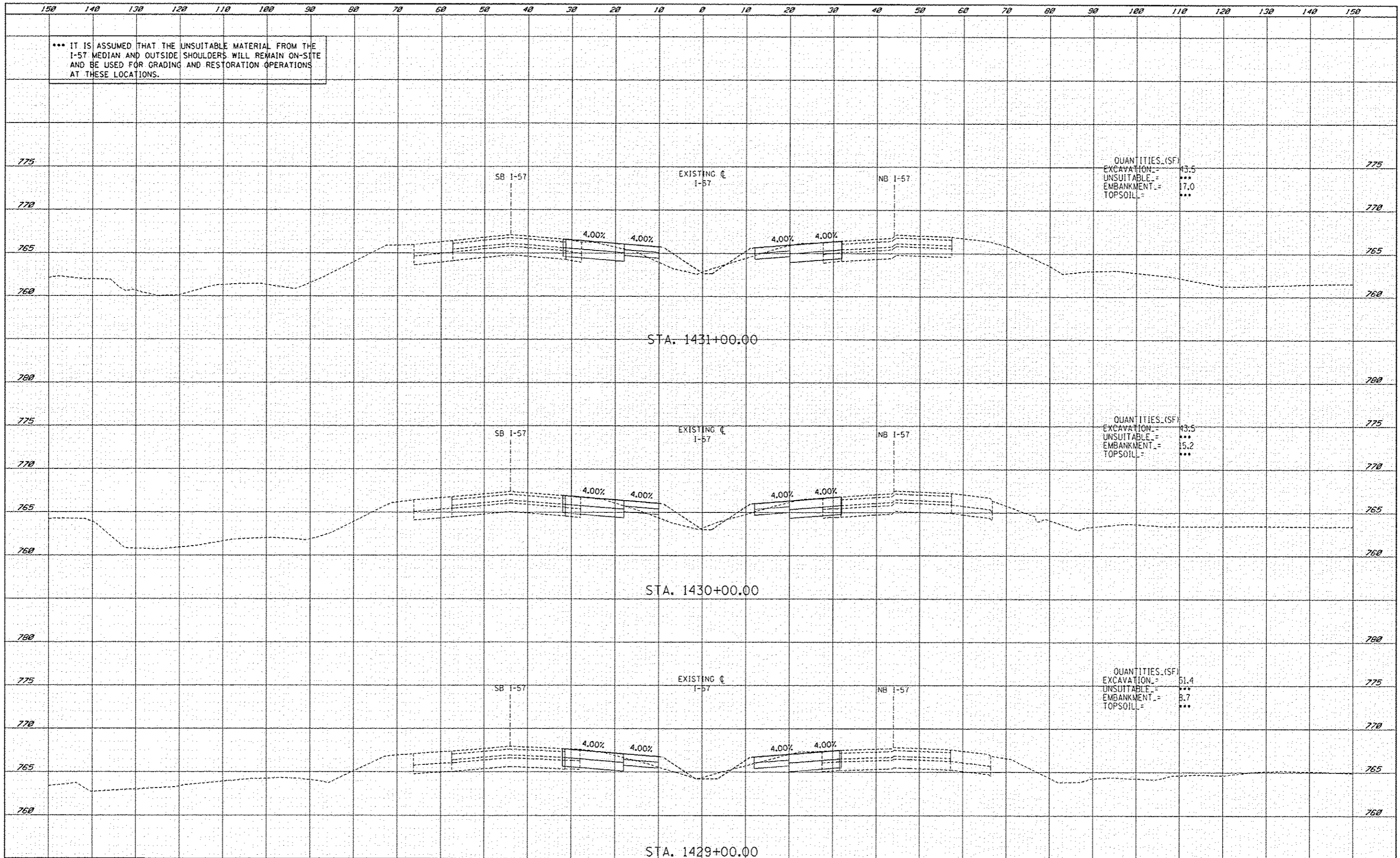

QUANTITIES (SF)
 EXCAVATION = 43.5
 UNSUITABLE = ***
 EMBANKMENT = 17.0
 TOPSOIL = ***

QUANTITIES (SF)
 EXCAVATION = 43.5
 UNSUITABLE = ***
 EMBANKMENT = 15.2
 TOPSOIL = ***

QUANTITIES (SF)
 EXCAVATION = 51.4
 UNSUITABLE = ***
 EMBANKMENT = 8.7
 TOPSOIL = ***

TYLIN INTERNATIONAL	USER NAME :	DESIGNED : JDF	REVISED Δ ADDENDUM 1 1/03/14	STATE OF ILLINOIS DEPARTMENT OF TRANSPORTATION	I-57 AT STUENKEL ROAD (NEW INTERCHANGE) I-57 MOT CROSS SECTIONS	F.A.I. RTE. :	SECTION :	COUNTY :	TOTAL SHEETS :	SHEET NO. :
	PLOT SCALE :	DRAWN : JDF	REVISED :			57	99-IHB-RI	WILL	679	613B
	PLOT DATE :	CHECKED : JPM	REVISED :			CONTRACT NO. 60L69				
	DATE : 5/10/2013	DATE :	REVISED :			SCALE: 1" = 10' H 1" = 5' V				
SHEET NO. OF SHEETS STA. 1429+00.00 TO STA. 1431+00.00						ILLINOIS FED. AID PROJECT				

P:\60261201-57_e_Stuenkel\Road\6_3\Interchange\NC3_57.XS.SHT.dgn

