

DESIGN	DATE	BY
DATE	BY	BY
DATE	BY	BY
DATE	BY	BY

TIME	DATE	BY
DATE	BY	BY
DATE	BY	BY
DATE	BY	BY

TYL INTERNATIONAL  
 DEPARTMENT OF TRANSPORTATION  
 I-57 AT STUBBINS ROAD (NEW INTERCHANGE)  
 PROPOSED RAMP B CROSS SECTIONS  
 SCALE: 1" = 10'-0" (VERTICAL) 1" = 40'-0" (HORIZONTAL)  
 SHEET NO. 1 OF 2  
 DATE: 10/20/2011  
 DRAWN: JPM  
 CHECKED: JPM  
 REVISIONS:  
 NO. 1: 10/20/2011  
 NO. 2: 10/20/2011  
 NO. 3: 10/20/2011  
 NO. 4: 10/20/2011  
 NO. 5: 10/20/2011  
 NO. 6: 10/20/2011  
 NO. 7: 10/20/2011  
 NO. 8: 10/20/2011  
 NO. 9: 10/20/2011  
 NO. 10: 10/20/2011  
 NO. 11: 10/20/2011  
 NO. 12: 10/20/2011  
 NO. 13: 10/20/2011  
 NO. 14: 10/20/2011  
 NO. 15: 10/20/2011  
 NO. 16: 10/20/2011  
 NO. 17: 10/20/2011  
 NO. 18: 10/20/2011  
 NO. 19: 10/20/2011  
 NO. 20: 10/20/2011  
 NO. 21: 10/20/2011  
 NO. 22: 10/20/2011  
 NO. 23: 10/20/2011  
 NO. 24: 10/20/2011  
 NO. 25: 10/20/2011  
 NO. 26: 10/20/2011  
 NO. 27: 10/20/2011  
 NO. 28: 10/20/2011  
 NO. 29: 10/20/2011  
 NO. 30: 10/20/2011  
 NO. 31: 10/20/2011  
 NO. 32: 10/20/2011  
 NO. 33: 10/20/2011  
 NO. 34: 10/20/2011  
 NO. 35: 10/20/2011  
 NO. 36: 10/20/2011  
 NO. 37: 10/20/2011  
 NO. 38: 10/20/2011  
 NO. 39: 10/20/2011  
 NO. 40: 10/20/2011  
 NO. 41: 10/20/2011  
 NO. 42: 10/20/2011  
 NO. 43: 10/20/2011  
 NO. 44: 10/20/2011  
 NO. 45: 10/20/2011  
 NO. 46: 10/20/2011  
 NO. 47: 10/20/2011  
 NO. 48: 10/20/2011  
 NO. 49: 10/20/2011  
 NO. 50: 10/20/2011  
 NO. 51: 10/20/2011  
 NO. 52: 10/20/2011  
 NO. 53: 10/20/2011  
 NO. 54: 10/20/2011  
 NO. 55: 10/20/2011  
 NO. 56: 10/20/2011  
 NO. 57: 10/20/2011  
 NO. 58: 10/20/2011  
 NO. 59: 10/20/2011  
 NO. 60: 10/20/2011  
 NO. 61: 10/20/2011  
 NO. 62: 10/20/2011  
 NO. 63: 10/20/2011  
 NO. 64: 10/20/2011  
 NO. 65: 10/20/2011  
 NO. 66: 10/20/2011  
 NO. 67: 10/20/2011  
 NO. 68: 10/20/2011  
 NO. 69: 10/20/2011  
 NO. 70: 10/20/2011  
 NO. 71: 10/20/2011  
 NO. 72: 10/20/2011  
 NO. 73: 10/20/2011  
 NO. 74: 10/20/2011  
 NO. 75: 10/20/2011  
 NO. 76: 10/20/2011  
 NO. 77: 10/20/2011  
 NO. 78: 10/20/2011  
 NO. 79: 10/20/2011  
 NO. 80: 10/20/2011  
 NO. 81: 10/20/2011  
 NO. 82: 10/20/2011  
 NO. 83: 10/20/2011  
 NO. 84: 10/20/2011  
 NO. 85: 10/20/2011  
 NO. 86: 10/20/2011  
 NO. 87: 10/20/2011  
 NO. 88: 10/20/2011  
 NO. 89: 10/20/2011  
 NO. 90: 10/20/2011  
 NO. 91: 10/20/2011  
 NO. 92: 10/20/2011  
 NO. 93: 10/20/2011  
 NO. 94: 10/20/2011  
 NO. 95: 10/20/2011  
 NO. 96: 10/20/2011  
 NO. 97: 10/20/2011  
 NO. 98: 10/20/2011  
 NO. 99: 10/20/2011  
 NO. 100: 10/20/2011

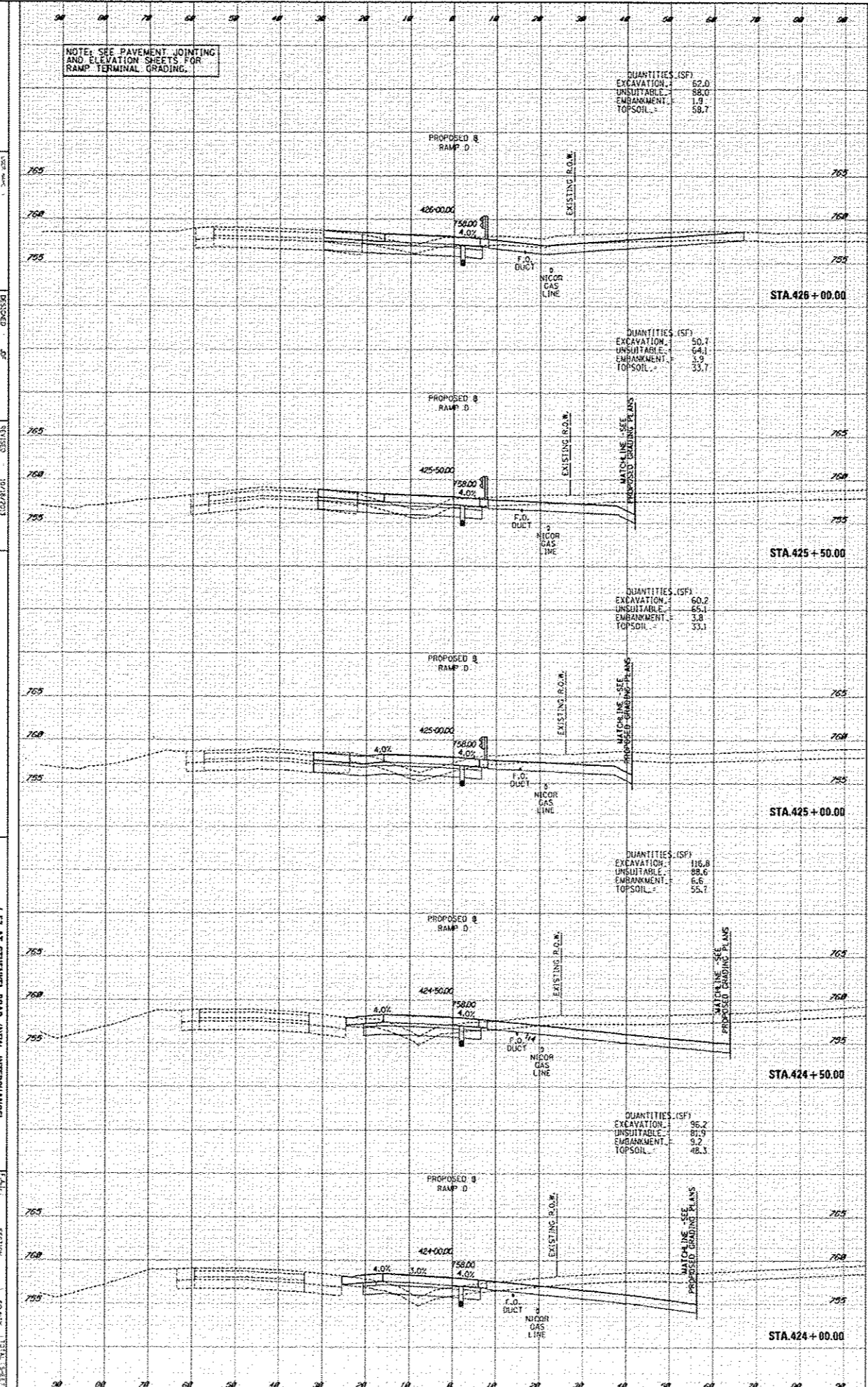

QUANTITIES (SF)	
EXCAVATION	62.0
UNSUITABLE EMBANKMENT	58.0
TOPSOIL	1.9
	58.7

QUANTITIES (SF)	
EXCAVATION	50.7
UNSUITABLE EMBANKMENT	64.1
TOPSOIL	1.9
	33.7

QUANTITIES (SF)	
EXCAVATION	60.2
UNSUITABLE EMBANKMENT	55.1
TOPSOIL	3.8
	33.1

QUANTITIES (SF)	
EXCAVATION	116.8
UNSUITABLE EMBANKMENT	58.6
TOPSOIL	6.6
	55.7

QUANTITIES (SF)	
EXCAVATION	96.2
UNSUITABLE EMBANKMENT	81.9
TOPSOIL	3.2
	48.3