

DATE: \_\_\_\_\_  
 BY: \_\_\_\_\_  
 FINI SURVEYED \_\_\_\_\_  
 SUPPLY ACQUIRED \_\_\_\_\_  
 NOTE BOOK \_\_\_\_\_  
 AREAS AS CHECKED \_\_\_\_\_

DATE: \_\_\_\_\_  
 BY: \_\_\_\_\_  
 FINI SURVEYED \_\_\_\_\_  
 SUPPLY ACQUIRED \_\_\_\_\_  
 NOTE BOOK \_\_\_\_\_  
 AREAS AS CHECKED \_\_\_\_\_

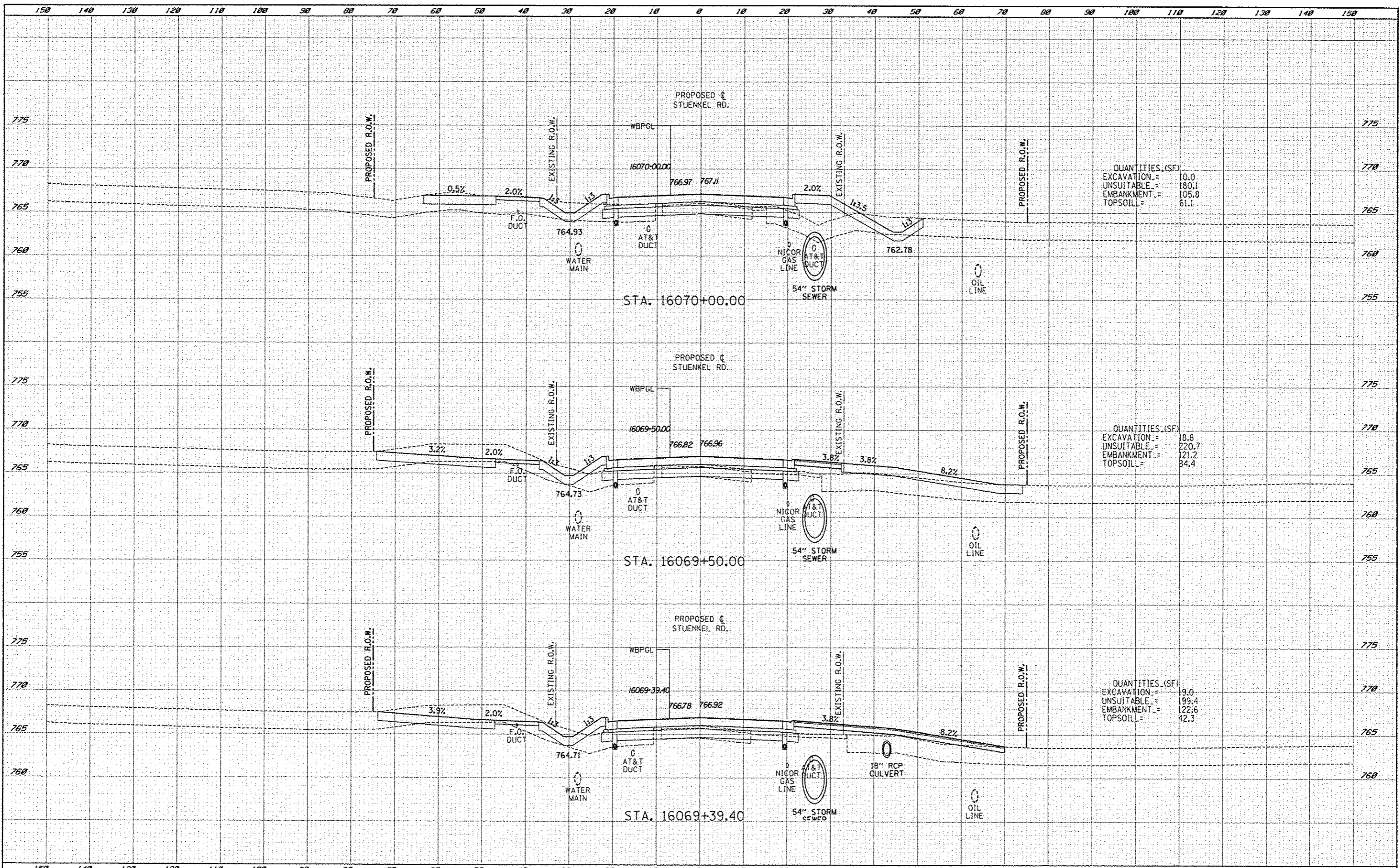

QUANTITIES (SF)

EXCAVATION	=	10.0
UNSUITABLE	=	180.1
EMBANKMENT	=	105.8
TOPSOIL	=	61.1

QUANTITIES (SF)

EXCAVATION	=	18.8
UNSUITABLE	=	220.7
EMBANKMENT	=	121.2
TOPSOIL	=	84.4

QUANTITIES (SF)

EXCAVATION	=	9.0
UNSUITABLE	=	199.4
EMBANKMENT	=	122.6
TOPSOIL	=	42.3

<b>TYLINTERNATIONAL</b> DESIGNER DRAWN CHECKED DATE	DESIGNED	JDF	REVISED	10/18/13	<b>STATE OF ILLINOIS</b> <b>DEPARTMENT OF TRANSPORTATION</b>	<b>I-57 AT STUENKEL ROAD (NEW INTERCHANGE)</b> <b>PROPOSED STUENKEL ROAD CROSS SECTIONS</b>		F.A.I. RTE.	SECTION	COUNTY	TOTAL SHEETS	SHEET NO.
	DRAWN	JDF	REVISED			57	99-1HB-R1	WILL	679	487		
	CHECKED	JPM	REVISED			SCALE: 1" = 20' H SHEET NO. OF SHEETS		STA. 16069+39.40 TO STA. 16070+00.00		ILLINOIS FED. AID PROJECT		
	DATE	5/10/2013	REVISED			CONTRACT NO. 60L69						