

DATE _____ BY _____
 FINISHED _____
 SURVEY _____
 PLOTTED _____
 NOTE BOOK _____
 AREA \$ 293.45 EXP. 2453

DATE _____ BY _____
 FINISHED _____
 SURVEY _____
 PLOTTED _____
 NOTE BOOK _____
 AREA \$ 293.45 EXP. 2453

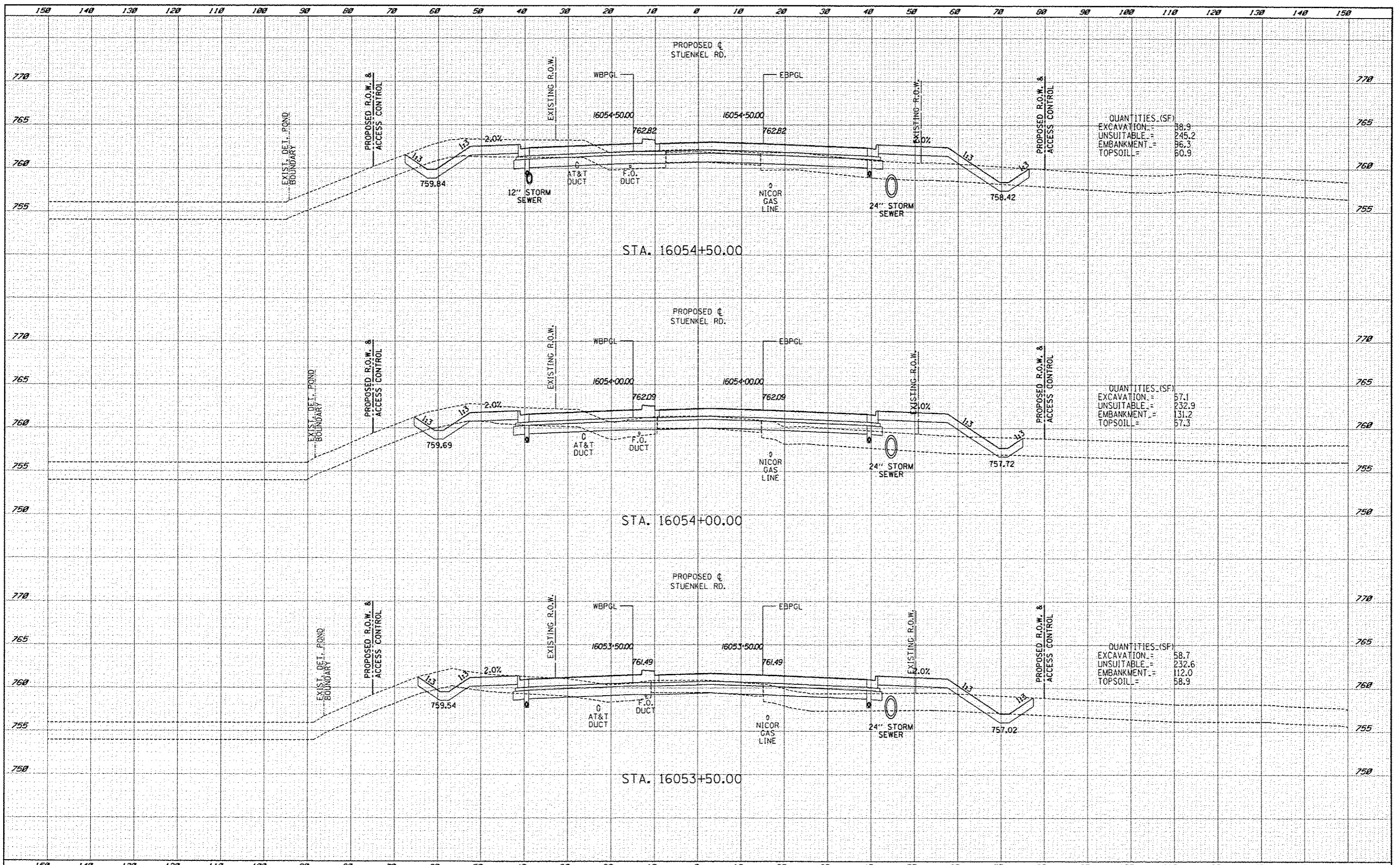

QUANTITIES (SF)

EXCAVATION	=	58.9
UNSUITABLE	=	245.2
EMBANKMENT	=	56.3
TOPSOIL	=	60.9

QUANTITIES (SF)

EXCAVATION	=	57.1
UNSUITABLE	=	232.9
EMBANKMENT	=	131.2
TOPSOIL	=	57.3

QUANTITIES (SF)

EXCAVATION	=	58.7
UNSUITABLE	=	232.6
EMBANKMENT	=	112.0
TOPSOIL	=	58.9

TYLIN INTERNATIONAL

USER NAME _____
 PROJECT _____
 PLOT DATE _____

DESIGNED	JDF	REVISED	10/18/13
DRAWN	JDF	REVISED	
CHECKED	JPM	REVISED	
DATE	5/10/2013	REVISED	

**STATE OF ILLINOIS
 DEPARTMENT OF TRANSPORTATION**

**I-57 AT STUENKEL ROAD (NEW INTERCHANGE)
 PROPOSED STUENKEL ROAD CROSS SECTIONS**

SCALE: 1" = 30'
 SHEET NO. _____ OF _____ SHEETS
 STA. 16053+50.00 TO STA. 16054+50.00

F.A.I. RTE.	SECTION	COUNTY	TOTAL SHEETS	SHEET NO.
57	99-IHB-R1	WILL	679	475
			CONTRACT NO. 60L69	
FED. ROAD DIST. NO. _____ ILLINOIS FED. AID PROJECT				

\\G60261201-57-9-Stuenkel@Illroad\AC-3\Interchange\AC-3-Stuenkel_50X5_511.dgn