

DATE	
BY	
REVISIONS	
NO.	
DATE	
BY	
REVISIONS	
NO.	
DATE	
BY	
REVISIONS	
NO.	

DATE	
BY	
REVISIONS	
NO.	
DATE	
BY	
REVISIONS	
NO.	
DATE	
BY	
REVISIONS	
NO.	

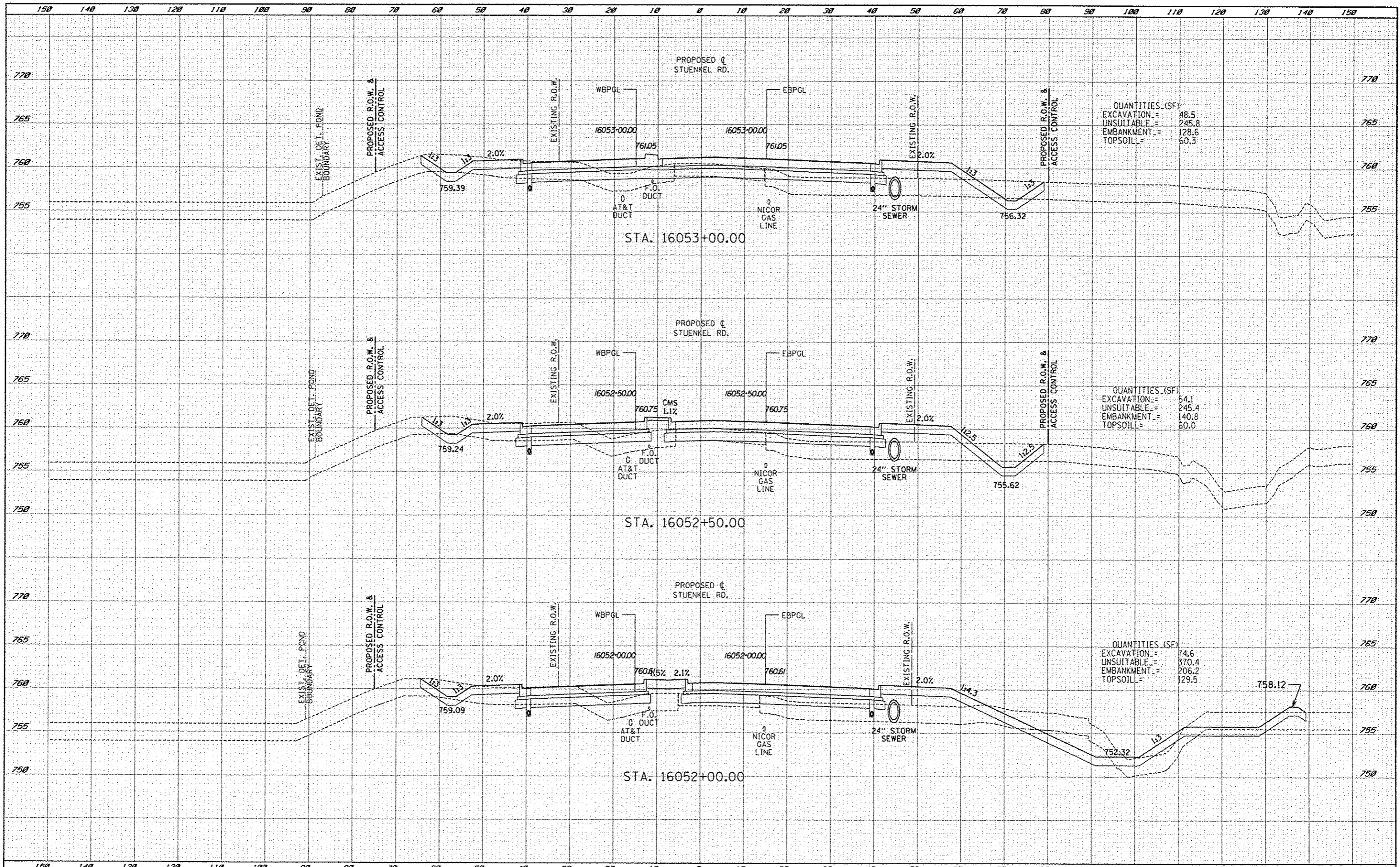

QUANTITIES (SF)

EXCAVATION	18.5
UNSUITABLE	245.8
EMBANKMENT	128.6
TOPSOIL	60.3

QUANTITIES (SF)

EXCAVATION	54.1
UNSUITABLE	245.4
EMBANKMENT	140.8
TOPSOIL	60.0

QUANTITIES (SF)

EXCAVATION	74.6
UNSUITABLE	370.4
EMBANKMENT	206.2
TOPSOIL	129.5

**TYL INTERNATIONAL**

USER NAME	DESIGNED	JDF	REVISED	10/18/13
	DRAWN	JDF	REVISED	
	CHECKED	JPM	REVISED	
	DATE	5/10/2013	REVISED	

**STATE OF ILLINOIS  
DEPARTMENT OF TRANSPORTATION**

**I-57 AT STUENKEL ROAD (NEW INTERCHANGE)  
PROPOSED STUENKEL ROAD CROSS SECTIONS**

F.A.I. RTE.	SECTION	COUNTY	TOTAL SHEETS	SHEET NO.
57	99-1HB-R1	WILL	679	474
			CONTRACT NO. 60L69	

SCALE: 1" = 10' SHEET NO. OF SHEETS STA. 16052+00.00 TO STA. 16053+00.00 FED. ROAD DIST. NO. ILLINOIS FED. AID PROJECT

P:\60261201\_57 @ Stuenkel\Road\NC\_30\Interchange\NC\_3 Stuenkel\_50X5\_501.dgn