

DATE	
BY	
REVISIONS	
NO.	DESCRIPTION
1	AREA CHECKED
2	AREAS CHECKED
3	AREAS CHECKED
4	AREAS CHECKED
5	AREAS CHECKED
6	AREAS CHECKED
7	AREAS CHECKED
8	AREAS CHECKED
9	AREAS CHECKED
10	AREAS CHECKED

DATE	
BY	
REVISIONS	
NO.	DESCRIPTION
1	AREA CHECKED
2	AREAS CHECKED
3	AREAS CHECKED
4	AREAS CHECKED
5	AREAS CHECKED
6	AREAS CHECKED
7	AREAS CHECKED
8	AREAS CHECKED
9	AREAS CHECKED
10	AREAS CHECKED

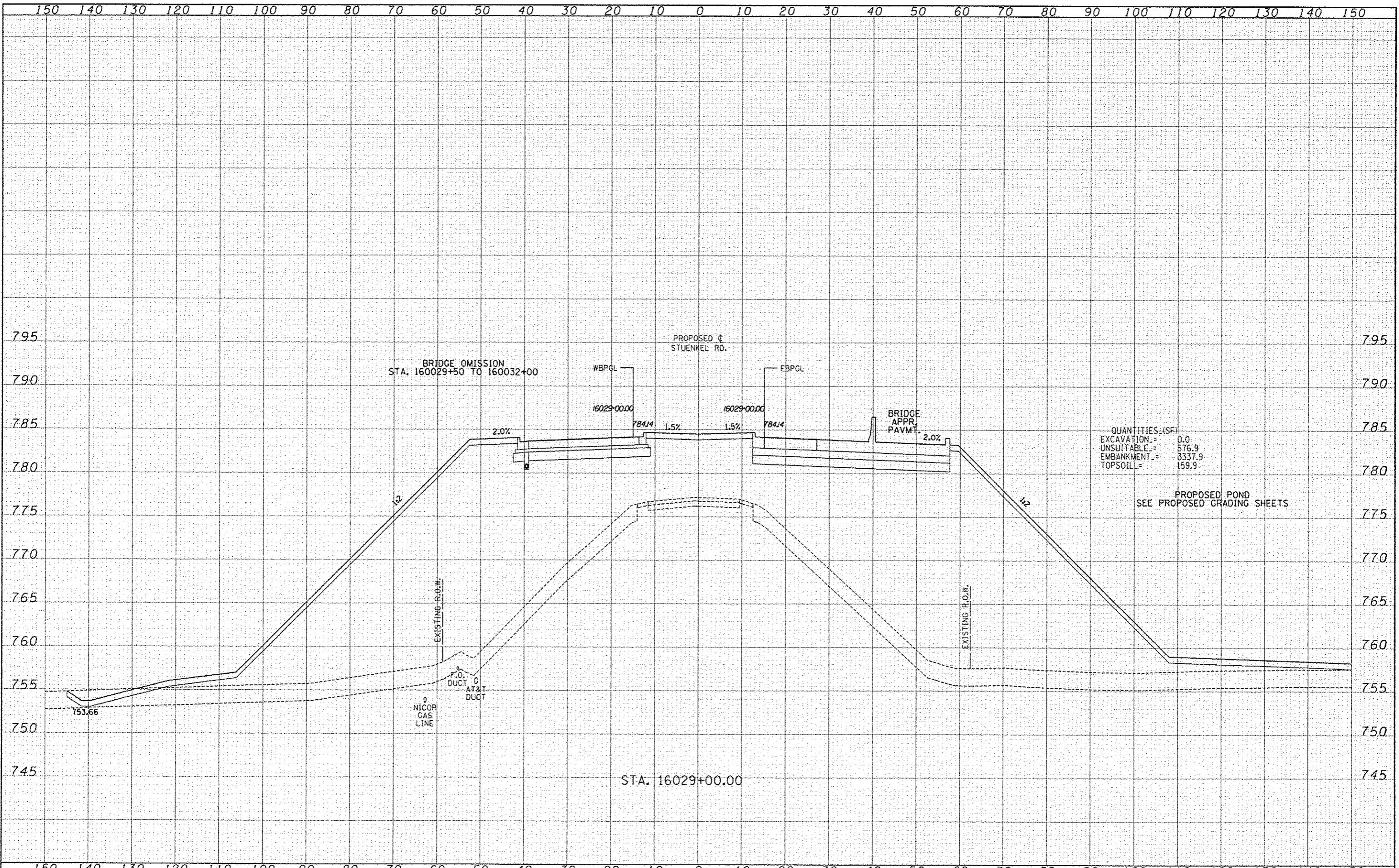

TYLINTERNATIONAL	DESIGNED	JDF	REVISED		STATE OF ILLINOIS DEPARTMENT OF TRANSPORTATION	I-57 AT STUENKEL ROAD (NEW INTERCHANGE) PROPOSED STUENKEL ROAD CROSS SECTIONS		F.A.I. RTE. 57	SECTION 99-1HB-RI	COUNTY WILL	TOTAL SHEETS 679	SHEET NO. 450
	DRAWN	JDF	REVISED			SCALE: 1" = 80'	SHEET NO.	OF SHEETS	STA. 16029+00.00 TO STA. 16029+00.00	FED. ROAD DIST. NO.	ILLINOIS FED. AID PROJECT	CONTRACT NO. 60L69
	CHECKED	JPM	REVISED									
	DATE	5/10/2013	REVISED									

P:\60261241-57 @ Stuenkel\Road\3\Interchange\NO3.Stuenkel.50X5.dwg