

DATE	
BY	
DESIGNED	
DRAWN	
CHECKED	
DATE	

DATE	
BY	
DESIGNED	
DRAWN	
CHECKED	
DATE	

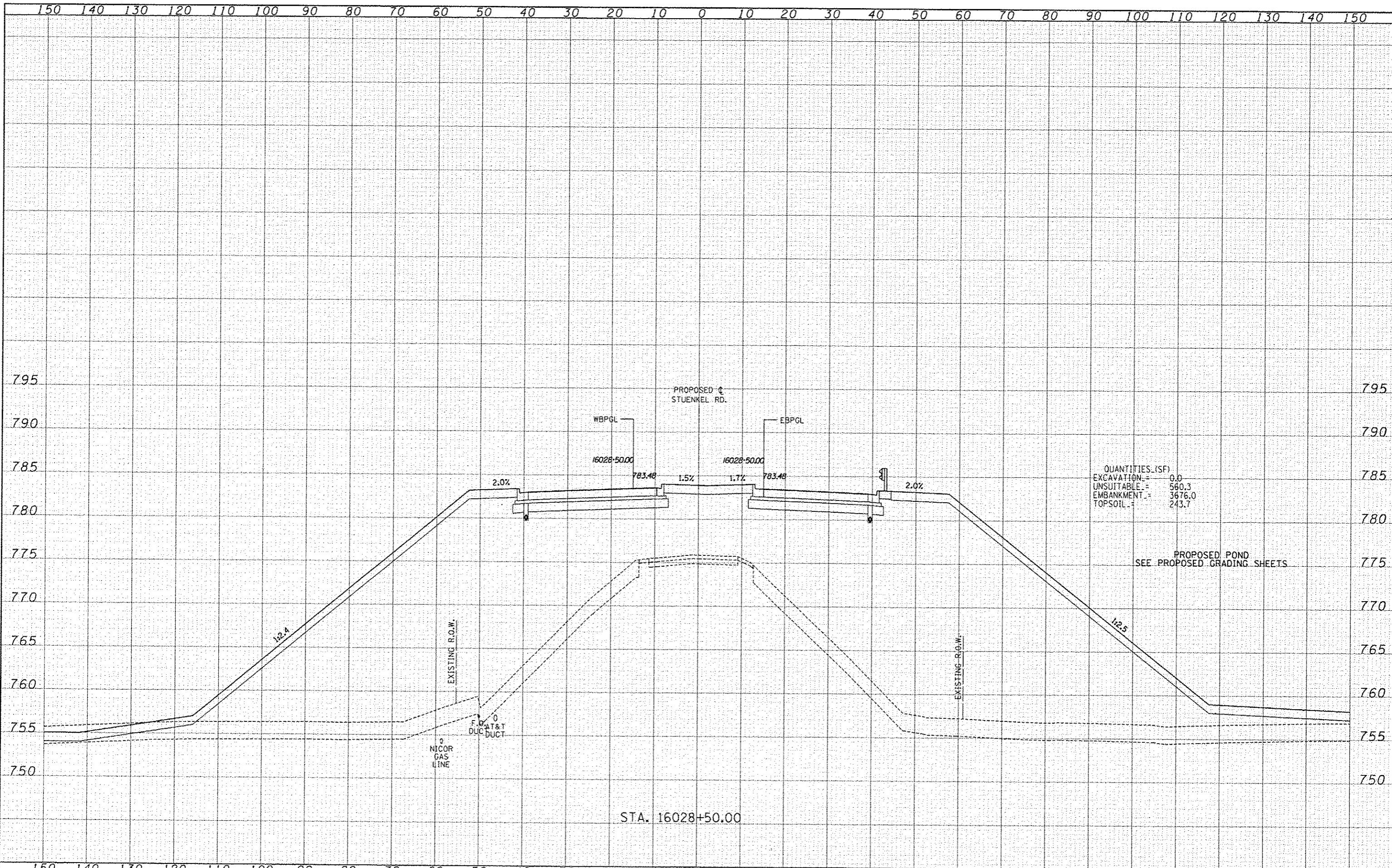

QUANTITIES (SF)

EXCAVATION	=	0.0
UNSUITABLE	=	560.3
EMBANKMENT	=	3676.0
TOPSOIL	=	243.7

PROPOSED POND  
SEE PROPOSED GRADING SHEETS

<b>TYLIN INTERNATIONAL</b>	USER NAME	DESIGNED - JDF	REVISED	<b>STATE OF ILLINOIS DEPARTMENT OF TRANSPORTATION</b>	<b>I-57 AT STUENKEL ROAD (NEW INTERCHANGE) PROPOSED STUENKEL ROAD CROSS SECTIONS</b>	F.A.I. RTE.	SECTION	COUNTY	TOTAL SHEETS	SHEET NO.
	PL. OF SCALE	DRAWN - JDF	REVISED			57	99-1HB-RI	WILL	679	449
	PL. OF DATE	CHECKED - JPM	REVISED	SCALE: 1" = 10' H		SHEET NO. OF SHEETS		CONTRACT NO. 60L69		
		DATE 5/10/2013	REVISED	STA. 16028+50.00 TO STA. 16028+50.00		FED. ROAD DIST. NO. ILLINOIS FED. AID PROJECT				

I:\60226120\57 @ Stuenkel\Road\I-57 Interchange\I-57 Stuenkel 50X8 511.dgn