

NOTES:

1. THE EXISTING LIGHTING CONTROLLER SHALL BE REMOVED AND RELOCATED ON TEMPORARY WOOD POLE DURING PRE-STAGE 1 CONSTRUCTION AS SHOWN ON TEMPORARY LIGHTING PLANS. ALL NECESSARY WORK INCLUDING INSTALLATION OF TEMPORARY WOOD POLES, TEMPORARY LIGHTING UNITS, TEMPORARY SERVICE INSTALLATION, TEMPORARY BRANCH CIRCUITS, AND COORDINATION WITH COMED SHALL BE DONE PRIOR TO CONTROLLER REMOVAL. THE RELOCATION OF EXISTING CONTROLLER AND TEMPORARY MAINLINE LIGHTING SYSTEM SHALL BE MADE OPERATIONAL THE SAME DAY BEFORE DUSK. THIS WORK IS INCIDENTAL TO ASSOCIATED PAY ITEMS.
2. THE TEMPORARILY RELOCATED EXISTING LIGHTING CONTROLLER SHALL BE REMOVED AFTER PROPOSED LIGHTING CONTROLLER IS INSTALLED AND PROPOSED LIGHTING SYSTEM IS TESTED AND ACCEPTED FULLY OPERATIONAL. THE CONTROLLER SHALL BE RETURNED TO THE IDOT DISTRICT 1 FACILITY AS PER SPECIAL PROVISIONS.
3. THE PROPOSED UNDERPASS LIGHTING SYSTEM SHALL BE INSTALLED IN APPROVED OPERATION DURING PRE-STAGE 1 CONSTRUCTION AND POWERED FROM TEMPORARY LIGHTING SYSTEM DURING CONSTRUCTION.
4. THE UNIT DUCT INSTALLED FOR TEMPORARY LIGHTING DURING PRE-STAGE 1 SHALL BE REMOVED AND DISPOSED OF OFF THE SITE DURING WOOD POLE REMOVAL. THE COST OF UNIT DUCT REMOVAL SHALL BE INCLUDED IN TEMPORARY WOOD POLE REMOVAL.
5. AERIAL LIGHTING CABLE SHALL BE INSTALLED SUCH THAT THE MINIMUM VERTICAL CLEARANCE FROM LOWEST POINT ON AERIAL CABLE SPAN IS MINIMUM 20FT FROM HIGHEST POINT OF EXISTING OR PROPOSED STRUCTURE OR GRADE.

NOTES FOR LIGHTING DURING CONSTRUCTION

A. COMPLETE TEMPORARY LIGHTING SYSTEM INCLUDING, RELOCATION OF EXISTING CONTROLLER, TEMPORARY LIGHTING UNITS, AERIAL CABLES, AND OTHER TEMPORARY LIGHTING ITEMS SHOWN ON THE TEMPORARY LIGHTING PLANS SHALL BE INSTALLED IN APPROVED OPERATION DURING PRE-STAGE 1 CONSTRUCTION PRIOR TO REMOVAL OF EXISTING LIGHTING SYSTEM UNLESS NOTED OTHERWISE.

B. TEMPORARY LIGHTING SYSTEM SHALL BE REMOVED AFTER PROPOSED LIGHTING SYSTEM IS INSTALLED IN APPROVED OPERATION.

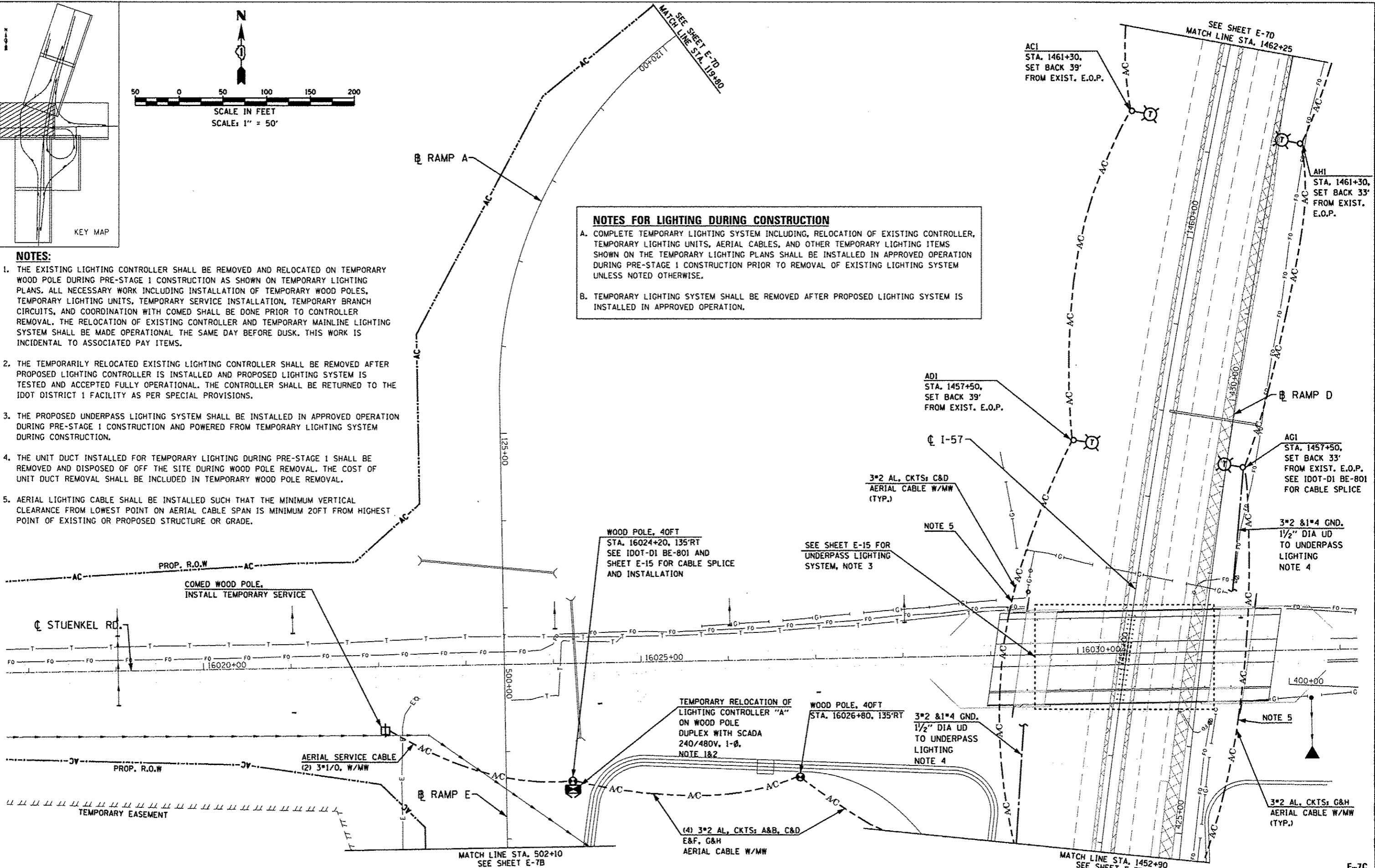

I:\327\ADN\CADD_Sheets\160169-sht-light-07.cad
 05-DEC-2013 13:18 TIME \$
 SINGH & ASSOCIATES, INC.
 CONSULTING ENGINEERS

SINGH
 SINGH & ASSOCIATES, INC.
 CONSULTING ENGINEERS

USER NAME	mgarvido	DESIGNED	RDV	REVISED	6/18/2013
PLOT SCALE	100.0000001.000000	DRAWN	MG/WC	REVISED	8/22/2013
PLOT DATE	05-DEC-2013 13:18	CHECKED	KGP	REVISED	10/18/2013
		DATE	8/22/2013	REVISED	12/04/2013

STATE OF ILLINOIS
DEPARTMENT OF TRANSPORTATION

STUENKEL ROAD OVER I-57
TEMPORARY LIGHTING PLANS - STAGE 1&2

F.A.I. RTE.	SECTION	COUNTY	TOTAL SHEETS	SHEET NO.
57	99-1HB-R	WILL	679	330C
SCALE: AS NOTED			SHEET NO. 10 OF 24 SHEETS STA. ----- TO STA. -----	
ILLINOIS FED. AID PROJECT				

E-7C