

- NOTES:**
1. THE EXISTING LIGHT POLE, METAL FOUNDATION AND BREAKAWAY TRANSFORMER BASE SHALL BE REMOVED. THE METAL FOUNDATION SHALL BE REMOVED AND DISPOSED OF OFF THE PROJECT SITE. REMOVED LIGHT POLE AND BREAKAWAY TRANSFORMER BASE SHALL BE REINSTALLED AS SHOWN ON PROPOSED LIGHTING PLANS. THE REMOVAL, STORAGE DURING CONSTRUCTION AND REINSTALLATION OF REMOVED LIGHT POLE AND BREAKAWAY TRANSFORMER BASE SHALL BE PART OF THE PAY ITEM "RELOCATE EXISTING LIGHTING UNIT"
 2. THE EXISTING LIGHT POLE SHALL BE REMOVED, METAL FOUNDATION AND BREAKAWAY TRANSFORMER BASE SHALL REMAIN IN PLACE. THE REMOVAL, STORAGE DURING CONSTRUCTION AND REINSTALLATION OF REMOVED LIGHT POLE SHALL BE PART OF THE PAY ITEM "RELOCATE EXISTING LIGHTING UNIT"
 3. THE EXISTING 310W HPS LUMINAIRE SHALL BE REMOVED AND TEMPORARY 400W HPS TYPE III LUMINAIRE SHALL BE INSTALLED ON EXISTING LIGHTING UNIT. THE CONTRACTOR SHALL STORE THE EXISTING 310W HPS LUMINAIRE AND REINSTALL WITH NEW LAMP AFTER COMPLETION OF STAGE 2 CONSTRUCTION.
 4. THE EXISTING LIGHTING SYSTEM SHALL BE REMOVED AFTER TEMPORARY LIGHTING SYSTEM IS INSTALLED AND MADE OPERATIONAL.
 5. THE EXPOSED EXISTING UNIT DUCTS SHALL BE PROTECTED DURING CONSTRUCTION, THE SUGGESTED ALTERNATIVE IS TO INSTALL ANOTHER TRANSFORMER BASE ON TOP OF EXISTING TRANSFORMER BASE AND COVER IT WITH METAL PLATE. ANY (DAMAGED) AND MISSING EXISTING UNIT DUCTS AND TRANSFORMER BASE DURING CONSTRUCTION AFTER REMOVAL OF EXISTING LIGHT POLE SHALL BE REPLACED IN KIND BY THE CONTRACTOR AT NO ADDITIONAL COST. THE MATERIALS AND LABOR NEEDED FOR PROTECTION OF EXPOSED UNIT DUCTS SHALL BE INCLUDED AS PART OF THE PAY ITEM "MAINTENANCE OF LIGHTING SYSTEM"
 6. THE EXISTING LIGHTING CONTROLLER SHALL BE REMOVED AND RELOCATED ON TEMPORARY WOOD POLE DURING PRE-STAGE 1 CONSTRUCTION AS SHOWN ON TEMPORARY LIGHTING PLANS. ALL NECESSARY WORK INCLUDING INSTALLATION OF TEMPORARY WOOD POLES, TEMPORARY LIGHTING UNITS, TEMPORARY SERVICE INSTALLATION, TEMPORARY BRANCH CIRCUITS, AND COORDINATION WITH COMED SHALL BE DONE PRIOR TO CONTROLLER REMOVAL. THE RELOCATION OF EXISTING CONTROLLER AND TEMPORARY MAINLINE LIGHTING SYSTEM SHALL BE MADE OPERATIONAL THE SAME DAY BEFORE DUSK. THIS WORK IS INCIDENTAL TO ASSOCIATED PAY ITEMS.

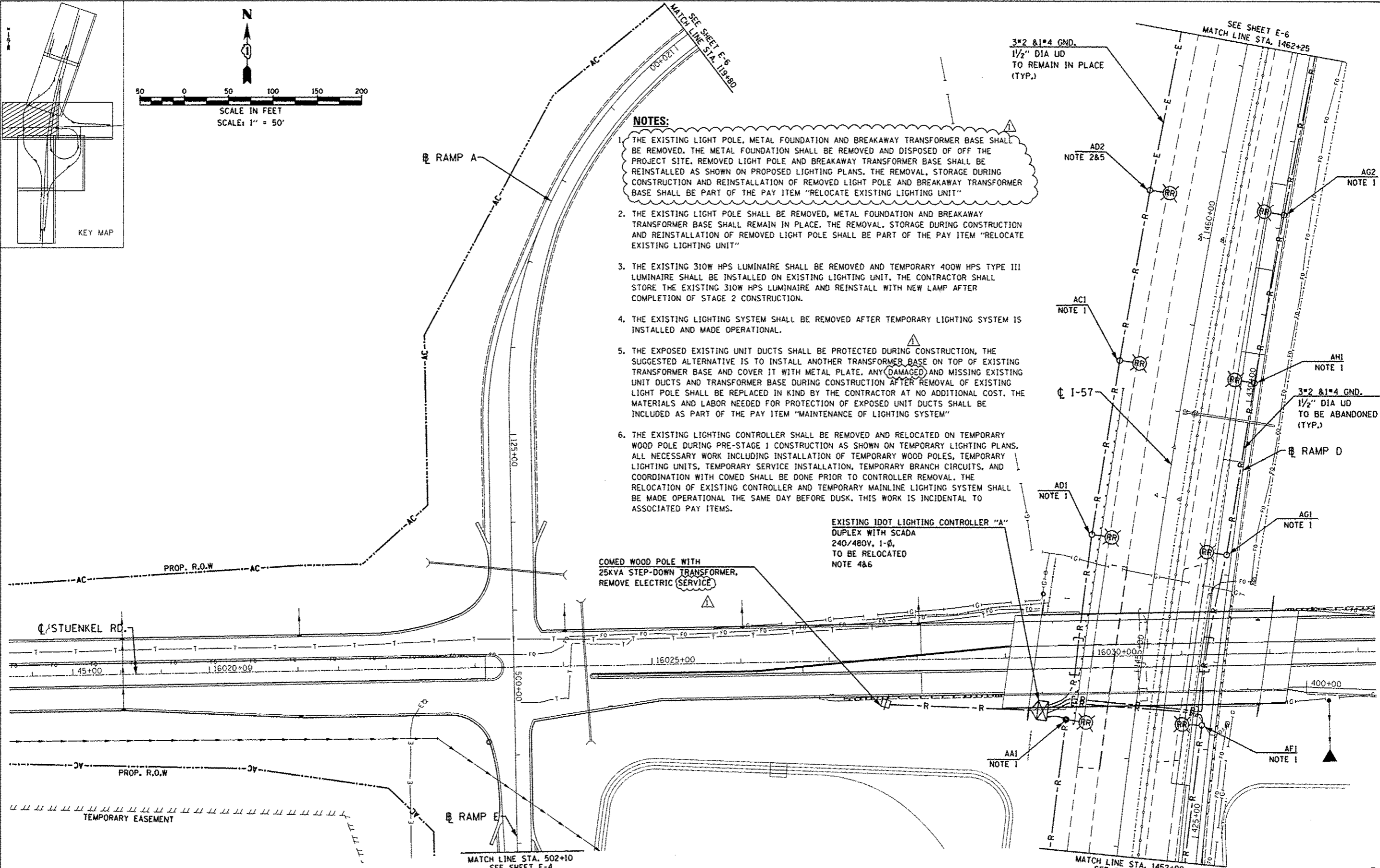

COMED WOOD POLE WITH 25KVA STEP-DOWN TRANSFORMER, REMOVE ELECTRIC SERVICE

EXISTING IDOT LIGHTING CONTROLLER "A" DUPLEX WITH SCADA 240/480V, 1-Ø, TO BE RELOCATED NOTE 4&6

3" x 2" x 1/4" GND. 1/2" DIA UD TO REMAIN IN PLACE (TYP.)

3" x 2" x 1/4" GND. 1/2" DIA UD TO BE ABANDONED (TYP.)

I:\2013\06\01\05.dgn Sheets\06\01\05-sh1-light-05.dgn 26-DEC-2013 15:03 TIME\$

SINGH
SINGH & ASSOCIATES INC.
CONSULTING ENGINEERS

USER NAME: kprajapati
DESIGNED - RDP
DRAWN - MG/WC
CHECKED - KGP
DATE - 8/22/2013
PLOT SCALE: 1/8" = 100.00000001.000000
PLOT DATE: 26-DEC-2013 15:00

DESIGNED - RDP
DRAWN - MG/WC
CHECKED - KGP
DATE - 8/22/2013

REVISED 6/18/2013
REVISED 8/22/2013
REVISED 10/18/2013
REVISED 12/04/2013

STATE OF ILLINOIS
DEPARTMENT OF TRANSPORTATION

STUENKEL ROAD OVER I-57
EXISTING LIGHTING REMOVAL PLANS
SCALE: AS NOTED SHEET NO. 5 OF 24 SHEETS STA. ---- TO STA. ----

F.A.I. RTE.	SECTION	COUNTY	TOTAL SHEETS	SHEET NO.
67	99-1HB-R	WILL	679	328
				CONTRACT NO. 60L69
ILLINOIS FED. AID PROJECT				

ADDENDUM 1 1/03/14