

MATCHLINE STA. 237+00
RAMP B

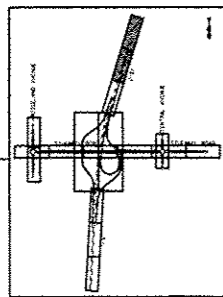

NOTES:

1. ⊗ FOR PROPOSED SIGN LEGEND SEE "SIGNING PLAN DETAILS"
2. SIGN CALL OUTS REFER TO CENTER OF SIGN ASSEMBLY.

W4-1R ⊗
243+39
15.0 RT
PLACE ON
LIGHT POLE



AVR2-40
1493+15
73.0 RT

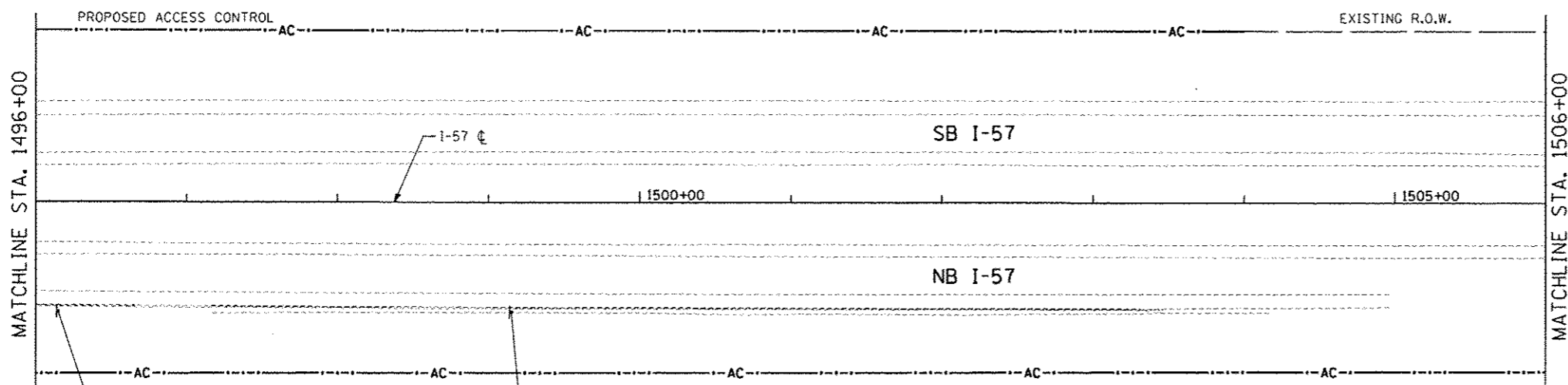
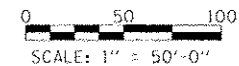

R2-1109, R2-1(55) ⊗ ⊗
1496+15
73.0 RT

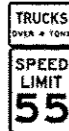

M3-1, M1-1 ⊗ ⊗
1499+15
73.0 RT

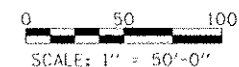

TYLIN INTERNATIONAL

USER NAME
PLOT SCALE
PLOT DATE

DESIGNED - KJS
DRAWN - KJS
CHECKED - JPM
DATE - 05/10/2013

REVISED -
REVISED -
REVISED -
REVISED -

**STATE OF ILLINOIS
DEPARTMENT OF TRANSPORTATION**

**STUENKEL ROAD AT I-57 RIDGELAND AVENUE TO CENTRAL AVENUE
SIGNING PLAN - RAMP B, I-57**

SCALE: 1" = 50' SHEET 14 OF 16 SHEETS STA. 1482+00 TO STA. 1506+00

F.A. RTE.	SECTION	COUNTY	TOTAL SHEETS	SHEET NO.
57	99-1HB-RI	WILL	679	293
CONTRACT NO. 60L69				

ILLINOIS FED. AID PROJECT