

SEE STUENKEL ROAD PROPOSED PAVEMENT MARKING SHEET 03

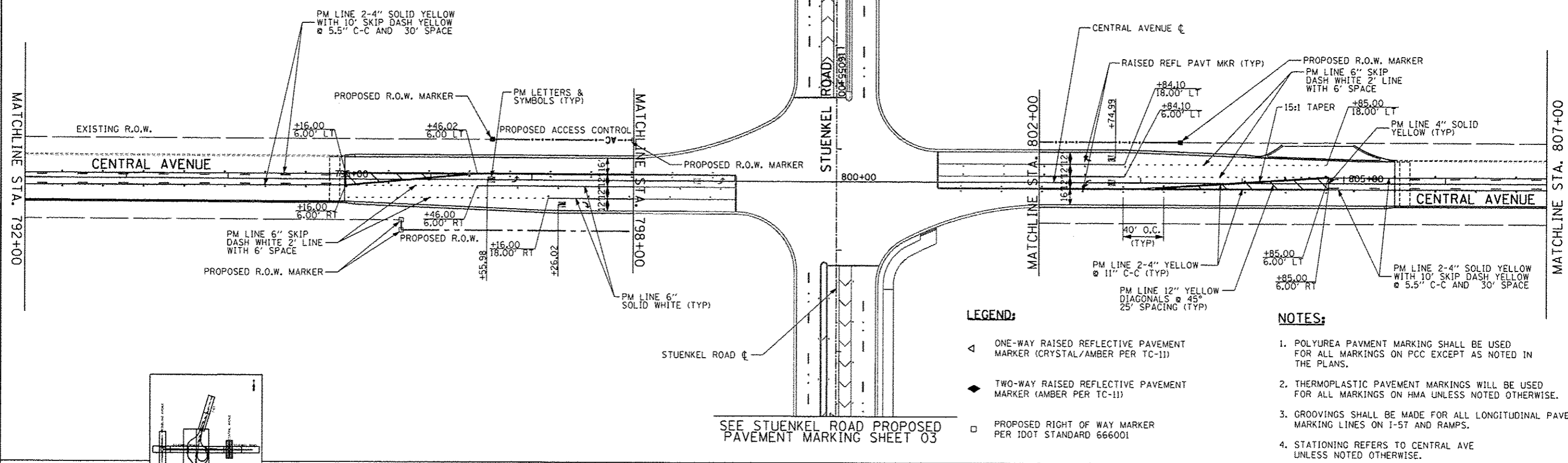

LEGEND:

- ◁ ONE-WAY RAISED REFLECTIVE PAVEMENT MARKER (CRYSTAL/AMBER PER TC-11)
- ◆ TWO-WAY RAISED REFLECTIVE PAVEMENT MARKER (AMBER PER TC-11)
- PROPOSED RIGHT OF WAY MARKER PER 100T STANDARD 666001

NOTES:

1. POLYUREA PAVEMENT MARKING SHALL BE USED FOR ALL MARKINGS ON PCC EXCEPT AS NOTED IN THE PLANS.
2. THERMOPLASTIC PAVEMENT MARKINGS WILL BE USED FOR ALL MARKINGS ON HMA UNLESS NOTED OTHERWISE.
3. GROOVINGS SHALL BE MADE FOR ALL LONGITUDINAL PAVEMENT MARKING LINES ON I-57 AND RAMPS.
4. STATIONING REFERS TO CENTRAL AVE UNLESS NOTED OTHERWISE.

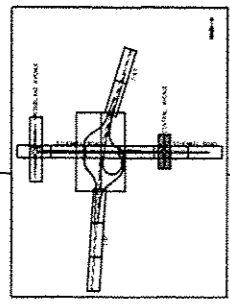

0 50 100
SCALE: 1" = 50'-0"

SEE STUENKEL ROAD PROPOSED PAVEMENT MARKING SHEET 03

| | | | |
|----------------------------|------------|-----------------|----------------------|
| TYLIN INTERNATIONAL | USER NAME | DESIGNED - JTP | REVISED - 06/21/2013 |
| | PROJ SCALE | DRAWN - JTP | REVISED - 10/18/2013 |
| | PROJ DATE | CHECKED - JPM | REVISED |
| | | DATE 05/10/2013 | REVISED |

**STATE OF ILLINOIS
DEPARTMENT OF TRANSPORTATION**

**STUENKEL ROAD AT I-57 RIDGELAND AVENUE TO CENTRAL AVENUE
PAVEMENT MARKING PLAN - CENTRAL AVENUE**

SCALE: 1" = 50' SHEET 6 OF 13 SHEETS STA. 792+00 TO STA. 807+00

| | | | | |
|--------------------|----------------------|----------------|---------------------------|------------------|
| F.A. RTE. 57 | SECTION 99-IHB-R1 | COUNTY WILL | TOTAL SHEETS 679 | SHEET NO. 268 |
| CONTRACT NO. 60L69 | | | ILLINOIS FED. AID PROJECT | |

P:\60261201-57 Stuenkel Road\NC 3\Interchange\NC3 Stuenkel_PM\06.dgn