

PLAN	DATE
NO. 800	BY: J. STUENKEL
NO. 800	BY: J. STUENKEL
NO. 800	BY: J. STUENKEL
NO. 800	BY: J. STUENKEL

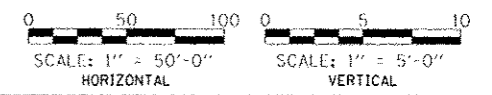

PROFILE	DATE
NO. 800	BY: J. STUENKEL
NO. 800	BY: J. STUENKEL
NO. 800	BY: J. STUENKEL
NO. 800	BY: J. STUENKEL

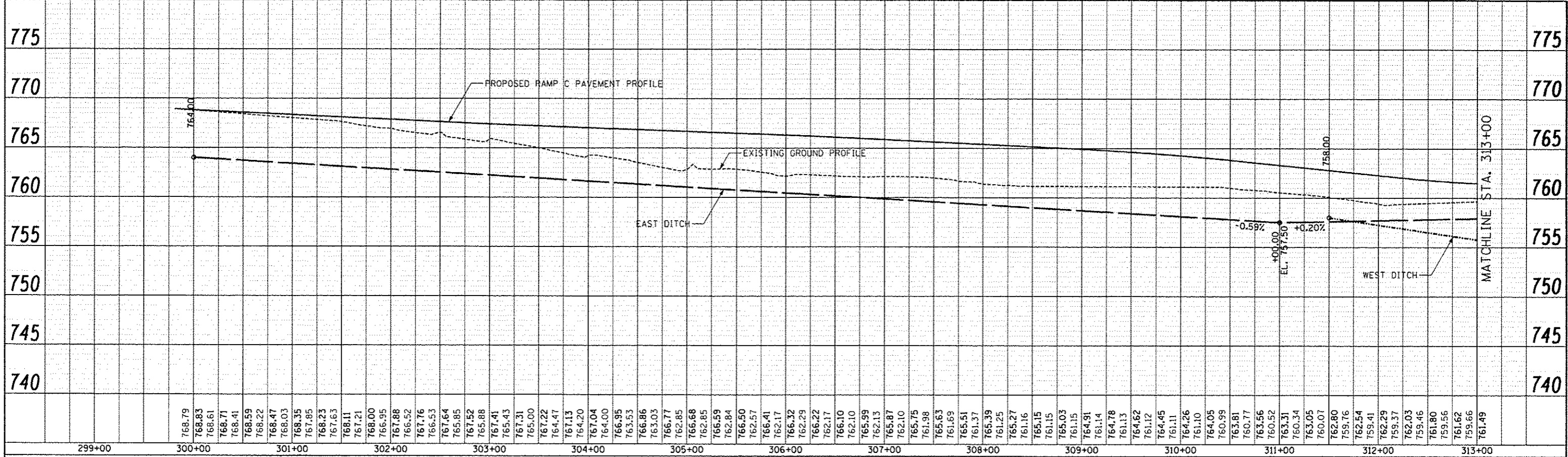
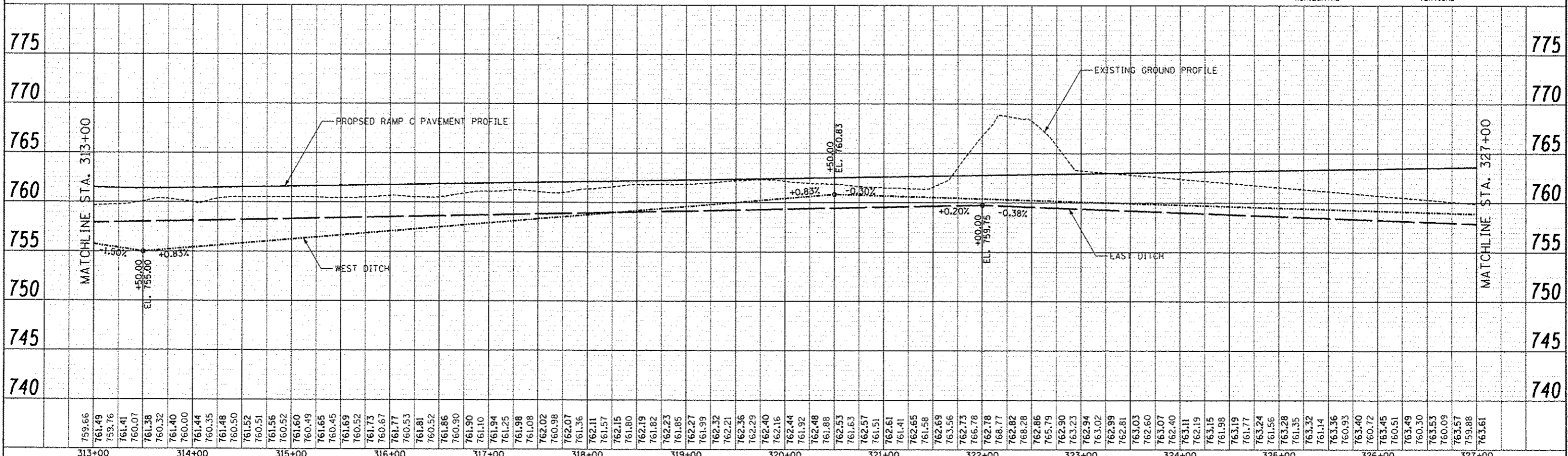

TYLIN INTERNATIONAL USER NAME: _____ PR. OF. SCALE: _____ PR. OF. DATE: _____	DESIGNED: PP	REVISED: _____	STATE OF ILLINOIS DEPARTMENT OF TRANSPORTATION STUENKEL ROAD AT I-57 RIDGELAND AVENUE TO CENTRAL AVENUE PROPOSED DRAINAGE PROFILE - RAMP C SCALE: 1" = 50' SHEET 25 OF 29 SHEETS STA. 300+00 TO STA. 327+00	F.A.I. R.T.E. 57	SECTION 99-IHB-R1	COUNTY WILL	TOTAL SHEETS 679	SHEET NO. 209
	DRAWN: PP	REVISED: _____		CONTRACT NO. 60L69	ILLINOIS FED. AID PROJECT			
	CHECKED: JPM	REVISED: _____						
	DATE: 05/10/2013	REVISED: _____						