

SEE PROPOSED DRAINAGE SHEET 02 OF 29

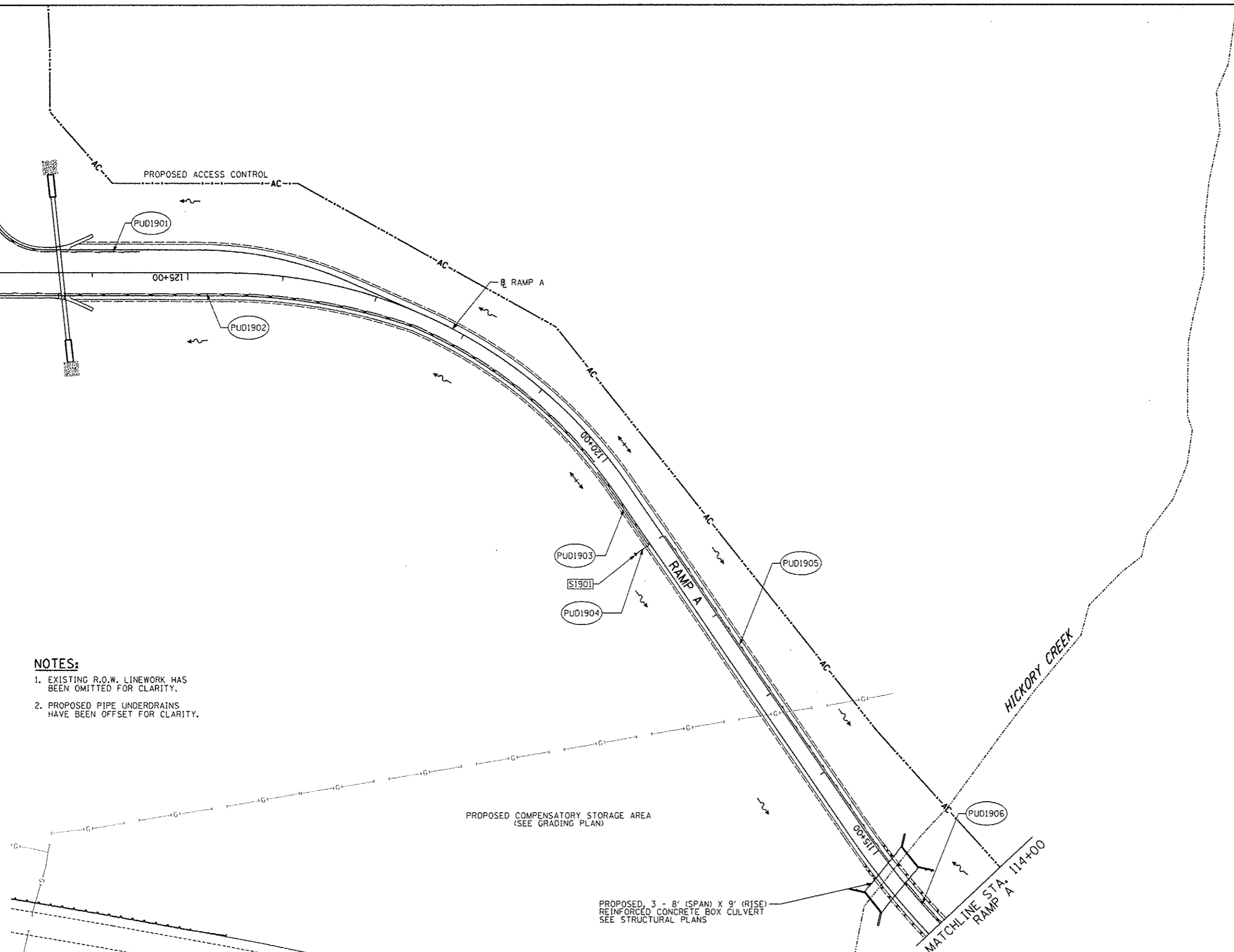

- NOTES:**
- EXISTING R.O.W. LINEWORK HAS BEEN OMITTED FOR CLARITY.
 - PROPOSED PIPE UNDERDRAINS HAVE BEEN OFFSET FOR CLARITY.

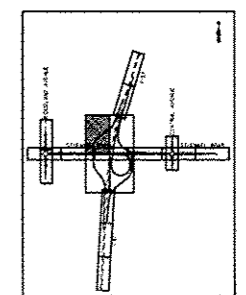

0 50 100
SCALE: 1" = 50'-0"

PROPOSED, 3 - 8' (SPAN) X 9' (RISE) REINFORCED CONCRETE BOX CULVERT SEE STRUCTURAL PLANS

PROPOSED COMPENSATORY STORAGE AREA (SEE GRADING PLAN)

TYLIN INTERNATIONAL

| | |
|-------------------|----------------------|
| DESIGNED - PP | REVISOR - 10/18/2013 |
| DRAWN - PP | REVISIONS - |
| CHECKED - JPM | REVISIONS - |
| DATE - 05/10/2013 | REVISIONS - |

**STATE OF ILLINOIS
DEPARTMENT OF TRANSPORTATION**

**STUENKEL ROAD AT I-57 RIDGELAND AVENUE TO CENTRAL AVENUE
PROPOSED DRAINAGE PLAN - RAMP A**

SCALE: 1" = 50' SHEET 19 OF 29 SHEETS STA. 114+00 TO STA. 127+00

| | | | | |
|---------------------------|-------------------|-------------|--------------------|---------------|
| F.A.I. RTE. 57 | SECTION 99-1HB-R1 | COUNTY WILL | TOTAL SHEETS 679 | SHEET NO. 203 |
| ILLINOIS FED. AID PROJECT | | | CONTRACT NO. 60L69 | |

P:\60261261-57_0_3\work\11\Road\NC_3\Interchange\NC3_Stuenkel\DRP\19.dgn

10/25/2013 3:42:21 PM