

NOTES:

1. EXISTING R.O.W. LINEWORK HAS BEEN OMITTED FOR CLARITY.
2. PROPOSED PIPE UNDERDRAINS HAVE BEEN OFFSET FOR CLARITY.

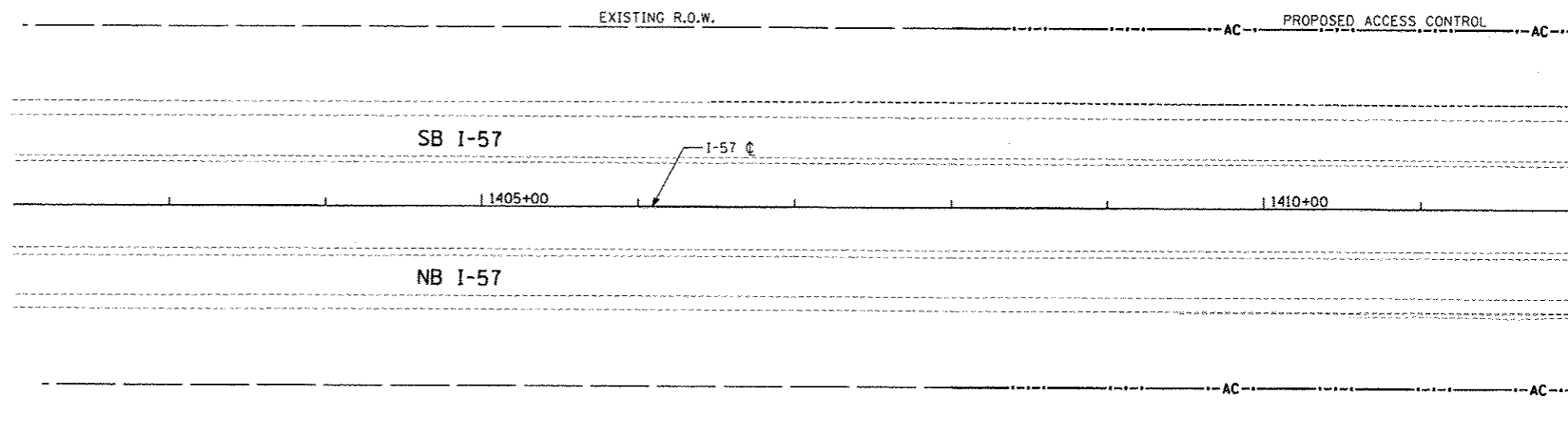

MATCHLINE STA. 1412+00

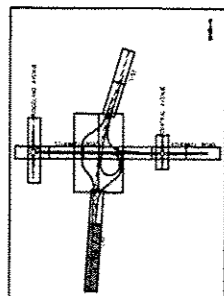
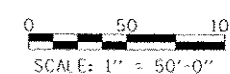
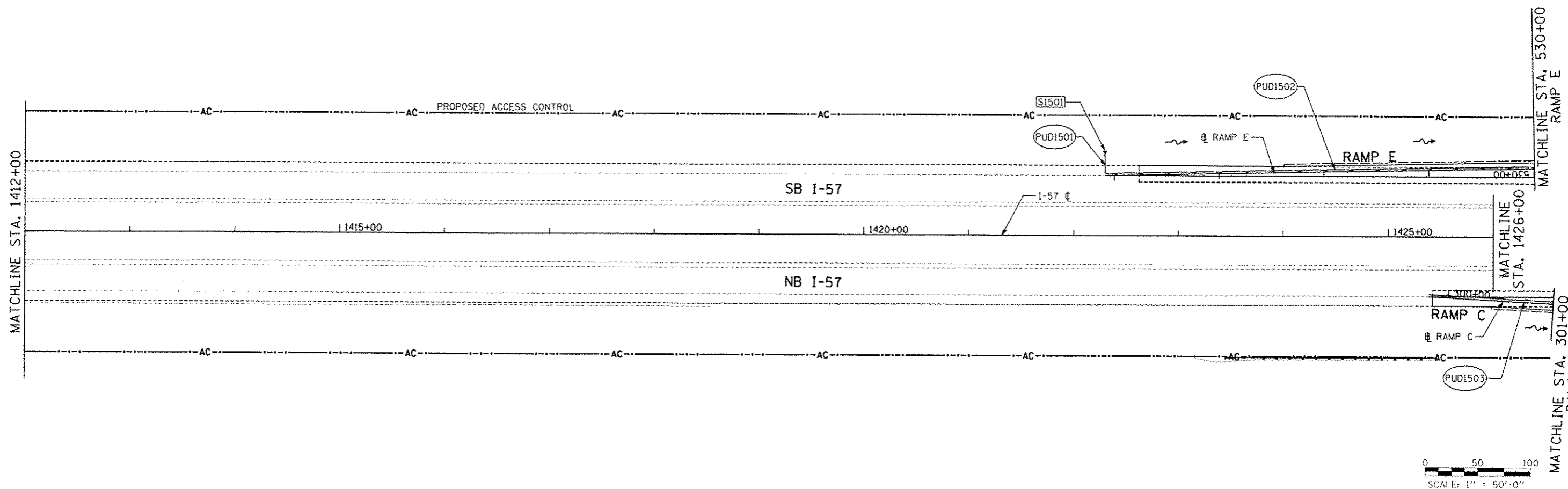
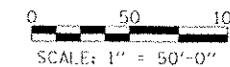

TYLIN INTERNATIONAL	USER NAME	DESIGNED	PP	REVISED	STATE OF ILLINOIS DEPARTMENT OF TRANSPORTATION	STUENKEL ROAD AT I-57 RIDGELAND AVENUE TO CENTRAL AVENUE PROPOSED DRAINAGE PLAN - RAMP C, E, I-57				F.A. RTE.	SECTION	COUNTY	TOTAL SHEETS	SHEET NO.
	PLOT SCALE	DRAWN	PP	REVISED						57	99-IHB-RI	WILL	679	199
	PLOT DATE	CHECKED	JPM	REVISED						CONTRACT NO. 60L69				
		DATE	05/10/2013	REVISED						ILLINOIS FED. AID PROJECT				
SCALE: 1" = 50' SHEET 15 OF 29 SHEETS STA. 1402+00 TO STA. 1426+00														

P:\60261211-I-57-Stuenkel\Road\NC_3\Interchange\NC_3-Stuenkel\DRP\15.dgn