

- ① BEGIN REVERSE CURVE OR WEAVE/ LANE WIDENING
- ② END REVERSE CURVE OR WEAVE/ LANE WIDENING
- ③ BEGIN REVERSE CURVE OR WEAVE/ LANE NARROWING
- ④ END REVERSE CURVE OR WEAVE/ LANE NARROWING
- ⑤ BEGIN GLARE SCREENS ON BARRIER
- ⑥ END GLARE SCREENS ON BARRIER

LEGEND:

- TRAFFIC MOVEMENT
- TEMPORARY CONCRETE BARRIER
- TYPE III BARRICADE WITH FLASHING LIGHTS
- PAVEMENT MARKING TAPE, TYPE III (SEE PLANS FOR LINE COLOR)
- DRUM WITH STEADY BURN MONODIRECTIONAL LIGHT
- VERTICAL PANEL (POST MOUNTED)
- IMPACT ATTENUATORS, TEMPORARY (NON-REDIRECTIVE), TEST LEVEL 3
- WORK ZONE AREA
- TEMPORARY PAVEMENT

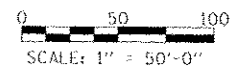
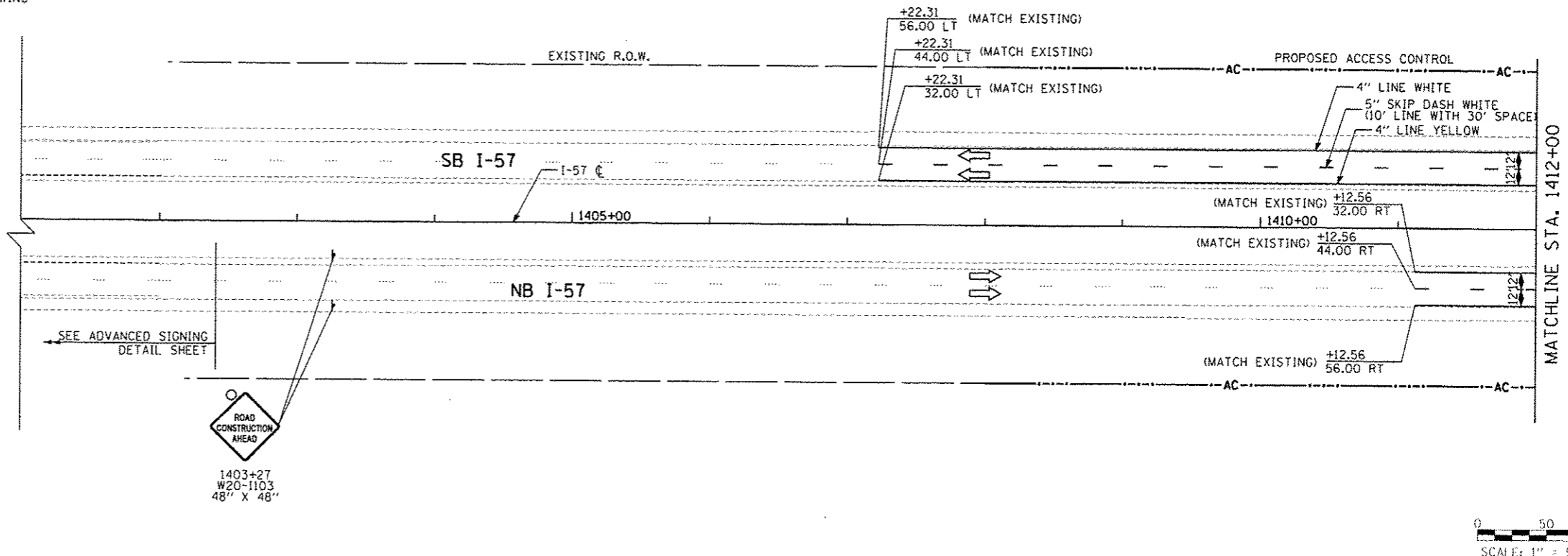

- HIGH TENSION CABLE MEDIAN BARRIER
- HIGH TENSION CABLE MEDIAN TERMINAL

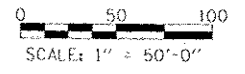
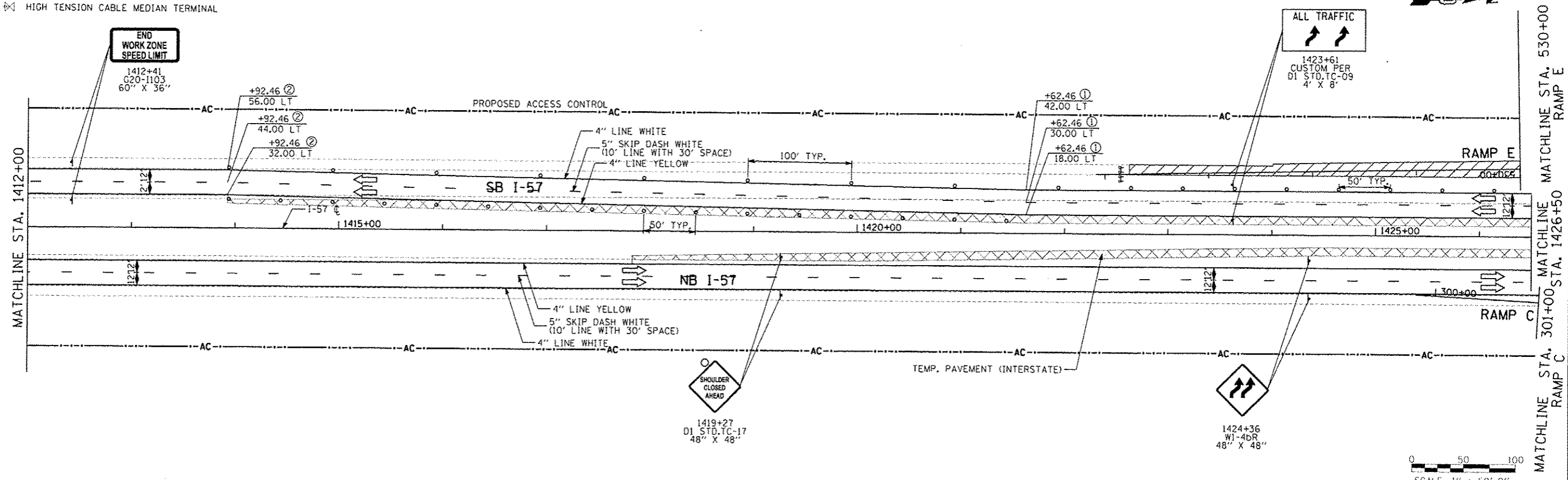

TYLIN INTERNATIONAL

USER NAME	DESIGNED	JTP	REVISED	10/18/2013
PLD1 SCALE	DRAWN	JTP	REVISED	
PLD1 DATE	CHECKED	JPM	REVISED	
	DATE	05/10/2013	REVISED	

**STATE OF ILLINOIS
DEPARTMENT OF TRANSPORTATION**

**STUENKEL ROAD AT I-57 RIDGELAND AVENUE TO CENTRAL AVENUE
MAINTENANCE OF TRAFFIC PLAN - I-57 STAGE 1**

F.A. RTE.	SECTION	COUNTY	TOTAL SHEETS	SHEET NO.
57	99-1HB-RI	WILL	679	133
CONTRACT NO. 60L69				

SCALE: 1" = 50' SHEET 1 OF 6 SHEETS STA. 1402+00 TO STA. 1426+50

P:\602612(I-57 @ Stuenkel)\Road\NC 3\Interchange\N.3.Stuenkel.M01.5/1-1.dwg

3/25/2013 3:09:12 PM